

**Agenda Item**

**No.**

F-3

DATE SUBMITTED 01/12/2021  
 SUBMITTED BY COMMUNITY DEVELOPMENT DIRECTOR  
 DATE ACTION REQUIRED 01/20/2021

COUNCIL ACTION (X)  
 PUBLIC HEARING ( )  
 REQUIRED  
 RESOLUTION ( )  
 ORDINANCE 1<sup>ST</sup> READING ( )  
 ORDINANCE 2<sup>ND</sup> READING ( )  
 CITY CLERK'S INITIALS 28

**IMPERIAL CITY COUNCIL  
 AGENDA ITEM**

SUBJECT: DISCUSSION/ACTION:  
 CLASS I AND CLASS II BIKE FACILITY ALONG THE NORTH SIDE OF ATEN BLVD FROM DOGWOOD ROAD TO PUERTO VALLARTA AVENUE (BID NO. 2020-08)  
 1. AWARD CONSTRUCTION CONTRACT TO **ROVE ENGINEERING, INC.**  
 2. AUTHORIZE 15% CONTINGENCY.

DEPARTMENT INVOLVED: COMMUNITY DEVELOPMENT DEPARTMENT

**BACKGROUND/SUMMARY:**

The Community Development Department was directed by City Council to conduct a competitive BID process for the demolition of existing AC Pavement, installation of new Free-Standing Curb, AC Pavement, Class II Base, Striping and Signage, Street Lights, Landscaping and Irrigation Lines. See attached Exhibit 1.

Staff released a BID published in the Calexico Chronicle, Holtville Tribune, our City website, "Dodge Data & Analytics" & "Construct Connect" planrooms to solicit proposals from qualified and experienced contractors to complete the construction.



The following six (6) bids were received during the formal bidding process:

1. LC Paving & Sealing, Inc. \_\_\_\_\_ \$594,984.83
2. **Rove Engineering, Inc.** \_\_\_\_\_ **\$584,596.50**
3. Pyramid Construction and Aggregates, Inc. \_\_\_\_\_ \$656,647.61
4. Hazard Construction Company \_\_\_\_\_ \$627,615.00
5. C.S. Legacy Construction, Inc. \_\_\_\_\_ \$799,192.00
6. Granite Construction Company \_\_\_\_\_ \$768,867.00

See attached Exhibit 2 ("BID Opening Act") for details.

After careful review of all bids submitted, staff recommends the project be awarded to Rove Engineering, Inc, the lowest responsive and responsible bidder.

Due to potential unknown conditions, it is also recommended to add a 15% Contingency to this contract.

<p>FISCAL IMPACT:                  \$432,026.00 from CMAQ Funds and \$152,570.50 from LTA Measure D                  Total = \$584,596.50</p>	<p>ADMIN SERVICES SIGN INITIALS <u></u></p>
<p>STAFF RECOMMENDATION: Staff recommends City Council</p> <ol style="list-style-type: none"> <li>1. award a construction contract to Rove Engineering, Inc. in the amount of \$584,596.50.</li> <li>2. Authorize 15% Contingency.</li> </ol>	<p>DEPT. INITIALS <u>DM</u></p>
<p>MANAGER'S RECOMMENDATION:  <u>approve</u></p>	<p>CITY MANAGER'S INITIALS <u></u></p>

MOTION:  
 SECONDED: APPROVED ( ) REJECTED ( )  
 AYES: DISAPPROVED ( ) DEFERRED ( )  
 NAYES:  
 ABSENT: REFERRED TO:

# Exhibit 1

## CITY OF IMPERIAL - "CLASS I AND CLASS II BIKE FACILITY ALONG THE NORTH SIDE OF ATEN BOULEVARD FROM DOGWOOD ROAD TO PUERTO VALLARTA AVENUE" IN THE CITY OF IMPERIAL, CALIFORNIA

JUNE 2020



### PROJECT AREA

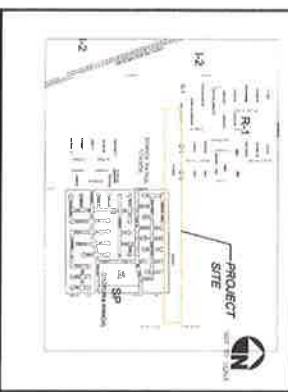

**DECLARATION OF RESPONSIBLE CHARGE**

I, the undersigned, being the holder or owner (or the holder or owner's duly authorized agent) of the project described herein, do hereby certify that the person or persons named herein as the responsible charge are duly qualified to perform the duties and obligations of such position and that the design is compliant with all applicable laws, codes, and regulations.

CHARGE: DESIGN, PREPARE CONTRACT DOCUMENTS, AND OBTAIN PERMITS FOR THE PROJECT DESCRIBED HEREIN.

DATE: 06/11/2020

CHARGE: AND TRAVEL PLAN

**PROJECT INFORMATION**

**OWNER**  
CITY OF IMPERIAL  
420 S. IMPERIAL AVE  
IMPERIAL, CA 92251  
PHONE: (760) 365-4711  
FAX: (760) 365-4718

**ENGINEER**  
DYNAMIC CONSULTING ENGINEERS, INC.  
100 S. 2ND STREET  
IMPERIAL, CA 92251  
PHONE: (760) 365-4718  
FAX: (760) 365-4718

**AGENCY CONTACTS**

**CITY OF IMPERIAL**  
OTIWAH KIM, AIA, CIO  
PLANNING DEPARTMENT  
420 S. IMPERIAL AVE  
IMPERIAL, CA 92251  
PHONE: (760) 365-4711

**ESRS VILLAGES**  
JESSICA WILSON, AIA  
PLANNING DEPARTMENT  
420 S. IMPERIAL AVE  
IMPERIAL, CA 92251  
PHONE: (760) 365-4711

**AMARCO AQUILATA**  
AMARCO AQUILATA  
PLANNING DEPARTMENT  
420 S. IMPERIAL AVE  
IMPERIAL, CA 92251  
PHONE: (760) 365-4711

**100 S. 2ND STREET**  
JAMES TUCKER  
PLANNING DEPARTMENT  
420 S. IMPERIAL AVE  
IMPERIAL, CA 92251  
PHONE: (760) 365-4711

**310 S. BARNHILL AVE**  
WILLIAM BISHOP, AIA  
PLANNING DEPARTMENT  
310 S. BARNHILL AVE  
IMPERIAL, CA 92251  
PHONE: (760) 365-4711

**SHEET INDEX**

1. TITLE SHEET VICINITY MAP AND GENERAL NOTES
2. GENERAL NOTES
3. PRELIMINARY PLANS STA 1+00 TO STA 1+400
4. PRELIMINARY PLANS STA 1+400 TO STA 2+000
5. PRELIMINARY PLANS STA 2+000 TO STA 2+400
6. PRELIMINARY PLANS STA 2+400 TO STA 2+800
7. PRELIMINARY PLANS STA 2+800 TO STA 3+200
8. PRELIMINARY PLANS STA 3+200 TO STA 3+600
9. PRELIMINARY PLANS STA 3+600 TO STA 4+000
10. PRELIMINARY PLANS STA 4+000 TO STA 4+400
11. PRELIMINARY PLANS STA 4+400 TO STA 4+800
12. PRELIMINARY PLANS STA 4+800 TO STA 5+200
13. PRELIMINARY PLANS STA 5+200 TO STA 5+600
14. PRELIMINARY PLANS STA 5+600 TO STA 6+000
15. PRELIMINARY PLANS STA 6+000 TO STA 6+400
16. PRELIMINARY PLANS STA 6+400 TO STA 6+800
17. PRELIMINARY PLANS STA 6+800 TO STA 7+200
18. PRELIMINARY PLANS STA 7+200 TO STA 7+600
19. PRELIMINARY PLANS STA 7+600 TO STA 8+000
20. PRELIMINARY PLANS STA 8+000 TO STA 8+400
21. PRELIMINARY PLANS STA 8+400 TO STA 8+800
22. PRELIMINARY PLANS STA 8+800 TO STA 9+200
23. PRELIMINARY PLANS STA 9+200 TO STA 9+600
24. PRELIMINARY PLANS STA 9+600 TO STA 10+000
25. PRELIMINARY PLANS STA 10+000 TO STA 10+400
26. PRELIMINARY PLANS STA 10+400 TO STA 10+800
27. PRELIMINARY PLANS STA 10+800 TO STA 11+200
28. PRELIMINARY PLANS STA 11+200 TO STA 11+600
29. PRELIMINARY PLANS STA 11+600 TO STA 12+000
30. PRELIMINARY PLANS STA 12+000 TO STA 12+400
31. PRELIMINARY PLANS STA 12+400 TO STA 12+800
32. PRELIMINARY PLANS STA 12+800 TO STA 13+200
33. PRELIMINARY PLANS STA 13+200 TO STA 13+600
34. PRELIMINARY PLANS STA 13+600 TO STA 14+000
35. PRELIMINARY PLANS STA 14+000 TO STA 14+400
36. PRELIMINARY PLANS STA 14+400 TO STA 14+800
37. PRELIMINARY PLANS STA 14+800 TO STA 15+200
38. PRELIMINARY PLANS STA 15+200 TO STA 15+600
39. PRELIMINARY PLANS STA 15+600 TO STA 16+000
40. PRELIMINARY PLANS STA 16+000 TO STA 16+400
41. PRELIMINARY PLANS STA 16+400 TO STA 16+800
42. PRELIMINARY PLANS STA 16+800 TO STA 17+200
43. PRELIMINARY PLANS STA 17+200 TO STA 17+600
44. PRELIMINARY PLANS STA 17+600 TO STA 18+000
45. PRELIMINARY PLANS STA 18+000 TO STA 18+400
46. PRELIMINARY PLANS STA 18+400 TO STA 18+800
47. PRELIMINARY PLANS STA 18+800 TO STA 19+200
48. PRELIMINARY PLANS STA 19+200 TO STA 19+600
49. PRELIMINARY PLANS STA 19+600 TO STA 20+000
50. PRELIMINARY PLANS STA 20+000 TO STA 20+400
51. PRELIMINARY PLANS STA 20+400 TO STA 20+800
52. PRELIMINARY PLANS STA 20+800 TO STA 21+200
53. PRELIMINARY PLANS STA 21+200 TO STA 21+600
54. PRELIMINARY PLANS STA 21+600 TO STA 22+000
55. PRELIMINARY PLANS STA 22+000 TO STA 22+400
56. PRELIMINARY PLANS STA 22+400 TO STA 22+800
57. PRELIMINARY PLANS STA 22+800 TO STA 23+200
58. PRELIMINARY PLANS STA 23+200 TO STA 23+600
59. PRELIMINARY PLANS STA 23+600 TO STA 24+000
60. PRELIMINARY PLANS STA 24+000 TO STA 24+400
61. PRELIMINARY PLANS STA 24+400 TO STA 24+800
62. PRELIMINARY PLANS STA 24+800 TO STA 25+200
63. PRELIMINARY PLANS STA 25+200 TO STA 25+600
64. PRELIMINARY PLANS STA 25+600 TO STA 26+000
65. PRELIMINARY PLANS STA 26+000 TO STA 26+400
66. PRELIMINARY PLANS STA 26+400 TO STA 26+800
67. PRELIMINARY PLANS STA 26+800 TO STA 27+200
68. PRELIMINARY PLANS STA 27+200 TO STA 27+600
69. PRELIMINARY PLANS STA 27+600 TO STA 28+000
70. PRELIMINARY PLANS STA 28+000 TO STA 28+400
71. PRELIMINARY PLANS STA 28+400 TO STA 28+800
72. PRELIMINARY PLANS STA 28+800 TO STA 29+200
73. PRELIMINARY PLANS STA 29+200 TO STA 29+600
74. PRELIMINARY PLANS STA 29+600 TO STA 30+000
75. PRELIMINARY PLANS STA 30+000 TO STA 30+400
76. PRELIMINARY PLANS STA 30+400 TO STA 30+800
77. PRELIMINARY PLANS STA 30+800 TO STA 31+200
78. PRELIMINARY PLANS STA 31+200 TO STA 31+600
79. PRELIMINARY PLANS STA 31+600 TO STA 32+000
80. PRELIMINARY PLANS STA 32+000 TO STA 32+400
81. PRELIMINARY PLANS STA 32+400 TO STA 32+800
82. PRELIMINARY PLANS STA 32+800 TO STA 33+200
83. PRELIMINARY PLANS STA 33+200 TO STA 33+600
84. PRELIMINARY PLANS STA 33+600 TO STA 34+000
85. PRELIMINARY PLANS STA 34+000 TO STA 34+400
86. PRELIMINARY PLANS STA 34+400 TO STA 34+800
87. PRELIMINARY PLANS STA 34+800 TO STA 35+200
88. PRELIMINARY PLANS STA 35+200 TO STA 35+600
89. PRELIMINARY PLANS STA 35+600 TO STA 36+000
90. PRELIMINARY PLANS STA 36+000 TO STA 36+400
91. PRELIMINARY PLANS STA 36+400 TO STA 36+800
92. PRELIMINARY PLANS STA 36+800 TO STA 37+200
93. PRELIMINARY PLANS STA 37+200 TO STA 37+600
94. PRELIMINARY PLANS STA 37+600 TO STA 38+000
95. PRELIMINARY PLANS STA 38+000 TO STA 38+400
96. PRELIMINARY PLANS STA 38+400 TO STA 38+800
97. PRELIMINARY PLANS STA 38+800 TO STA 39+200
98. PRELIMINARY PLANS STA 39+200 TO STA 39+600
99. PRELIMINARY PLANS STA 39+600 TO STA 40+000
100. PRELIMINARY PLANS STA 40+000 TO STA 40+400
101. PRELIMINARY PLANS STA 40+400 TO STA 40+800
102. PRELIMINARY PLANS STA 40+800 TO STA 41+200
103. PRELIMINARY PLANS STA 41+200 TO STA 41+600
104. PRELIMINARY PLANS STA 41+600 TO STA 42+000
105. PRELIMINARY PLANS STA 42+000 TO STA 42+400
106. PRELIMINARY PLANS STA 42+400 TO STA 42+800
107. PRELIMINARY PLANS STA 42+800 TO STA 43+200
108. PRELIMINARY PLANS STA 43+200 TO STA 43+600
109. PRELIMINARY PLANS STA 43+600 TO STA 44+000
110. PRELIMINARY PLANS STA 44+000 TO STA 44+400
111. PRELIMINARY PLANS STA 44+400 TO STA 44+800
112. PRELIMINARY PLANS STA 44+800 TO STA 45+200
113. PRELIMINARY PLANS STA 45+200 TO STA 45+600
114. PRELIMINARY PLANS STA 45+600 TO STA 46+000
115. PRELIMINARY PLANS STA 46+000 TO STA 46+400
116. PRELIMINARY PLANS STA 46+400 TO STA 46+800
117. PRELIMINARY PLANS STA 46+800 TO STA 47+200
118. PRELIMINARY PLANS STA 47+200 TO STA 47+600
119. PRELIMINARY PLANS STA 47+600 TO STA 48+000
120. PRELIMINARY PLANS STA 48+000 TO STA 48+400
121. PRELIMINARY PLANS STA 48+400 TO STA 48+800
122. PRELIMINARY PLANS STA 48+800 TO STA 49+200
123. PRELIMINARY PLANS STA 49+200 TO STA 49+600
124. PRELIMINARY PLANS STA 49+600 TO STA 50+000
125. PRELIMINARY PLANS STA 50+000 TO STA 50+400
126. PRELIMINARY PLANS STA 50+400 TO STA 50+800
127. PRELIMINARY PLANS STA 50+800 TO STA 51+200
128. PRELIMINARY PLANS STA 51+200 TO STA 51+600
129. PRELIMINARY PLANS STA 51+600 TO STA 52+000
130. PRELIMINARY PLANS STA 52+000 TO STA 52+400
131. PRELIMINARY PLANS STA 52+400 TO STA 52+800
132. PRELIMINARY PLANS STA 52+800 TO STA 53+200
133. PRELIMINARY PLANS STA 53+200 TO STA 53+600
134. PRELIMINARY PLANS STA 53+600 TO STA 54+000
135. PRELIMINARY PLANS STA 54+000 TO STA 54+400
136. PRELIMINARY PLANS STA 54+400 TO STA 54+800
137. PRELIMINARY PLANS STA 54+800 TO STA 55+200
138. PRELIMINARY PLANS STA 55+200 TO STA 55+600
139. PRELIMINARY PLANS STA 55+600 TO STA 56+000
140. PRELIMINARY PLANS STA 56+000 TO STA 56+400
141. PRELIMINARY PLANS STA 56+400 TO STA 56+800
142. PRELIMINARY PLANS STA 56+800 TO STA 57+200
143. PRELIMINARY PLANS STA 57+200 TO STA 57+600
144. PRELIMINARY PLANS STA 57+600 TO STA 58+000
145. PRELIMINARY PLANS STA 58+000 TO STA 58+400
146. PRELIMINARY PLANS STA 58+400 TO STA 58+800
147. PRELIMINARY PLANS STA 58+800 TO STA 59+200
148. PRELIMINARY PLANS STA 59+200 TO STA 59+600
149. PRELIMINARY PLANS STA 59+600 TO STA 60+000
150. PRELIMINARY PLANS STA 60+000 TO STA 60+400
151. PRELIMINARY PLANS STA 60+400 TO STA 60+800
152. PRELIMINARY PLANS STA 60+800 TO STA 61+200
153. PRELIMINARY PLANS STA 61+200 TO STA 61+600
154. PRELIMINARY PLANS STA 61+600 TO STA 62+000
155. PRELIMINARY PLANS STA 62+000 TO STA 62+400
156. PRELIMINARY PLANS STA 62+400 TO STA 62+800
157. PRELIMINARY PLANS STA 62+800 TO STA 63+200
158. PRELIMINARY PLANS STA 63+200 TO STA 63+600
159. PRELIMINARY PLANS STA 63+600 TO STA 64+000
160. PRELIMINARY PLANS STA 64+000 TO STA 64+400
161. PRELIMINARY PLANS STA 64+400 TO STA 64+800
162. PRELIMINARY PLANS STA 64+800 TO STA 65+200
163. PRELIMINARY PLANS STA 65+200 TO STA 65+600
164. PRELIMINARY PLANS STA 65+600 TO STA 66+000
165. PRELIMINARY PLANS STA 66+000 TO STA 66+400
166. PRELIMINARY PLANS STA 66+400 TO STA 66+800
167. PRELIMINARY PLANS STA 66+800 TO STA 67+200
168. PRELIMINARY PLANS STA 67+200 TO STA 67+600
169. PRELIMINARY PLANS STA 67+600 TO STA 68+000
170. PRELIMINARY PLANS STA 68+000 TO STA 68+400
171. PRELIMINARY PLANS STA 68+400 TO STA 68+800
172. PRELIMINARY PLANS STA 68+800 TO STA 69+200
173. PRELIMINARY PLANS STA 69+200 TO STA 69+600
174. PRELIMINARY PLANS STA 69+600 TO STA 70+000
175. PRELIMINARY PLANS STA 70+000 TO STA 70+400
176. PRELIMINARY PLANS STA 70+400 TO STA 70+800
177. PRELIMINARY PLANS STA 70+800 TO STA 71+200
178. PRELIMINARY PLANS STA 71+200 TO STA 71+600
179. PRELIMINARY PLANS STA 71+600 TO STA 72+000
180. PRELIMINARY PLANS STA 72+000 TO STA 72+400
181. PRELIMINARY PLANS STA 72+400 TO STA 72+800
182. PRELIMINARY PLANS STA 72+800 TO STA 73+200
183. PRELIMINARY PLANS STA 73+200 TO STA 73+600
184. PRELIMINARY PLANS STA 73+600 TO STA 74+000
185. PRELIMINARY PLANS STA 74+000 TO STA 74+400
186. PRELIMINARY PLANS STA 74+400 TO STA 74+800
187. PRELIMINARY PLANS STA 74+800 TO STA 75+200
188. PRELIMINARY PLANS STA 75+200 TO STA 75+600
189. PRELIMINARY PLANS STA 75+600 TO STA 76+000
190. PRELIMINARY PLANS STA 76+000 TO STA 76+400
191. PRELIMINARY PLANS STA 76+400 TO STA 76+800
192. PRELIMINARY PLANS STA 76+800 TO STA 77+200
193. PRELIMINARY PLANS STA 77+200 TO STA 77+600
194. PRELIMINARY PLANS STA 77+600 TO STA 78+000
195. PRELIMINARY PLANS STA 78+000 TO STA 78+400
196. PRELIMINARY PLANS STA 78+400 TO STA 78+800
197. PRELIMINARY PLANS STA 78+800 TO STA 79+200
198. PRELIMINARY PLANS STA 79+200 TO STA 79+600
199. PRELIMINARY PLANS STA 79+600 TO STA 80+000
200. PRELIMINARY PLANS STA 80+000 TO STA 80+400
201. PRELIMINARY PLANS STA 80+400 TO STA 80+800
202. PRELIMINARY PLANS STA 80+800 TO STA 81+200
203. PRELIMINARY PLANS STA 81+200 TO STA 81+600
204. PRELIMINARY PLANS STA 81+600 TO STA 82+000
205. PRELIMINARY PLANS STA 82+000 TO STA 82+400
206. PRELIMINARY PLANS STA 82+400 TO STA 82+800
207. PRELIMINARY PLANS STA 82+800 TO STA 83+200
208. PRELIMINARY PLANS STA 83+200 TO STA 83+600
209. PRELIMINARY PLANS STA 83+600 TO STA 84+000
210. PRELIMINARY PLANS STA 84+000 TO STA 84+400
211. PRELIMINARY PLANS STA 84+400 TO STA 84+800
212. PRELIMINARY PLANS STA 84+800 TO STA 85+200
213. PRELIMINARY PLANS STA 85+200 TO STA 85+600
214. PRELIMINARY PLANS STA 85+600 TO STA 86+000
215. PRELIMINARY PLANS STA 86+000 TO STA 86+400
216. PRELIMINARY PLANS STA 86+400 TO STA 86+800
217. PRELIMINARY PLANS STA 86+800 TO STA 87+200
218. PRELIMINARY PLANS STA 87+200 TO STA 87+600
219. PRELIMINARY PLANS STA 87+600 TO STA 88+000
220. PRELIMINARY PLANS STA 88+000 TO STA 88+400
221. PRELIMINARY PLANS STA 88+400 TO STA 88+800
222. PRELIMINARY PLANS STA 88+800 TO STA 89+200
223. PRELIMINARY PLANS STA 89+200 TO STA 89+600
224. PRELIMINARY PLANS STA 89+600 TO STA 90+000
225. PRELIMINARY PLANS STA 90+000 TO STA 90+400
226. PRELIMINARY PLANS STA 90+400 TO STA 90+800
227. PRELIMINARY PLANS STA 90+800 TO STA 91+200
228. PRELIMINARY PLANS STA 91+200 TO STA 91+600
229. PRELIMINARY PLANS STA 91+600 TO STA 92+000
230. PRELIMINARY PLANS STA 92+000 TO STA 92+400
231. PRELIMINARY PLANS STA 92+400 TO STA 92+800
232. PRELIMINARY PLANS STA 92+800 TO STA 93+200
233. PRELIMINARY PLANS STA 93+200 TO STA 93+600
234. PRELIMINARY PLANS STA 93+600 TO STA 94+000
235. PRELIMINARY PLANS STA 94+000 TO STA 94+400
236. PRELIMINARY PLANS STA 94+400 TO STA 94+800
237. PRELIMINARY PLANS STA 94+800 TO STA 95+200
238. PRELIMINARY PLANS STA 95+200 TO STA 95+600
239. PRELIMINARY PLANS STA 95+600 TO STA 96+000
240. PRELIMINARY PLANS STA 96+000 TO STA 96+400
241. PRELIMINARY PLANS STA 96+400 TO STA 96+800
242. PRELIMINARY PLANS STA 96+800 TO STA 97+200
243. PRELIMINARY PLANS STA 97+200 TO STA 97+600
244. PRELIMINARY PLANS STA 97+600 TO STA 98+000
245. PRELIMINARY PLANS STA 98+000 TO STA 98+400
246. PRELIMINARY PLANS STA 98+400 TO STA 98+800
247. PRELIMINARY PLANS STA 98+800 TO STA 99+200
248. PRELIMINARY PLANS STA 99+200 TO STA 99+600
249. PRELIMINARY PLANS STA 99+600 TO STA 100+000

**NOTE TO CONTRACTOR**

THE CONTRACTOR SHALL BE RESPONSIBLE FOR OBTAINING ALL NECESSARY PERMITS AND APPROVALS FROM THE CITY OF IMPERIAL AND THE CALIFORNIA DEPARTMENT OF TRANSPORTATION AND PUBLIC UTILITIES (CALTRANS). THE CONTRACTOR SHALL ALSO BE RESPONSIBLE FOR OBTAINING ALL NECESSARY PERMITS AND APPROVALS FROM THE CALIFORNIA DEPARTMENT OF INDUSTRIAL RELATIONS (DIR) AND THE CALIFORNIA DEPARTMENT OF INDUSTRIAL ACCIDENT PREVENTION (DIPAP). THE CONTRACTOR SHALL ALSO BE RESPONSIBLE FOR OBTAINING ALL NECESSARY PERMITS AND APPROVALS FROM THE CALIFORNIA DEPARTMENT OF INDUSTRIAL ACCIDENT PREVENTION (DIPAP).

**ENGINEERS' NOTE TO CONTRACTOR**

THE ENGINEERS' NOTE TO CONTRACTOR IS A SUPPLEMENT TO THE CONTRACT DOCUMENTS AND SHALL BE READ IN CONJUNCTION WITH THE CONTRACT DOCUMENTS. THE ENGINEERS' NOTE TO CONTRACTOR IS A SUPPLEMENT TO THE CONTRACT DOCUMENTS AND SHALL BE READ IN CONJUNCTION WITH THE CONTRACT DOCUMENTS.

**CITY COUNCIL**

**DARRELL BECHTL**  
KARIN EUGENIO  
GEOFF DALE  
ROBERT AMPARANO  
JAMES TUCKER

**DEBRA WORTA**  
DEBRA JACOBSON  
OTIWAH KIM  
BRUCE COX  
JESSICA WILSON  
AMARCO AQUILATA

**PARTICIPATING CITY STAFF**

**AMARCO AQUILATA**  
PLANNING DEPARTMENT  
420 S. IMPERIAL AVE  
IMPERIAL, CA 92251  
PHONE: (760) 365-4711  
FAX: (760) 365-4718

**DECLARATION OF RESPONSIBLE CHARGE**

I, the undersigned, being the holder or owner (or the holder or owner's duly authorized agent) of the project described herein, do hereby certify that the person or persons named herein as the responsible charge are duly qualified to perform the duties and obligations of such position and that the design is compliant with all applicable laws, codes, and regulations.

CHARGE: DESIGN, PREPARE CONTRACT DOCUMENTS, AND OBTAIN PERMITS FOR THE PROJECT DESCRIBED HEREIN.

DATE: 06/11/2020

CHARGE: AND TRAVEL PLAN

**AGENCY CONTACTS**

**CITY OF IMPERIAL**  
OTIWAH KIM, AIA, CIO  
PLANNING DEPARTMENT  
420 S. IMPERIAL AVE  
IMPERIAL, CA 92251  
PHONE: (760) 365-4711

**ESRS VILLAGES**  
JESSICA WILSON, AIA  
PLANNING DEPARTMENT  
420 S. IMPERIAL AVE  
IMPERIAL, CA 92251  
PHONE: (760) 365-4711

**AMARCO AQUILATA**  
AMARCO AQUILATA  
PLANNING DEPARTMENT  
420 S. IMPERIAL AVE  
IMPERIAL, CA 92251  
PHONE: (760) 365-4711

**100 S. 2ND STREET**  
JAMES TUCKER  
PLANNING DEPARTMENT  
420 S. IMPERIAL AVE  
IMPERIAL, CA 92251  
PHONE: (760) 365-4711

**310 S. BARNHILL AVE**  
WILLIAM BISHOP, AIA  
PLANNING DEPARTMENT  
310 S. BARNHILL AVE  
IMPERIAL, CA 92251  
PHONE: (760) 365-4711

**SHEET INDEX**

1. TITLE SHEET VICINITY MAP AND GENERAL NOTES
2. GENERAL NOTES
3. PRELIMINARY PLANS STA 1+00 TO STA 1+400
4. PRELIMINARY PLANS STA 1+400 TO STA 2+000
5. PRELIMINARY PLANS STA 2+000 TO STA 2+400
6. PRELIMINARY PLANS STA 2+400 TO STA 2+800
7. PRELIMINARY PLANS STA 2+800 TO STA 3+200
8. PRELIMINARY PLANS STA 3+200 TO STA 3+600
9. PRELIMINARY PLANS STA 3+600 TO STA 4+000
10. PRELIMINARY PLANS STA 4+000 TO STA 4+400
11. PRELIMINARY PLANS STA 4+400 TO STA 4+800
12. PRELIMINARY PLANS STA 4+800 TO STA 5+200
13. PRELIMINARY PLANS STA 5+200 TO STA 5+600
14. PRELIMINARY PLANS STA 5+600 TO STA 6+000
15. PRELIMINARY PLANS STA 6+000 TO STA 6+400
16. PRELIMINARY PLANS STA 6+400 TO STA 6+800
17. PRELIMINARY PLANS STA 6+800 TO STA 7+200
18. PRELIMINARY PLANS STA 7+200 TO STA 7+600
19. PRELIMINARY PLANS STA 7+600 TO STA 8+000
20. PRELIMINARY PLANS STA 8+000 TO STA 8+400
21. PRELIMINARY PLANS STA 8+400 TO STA 8+800
22. PRELIMINARY PLANS STA 8+800 TO STA 9+200
23. PRELIMINARY PLANS STA 9+200 TO STA 9+600
24. PRELIMINARY PLANS STA 9+600 TO STA 10+000
25. PRELIMINARY PLANS STA 10+000 TO STA 10+400
26. PRELIMINARY PLANS STA 10+400 TO STA 10+800
27. PRELIMINARY PLANS STA 10+800 TO STA 11+200
28. PRELIMINARY PLANS STA 11+200 TO STA 11+600
29. PRELIMINARY PLANS STA 11+600 TO STA 12+000
30. PRELIMINARY PLANS STA 12+000 TO STA 12+400
31. PRELIMINARY PLANS STA 12+400 TO STA 12+800
32. PRELIMINARY PLANS STA 12+800 TO STA 13+200
33. PRELIMINARY PLANS STA 13+200 TO STA 13+600
34. PRELIMINARY PLANS STA 13+600 TO STA 14+000
35. PRELIMINARY PLANS STA 14+000 TO STA 14+400
36. PRELIMINARY PLANS STA 14+400 TO STA 14+800
37. PRELIMINARY PLANS STA 14+800 TO STA 15+200
38. PRELIMINARY PLANS STA 15+200 TO STA 15+600
39. PRELIMINARY PLANS STA 15+600 TO STA 16+000
40. PRELIMINARY PLANS STA 16+000 TO STA 16+400
41. PRELIMINARY PLANS STA 16+400 TO STA 16+800
42. PRELIMINARY PLANS STA 16+800 TO STA 17+200
43. PRELIMINARY PLANS STA 17+200 TO STA 17+600
44. PRELIMINARY PLANS STA 17+600 TO STA 18+000
45. PRELIMINARY PLANS STA 18+000 TO STA 18+400
46. PRELIMINARY PLANS STA 18+400 TO STA 18+800
47. PRELIMINARY PLANS STA 18+800 TO STA 19+200
48. PRELIMINARY PLANS STA 19+200 TO STA 19+600
49. PRELIMINARY PLANS STA 19+600 TO STA 20+000
50. PRELIMINARY PLANS STA 20+000 TO STA 20+400
51. PRELIMINARY PLANS STA 20+400 TO STA 20+800
52. PRELIMINARY PLANS STA 20+800 TO STA 21+200
53. PRELIMINARY PLANS STA 21+200 TO STA 21+600
54. PRELIMINARY PLANS STA 21+600 TO STA 22+000
55. PRELIMINARY PLANS STA 22+000 TO STA 22+400
56. PRELIMINARY PLANS STA 22+400 TO STA 22+800
57. PRELIMINARY PLANS STA 22+800 TO STA 23+200
58. PRELIMINARY PLANS STA 23+200 TO STA 23+600
59. PRELIMINARY PLANS STA 23+600 TO STA 24+000
60. PRELIMINARY PLANS STA 24+000 TO STA 24+400
61. PRELIMINARY PLANS STA 24+400 TO STA 24+800
62. PRELIMINARY PLANS STA 24+800 TO STA 25+200
63. PRELIMINARY







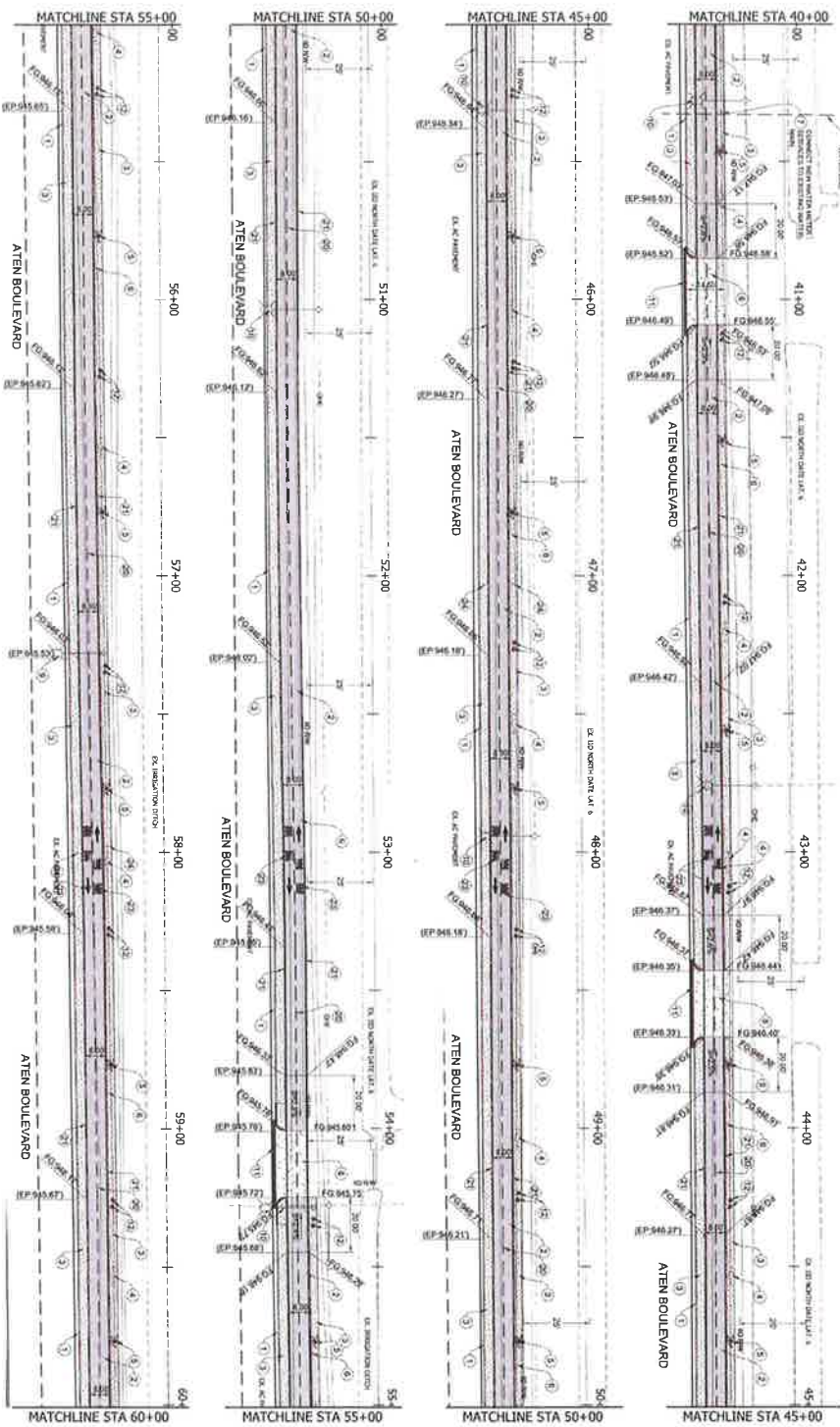

- CONSTRUCTION NOTES**
- 1) ALL UTILITIES SHOWN ARE TO BE MAINTAINED AND PROTECTED DURING CONSTRUCTION.
  - 2) ALL UTILITIES SHOWN ARE TO BE MAINTAINED AND PROTECTED DURING CONSTRUCTION.
  - 3) ALL UTILITIES SHOWN ARE TO BE MAINTAINED AND PROTECTED DURING CONSTRUCTION.
  - 4) ALL UTILITIES SHOWN ARE TO BE MAINTAINED AND PROTECTED DURING CONSTRUCTION.
  - 5) ALL UTILITIES SHOWN ARE TO BE MAINTAINED AND PROTECTED DURING CONSTRUCTION.
  - 6) ALL UTILITIES SHOWN ARE TO BE MAINTAINED AND PROTECTED DURING CONSTRUCTION.
  - 7) ALL UTILITIES SHOWN ARE TO BE MAINTAINED AND PROTECTED DURING CONSTRUCTION.
  - 8) ALL UTILITIES SHOWN ARE TO BE MAINTAINED AND PROTECTED DURING CONSTRUCTION.
  - 9) ALL UTILITIES SHOWN ARE TO BE MAINTAINED AND PROTECTED DURING CONSTRUCTION.
  - 10) ALL UTILITIES SHOWN ARE TO BE MAINTAINED AND PROTECTED DURING CONSTRUCTION.

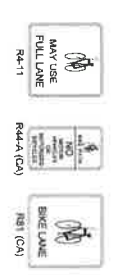

NO.	REVISIONS	DATE

**CITY OF IMPERIAL**  
 420 South Imperial Avenue  
 Imperial, CA 92251  
 Ph: (760) 355-4371 • Fax: (760) 355-4718

**BENCH MARK:**  
 BENCHMARK: 420 SOUTH IMPERIAL AVENUE  
 420 SOUTH IMPERIAL AVENUE  
 IMPERIAL, CA 92251  
 420 SOUTH IMPERIAL AVENUE  
 IMPERIAL, CA 92251



DESIGNED BY: [Signature]  
 CHECKED BY: [Signature]  
 DATE: 08/11/2024

**CITY OF IMPERIAL**  
 "CLASS I AND CLASS II BIRDS FACILITY ALONG THE NORTH SIDE OF ATEN BOULEVARD WITH ATRIA AVENUE"

**Dynamic CONSULTING ENGINEERS**  
 227-2500  
 181 THE COMMONS DRIVE, SUITE 100  
 IMPERIAL, CA 92251  
 TEL: (760) 355-4371 FAX: (760) 355-4718

SHEET 5 OF 7 SHEET  
 DATE: 08/11/2024  
 DCC: 392019



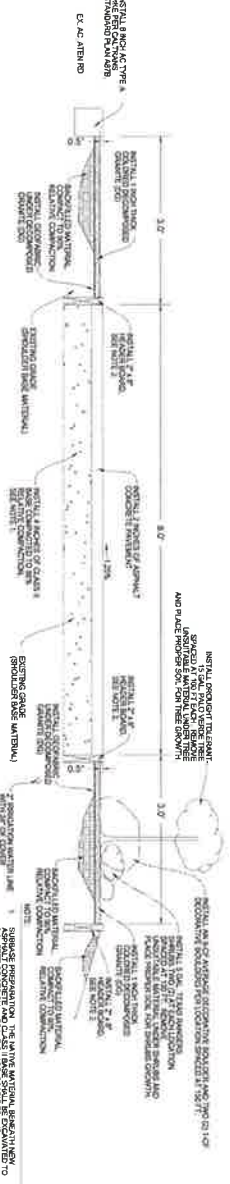

CROSS SECTION - DETAIL 1

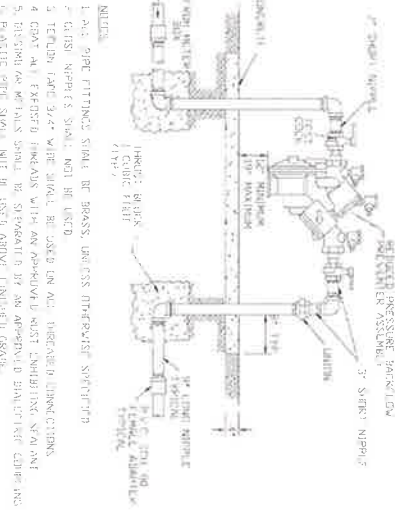

NEW CONSTRUCTION PAVEMENT EXTENSION DETAIL

1. 1/2\"/>

2" BACKFLOW PREVENTER DETAIL 3

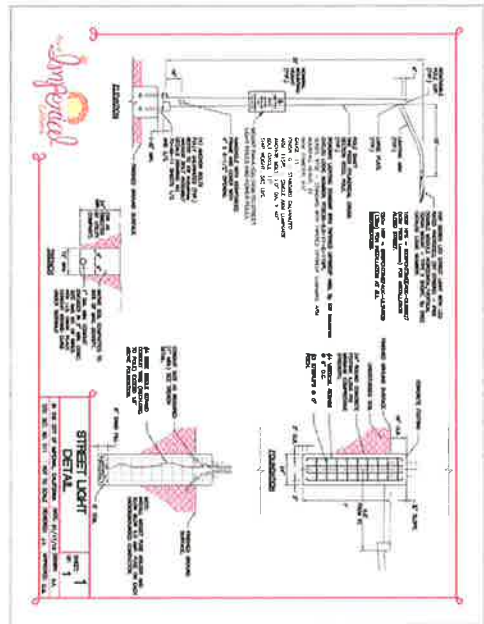

STREET LIGHT DETAIL

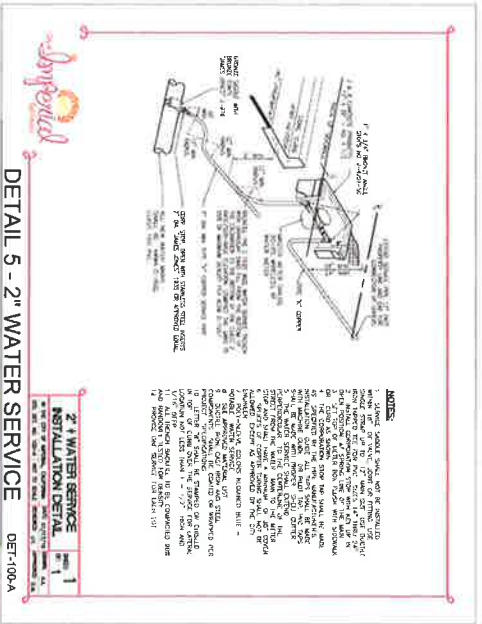

2" WATER SERVICE DETAIL 5

NO.	REVISIONS	DATE
<b>CITY OF IMPERIAL</b> 420 South Imperial Avenue Imperial, CA 92251 Ph: (760) 355-4371 • Fax: (760) 355-4718		
SCHEDULED UNDER THE DIRECT SUPERVISION OF 		
PROJECT TITLE: CLASS I AND CLASS II BIRE FACILITY ALONG THE NORTH SIDE OF AHS ROAD FROM ANSON ROAD TO RESINO VALLEY ROAD		
SHEET GOVT/INT:		
DETAILS		
SHEET 7 OF 7		
DATE: 11/2005		





# Exhibit 2

## BID Opening Act

### BID No. 2020-08

#### CLASS I AND CLASS II BIKE FACILITY ALONG THE NORTH SIDE OF ATEN BOULEVARD FROM DOGWOOD ROAD TO PUERTO VALLARTA AVENUE

Bids received by: DEBRA JACKSON - CITY CLERK

Were opened at 3:07 PM on 11/03/2020

By: DEBRA JACKSON

Witnessed by:

Signature

LC PAVING ARMANDO AGUILAR  
JESUS VILLEGAS

COMPANY	BID AMOUNT	BID BOND
<u>LC PAVING</u>	<u>594,984.23</u>	<u>✓</u>
<u>DOVE ENGINEERING</u>	<u>584,596.50</u>	<u>✓</u>
<u>PYRAMID CONSTRUCTION</u>	<u>656,647.61</u>	<u>✓</u>
<u>HAZARD CONSTRUCTION</u>	<u>627,615.00</u>	<u>✓</u>
<u>US LEGACY</u>	<u>799,192.00</u>	<u>✓</u>

BIDS WERE GIVEN TO Jesus Villegas FOR STUDY AND RECOMMENDATION TO CITY COUNCIL.

DEBRA JACKSON  
CITY CLERK

11-3-2020  
DATE



# BID Opening Act

## BID No. 2020-08

CLASS I AND CLASS II BIKE FACILITY ALONG THE NORTH SIDE OF ATEN BOULEVARD FROM DOGWOOD ROAD TO PUERTO VALLARTA AVENUE

Bids received by: \_\_\_\_\_

Were opened at \_\_\_\_\_ on \_\_\_\_\_

By: \_\_\_\_\_

Witnessed by:

Signature

\_\_\_\_\_  
\_\_\_\_\_  
\_\_\_\_\_

\_\_\_\_\_  
\_\_\_\_\_  
\_\_\_\_\_

COMPANY

BID AMOUNT

BID BOND

GRANITE CONST.

768,867.00

✓

\_\_\_\_\_  
\_\_\_\_\_  
\_\_\_\_\_  
\_\_\_\_\_

\_\_\_\_\_  
\_\_\_\_\_  
\_\_\_\_\_  
\_\_\_\_\_

\_\_\_\_\_  
\_\_\_\_\_  
\_\_\_\_\_  
\_\_\_\_\_

BIDS WERE GIVEN TO Jesus Villegas FOR STUDY AND RECOMMENDATION TO CITY COUNCIL.

  
DEBRA JACKSON  
CITY CLERK

11-3-2020  
DATE