





DATE SUBMITTED 3/28/2018
 SUBMITTED BY COMMUNITY DEVELOPMENT DIRECTOR MORA
 DATE ACTION REQUIRED 4/4/2018

COUNCIL ACTION (X)
 PUBLIC HEARING REQUIRED ()
 RESOLUTION ()
 ORDINANCE 1ST READING ()
 ORDINANCE 2ND READING ()
 CITY CLERK'S INITIALS 

**IMPERIAL CITY COUNCIL
 AGENDA ITEM**

SUBJECT: DISCUSSION/ACTION: IMPERIAL TRANSIT PARK, FEDERAL AID PROJECT CA 04-244 1. AUTHORIZATION TO SEEK BIDS	
DEPARTMENT INVOLVED: COMMUNITY DEVELOPMENT DEPARTMENT	
BACKGROUND/SUMMARY: In 2012, the City applied for a Department of Transportation Federal Transit Administration (FTA) grant to design and construct a Transit Park. The Imperial County Transportation Commission (ICTC) has entered into an MOU with the City of Imperial to assist with the delivery of this project. The Transit Park is a transfer station that will provide access for pedestrians and bicyclist to travel to regional and local bus stations. The location of the Transit Park is on a vacant lot on Barioni Boulevard between 'L' and 'M' Streets. The lot was purchased in early September 2014. The project is anticipated to be completed by December 2018. See the attached proposed project timeline and cost estimate spreadsheet, along with the Imperial Transit Park Plans. We are requesting authorization to seek bids for the transit park.	
FISCAL IMPACT: \$186,250,000.00 from the Public Transportation Modernization Improvement, and Service Enhancement Account Program (PTMISEA), \$747,000.00 from FTA, \$259,411.00 LTA MES 'D', and \$33,246.00 Park Impact Fees, for a total of \$1,225,907.00	ADMIN SERVICES SIGN INITIALS 
STAFF RECOMMENDATION: Authorization to seek bids.	DEPT. INITIALS 
MANAGER'S RECOMMENDATION:	CITY MANAGER'S INITIALS 
MOTION:	
SECONDED: AYES: NAYES: ABSENT:	APPROVED () REJECTED () DISAPPROVED () DEFERRED () REFERRED TO:

IMPERIAL TRANSIT PARK

AT BARIONI BLVD. BETWEEN L ST. TO M ST.

IN THE CITY OF IMPERIAL, COUNTY OF IMPERIAL, STATE OF CALIFORNIA

GENERAL NOTES:

1. ALL CONSTRUCTION SHALL BE IN ACCORDANCE WITH THE CITY OF IMPERIAL SPECIFICATIONS FOR CONSTRUCTION.
2. THE CONTRACTOR SHALL BE RESPONSIBLE FOR OBTAINING ALL NECESSARY PERMITS AND APPROVALS FROM THE CITY OF IMPERIAL, COUNTY OF IMPERIAL, STATE OF CALIFORNIA AND ANY AGENCIES WITH JURISDICTION OVER THE PROJECT.
3. APPROVAL OF THESE INSTRUMENTS SHALL BE SUBJECT TO THE CITY OF IMPERIAL, COUNTY OF IMPERIAL, STATE OF CALIFORNIA AND ANY AGENCIES WITH JURISDICTION OVER THE PROJECT.
4. ALL UNDERGROUND UTILITIES SHALL BE PROTECTED AND MAINTAINED. ALL UTILITIES SHALL BE DEEPER THAN THE PROPOSED CONSTRUCTION.
5. ALL UTILITIES SHALL BE PROTECTED AND MAINTAINED. ALL UTILITIES SHALL BE DEEPER THAN THE PROPOSED CONSTRUCTION.
6. ALL UTILITIES SHALL BE PROTECTED AND MAINTAINED. ALL UTILITIES SHALL BE DEEPER THAN THE PROPOSED CONSTRUCTION.
7. ALL UTILITIES SHALL BE PROTECTED AND MAINTAINED. ALL UTILITIES SHALL BE DEEPER THAN THE PROPOSED CONSTRUCTION.
8. ALL UTILITIES SHALL BE PROTECTED AND MAINTAINED. ALL UTILITIES SHALL BE DEEPER THAN THE PROPOSED CONSTRUCTION.
9. ALL UTILITIES SHALL BE PROTECTED AND MAINTAINED. ALL UTILITIES SHALL BE DEEPER THAN THE PROPOSED CONSTRUCTION.
10. ALL UTILITIES SHALL BE PROTECTED AND MAINTAINED. ALL UTILITIES SHALL BE DEEPER THAN THE PROPOSED CONSTRUCTION.
11. ALL UTILITIES SHALL BE PROTECTED AND MAINTAINED. ALL UTILITIES SHALL BE DEEPER THAN THE PROPOSED CONSTRUCTION.
12. ALL UTILITIES SHALL BE PROTECTED AND MAINTAINED. ALL UTILITIES SHALL BE DEEPER THAN THE PROPOSED CONSTRUCTION.
13. ALL UTILITIES SHALL BE PROTECTED AND MAINTAINED. ALL UTILITIES SHALL BE DEEPER THAN THE PROPOSED CONSTRUCTION.
14. ALL UTILITIES SHALL BE PROTECTED AND MAINTAINED. ALL UTILITIES SHALL BE DEEPER THAN THE PROPOSED CONSTRUCTION.
15. ALL UTILITIES SHALL BE PROTECTED AND MAINTAINED. ALL UTILITIES SHALL BE DEEPER THAN THE PROPOSED CONSTRUCTION.
16. ALL UTILITIES SHALL BE PROTECTED AND MAINTAINED. ALL UTILITIES SHALL BE DEEPER THAN THE PROPOSED CONSTRUCTION.
17. ALL UTILITIES SHALL BE PROTECTED AND MAINTAINED. ALL UTILITIES SHALL BE DEEPER THAN THE PROPOSED CONSTRUCTION.
18. ALL UTILITIES SHALL BE PROTECTED AND MAINTAINED. ALL UTILITIES SHALL BE DEEPER THAN THE PROPOSED CONSTRUCTION.
19. ALL UTILITIES SHALL BE PROTECTED AND MAINTAINED. ALL UTILITIES SHALL BE DEEPER THAN THE PROPOSED CONSTRUCTION.
20. ALL UTILITIES SHALL BE PROTECTED AND MAINTAINED. ALL UTILITIES SHALL BE DEEPER THAN THE PROPOSED CONSTRUCTION.
21. ALL UTILITIES SHALL BE PROTECTED AND MAINTAINED. ALL UTILITIES SHALL BE DEEPER THAN THE PROPOSED CONSTRUCTION.
22. ALL UTILITIES SHALL BE PROTECTED AND MAINTAINED. ALL UTILITIES SHALL BE DEEPER THAN THE PROPOSED CONSTRUCTION.
23. ALL UTILITIES SHALL BE PROTECTED AND MAINTAINED. ALL UTILITIES SHALL BE DEEPER THAN THE PROPOSED CONSTRUCTION.
24. ALL UTILITIES SHALL BE PROTECTED AND MAINTAINED. ALL UTILITIES SHALL BE DEEPER THAN THE PROPOSED CONSTRUCTION.
25. ALL UTILITIES SHALL BE PROTECTED AND MAINTAINED. ALL UTILITIES SHALL BE DEEPER THAN THE PROPOSED CONSTRUCTION.

GENERAL NOTES (CONT.):

16. UNLESS SPECIFICALLY INDICATED OTHERWISE, MATERIALS SHALL BE OF THE BEST QUALITY AVAILABLE AND SHALL BE SUBJECT TO INSPECTION AND APPROVAL BY THE CITY OF IMPERIAL, COUNTY OF IMPERIAL, STATE OF CALIFORNIA AND ANY AGENCIES WITH JURISDICTION OVER THE PROJECT.
17. THE CONTRACTOR SHALL BE RESPONSIBLE FOR OBTAINING ALL NECESSARY PERMITS AND APPROVALS FROM THE CITY OF IMPERIAL, COUNTY OF IMPERIAL, STATE OF CALIFORNIA AND ANY AGENCIES WITH JURISDICTION OVER THE PROJECT.
18. THE CONTRACTOR SHALL BE RESPONSIBLE FOR OBTAINING ALL NECESSARY PERMITS AND APPROVALS FROM THE CITY OF IMPERIAL, COUNTY OF IMPERIAL, STATE OF CALIFORNIA AND ANY AGENCIES WITH JURISDICTION OVER THE PROJECT.
19. THE CONTRACTOR SHALL BE RESPONSIBLE FOR OBTAINING ALL NECESSARY PERMITS AND APPROVALS FROM THE CITY OF IMPERIAL, COUNTY OF IMPERIAL, STATE OF CALIFORNIA AND ANY AGENCIES WITH JURISDICTION OVER THE PROJECT.
20. THE CONTRACTOR SHALL BE RESPONSIBLE FOR OBTAINING ALL NECESSARY PERMITS AND APPROVALS FROM THE CITY OF IMPERIAL, COUNTY OF IMPERIAL, STATE OF CALIFORNIA AND ANY AGENCIES WITH JURISDICTION OVER THE PROJECT.
21. THE CONTRACTOR SHALL BE RESPONSIBLE FOR OBTAINING ALL NECESSARY PERMITS AND APPROVALS FROM THE CITY OF IMPERIAL, COUNTY OF IMPERIAL, STATE OF CALIFORNIA AND ANY AGENCIES WITH JURISDICTION OVER THE PROJECT.
22. THE CONTRACTOR SHALL BE RESPONSIBLE FOR OBTAINING ALL NECESSARY PERMITS AND APPROVALS FROM THE CITY OF IMPERIAL, COUNTY OF IMPERIAL, STATE OF CALIFORNIA AND ANY AGENCIES WITH JURISDICTION OVER THE PROJECT.
23. THE CONTRACTOR SHALL BE RESPONSIBLE FOR OBTAINING ALL NECESSARY PERMITS AND APPROVALS FROM THE CITY OF IMPERIAL, COUNTY OF IMPERIAL, STATE OF CALIFORNIA AND ANY AGENCIES WITH JURISDICTION OVER THE PROJECT.
24. THE CONTRACTOR SHALL BE RESPONSIBLE FOR OBTAINING ALL NECESSARY PERMITS AND APPROVALS FROM THE CITY OF IMPERIAL, COUNTY OF IMPERIAL, STATE OF CALIFORNIA AND ANY AGENCIES WITH JURISDICTION OVER THE PROJECT.
25. THE CONTRACTOR SHALL BE RESPONSIBLE FOR OBTAINING ALL NECESSARY PERMITS AND APPROVALS FROM THE CITY OF IMPERIAL, COUNTY OF IMPERIAL, STATE OF CALIFORNIA AND ANY AGENCIES WITH JURISDICTION OVER THE PROJECT.

TRAFFIC CONTROL PLAN NOTE:

IT IS THE RESPONSIBILITY OF THE CONTRACTOR TO SUBMIT THE TRAFFIC CONTROL PLAN FOR THE PROJECT AT THE TIME OF REQUEST OF THE CITY OF IMPERIAL, COUNTY OF IMPERIAL, STATE OF CALIFORNIA AND ANY AGENCIES WITH JURISDICTION OVER THE PROJECT.

WATER POLLUTION CONTROL PLAN NOTE:

THE CONTRACTOR IS RESPONSIBLE FOR THE PREPARATION AND SUBMITTAL OF A WATER POLLUTION CONTROL PLAN FOR CITY APPROVAL.

SHEET INDEX:

C10	TITLE SHEET
C11	GENERAL NOTES
C12	CONSTRUCTION METHODS AND DETAIL PLAN
C13	CONSTRUCTION METHODS AND DETAIL PLAN
C14	CONSTRUCTION METHODS AND DETAIL PLAN
C15	CONSTRUCTION METHODS AND DETAIL PLAN
C16	CONSTRUCTION METHODS AND DETAIL PLAN
C17	CONSTRUCTION METHODS AND DETAIL PLAN
C18	CONSTRUCTION METHODS AND DETAIL PLAN
C19	CONSTRUCTION METHODS AND DETAIL PLAN
C20	CONSTRUCTION METHODS AND DETAIL PLAN
C21	CONSTRUCTION METHODS AND DETAIL PLAN
C22	CONSTRUCTION METHODS AND DETAIL PLAN
C23	CONSTRUCTION METHODS AND DETAIL PLAN
C24	CONSTRUCTION METHODS AND DETAIL PLAN
C25	CONSTRUCTION METHODS AND DETAIL PLAN

LANDSCAPE

L-1	LANDSCAPE TITLE SHEET
L-2	LANDSCAPE GENERAL NOTES
L-3	LANDSCAPE GENERAL NOTES
L-4	LANDSCAPE GENERAL NOTES
L-5	LANDSCAPE GENERAL NOTES
L-6	LANDSCAPE GENERAL NOTES
L-7	LANDSCAPE GENERAL NOTES
L-8	LANDSCAPE GENERAL NOTES
L-9	LANDSCAPE GENERAL NOTES
L-10	LANDSCAPE GENERAL NOTES
L-11	LANDSCAPE GENERAL NOTES
L-12	LANDSCAPE GENERAL NOTES
L-13	LANDSCAPE GENERAL NOTES
L-14	LANDSCAPE GENERAL NOTES
L-15	LANDSCAPE GENERAL NOTES
L-16	LANDSCAPE GENERAL NOTES

ELECTRICAL

E-1	ELECTRICAL GENERAL NOTES
E-2	ELECTRICAL GENERAL NOTES
E-3	ELECTRICAL GENERAL NOTES
E-4	ELECTRICAL GENERAL NOTES
E-5	ELECTRICAL GENERAL NOTES
E-6	ELECTRICAL GENERAL NOTES
E-7	ELECTRICAL GENERAL NOTES
E-8	ELECTRICAL GENERAL NOTES

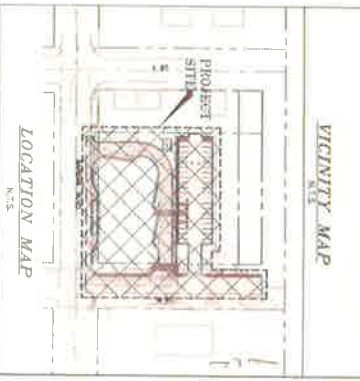

PSOMAS

Professional Services

420 South Imperial Avenue
Imperial, CA 92251

Ph: (760) 355-3840 • Fax: (760) 355-4718

CITY OF IMPERIAL

COMMUNITY DEVELOPMENT DEPARTMENT

IMPERIAL TRANSIT PARK

DATE: 2/27/2018

SHEET 1 OF 30

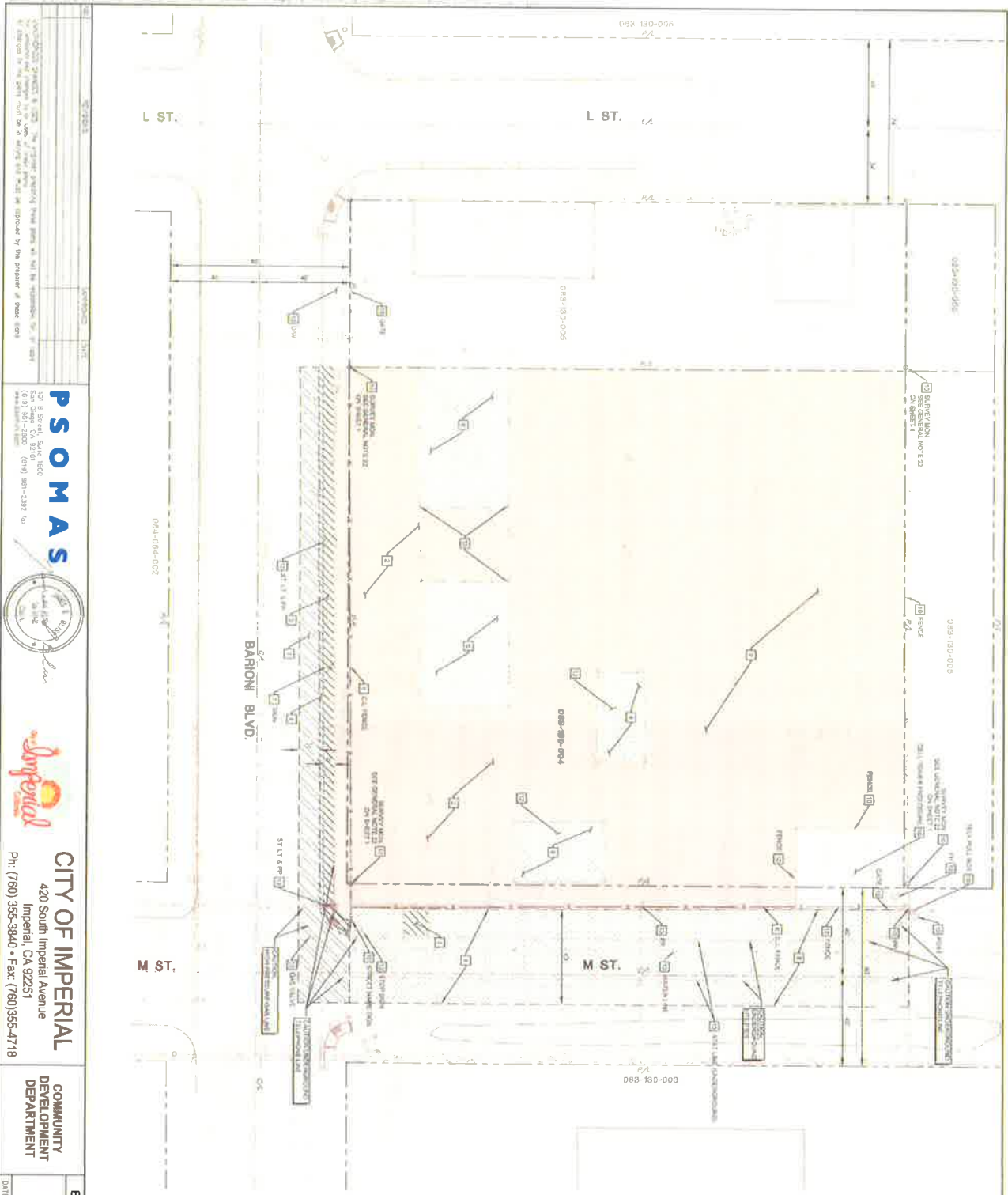

- DEMOLITION LEGEND:**
- 1 REMOVE & REPLACE OF EXISTING ROADWAY AND SIDE SECTION (SEE SHEET CA 1)
 - 2 REMOVE & REPLACE OF EXISTING ASPHALT, SURFACING AND ADDITIONAL SOLAS TO TOP OF NEW SUBGRADE (SEE SHEET CA 1)
 - 3 REMOVE & REPLACE OF EXISTING CONCRETE WALKWAYS
 - 4 REMOVE & REPLACE OF EXISTING CONCRETE CURB AND GUTTER (NOT USED)
 - 5 REMOVE EXISTING SIGN
 - 6 REMOVE EXISTING SIGN AND CONDUIT
 - 7 REMOVE EXISTING LIGHT AND CONDUIT
 - 8 REMOVE EXISTING POWER POLE (NOT USED)
 - 9 REMOVE PRE-CAST CONCRETE FOOTINGS
 - 10 REMOVE EXISTING EXTERIOR STREET LIGHT POLE (SEE CA 1)

CONTRACTOR SHALL BE RESPONSIBLE FOR OBTAINING ALL NECESSARY PERMITS AND APPROVALS FROM THE CITY OF IMPERIAL AND THE CALIFORNIA DEPARTMENT OF INDUSTRIAL RELATIONS (DIR) PRIOR TO THE START OF CONSTRUCTION. THE CONTRACTOR SHALL BE RESPONSIBLE FOR OBTAINING ALL NECESSARY PERMITS AND APPROVALS FROM THE CITY OF IMPERIAL AND THE CALIFORNIA DEPARTMENT OF INDUSTRIAL RELATIONS (DIR) PRIOR TO THE START OF CONSTRUCTION.

PSOMAS
 407 S. Street, Suite 1600
 San Diego, CA 92101
 (619) 591-2392 fax

CITY OF IMPERIAL
 420 South Imperial Avenue
 Imperial, CA 92251
 Ph: (760) 365-3940 • Fax: (760) 365-4718

COMMUNITY DEVELOPMENT DEPARTMENT

EXISTING CONDITIONS AND DEMOLITION PLAN
 IMPERIAL TRANSIST PARK

SHEET 3
 30 SHEET 3

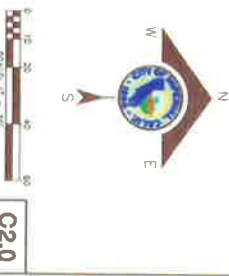

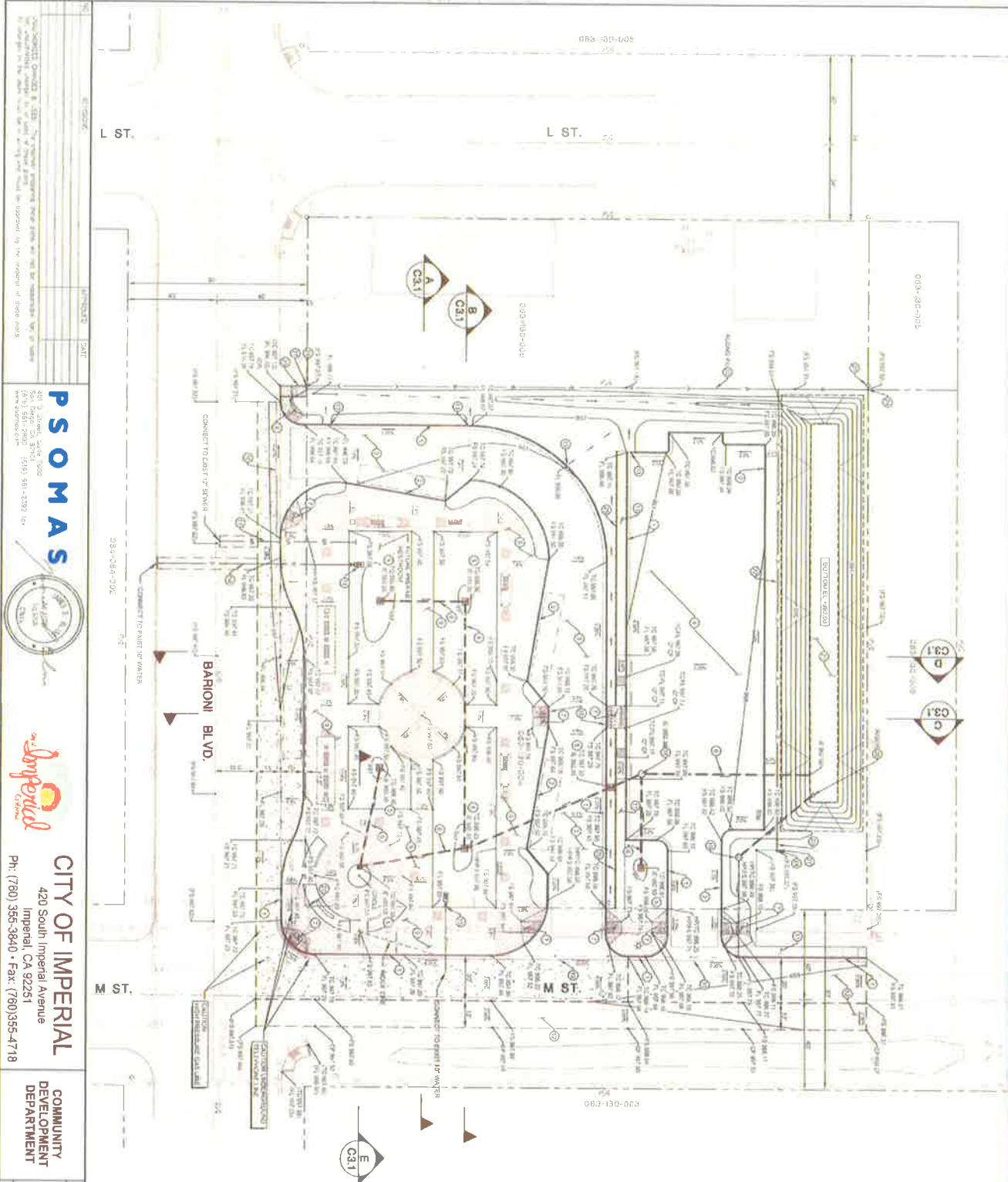

CONSTRUCTION NOTES:

- 1) CONSTRUCT 1" PCC CURB AND GUTTER PER CSD NO. 21
- 2) CONSTRUCT 1" PCC CURB R&P CSD NO. 21
- 3) VERTICAL CURB TO 1" MAXIMUM HEIGHT
- 4) FINISH TO 1" MAXIMUM
- 5) 12" X 12" CATCH BASIN PER CSD NO. 21
- 6) 6" STORM DRAIN PIPE PER CSD NO. 21
- 7) CONSTRUCT 104" B&W PER CSD NO. 21
- 8) CONSTRUCT CURB H&W TYPE C MODIFIED PER CSD NO. 21
- 9) PRECISSTMA CONCRETE WALKWAY PER CSD NO. 21
- 10) CONSTRUCT 1" PCC CROSS GUTTER PER CSD NO. 21
- 11) CONSTRUCT 1" PCC SIDEWALK PER CSD NO. 21
- 12) RIDEWAY PAVEMENT PER CSD NO. 21
- 13) CURB OPENING FOR POULDRE PER CSD NO. 21
- 14) HYDRAULIC WATER SERVICE & WATER SERVICE NO. 4"
- 15) 1" REGULATION SERVICE & WATER PER CSD NO. 21
- 16) 1" DOMESTIC WATER SERVICE PER CSD NO. 21
- 17) 1" DOMESTIC WATER SERVICE PER CSD NO. 21
- 18) 1" DOMESTIC WATER SERVICE PER CSD NO. 21
- 19) CONSTRUCT STORM DRAIN CLEANOUT PER CSD NO. 21
- 20) CONSTRUCT STORM DRAIN CLEANOUT WITH 2" AIR FLAP PER CSD NO. 21
- 21) CONSTRUCT SIDEWALK UNDERDRAIN PER CSD NO. 21
- 22) CONSTRUCT 1" B&W UNDERDRAIN PER CSD NO. 21
- 23) INSTALL 6" HIGH CHAIN LINK FENCE PER CSD NO. 21
- 24) INSTALL 6" HIGH 4" WIRE CHAIN LINK GATE PER CSD NO. 21
- 25) CONNECT TO EXISTING FENCE
- 26) INSTALL 4" HIGH VINYL COATED CHAIN LINK FENCE PER CSD NO. 21
- 27) CURB HEIGHT AT CROSSWALK
- 28) EXISTING SURVEY MONUMENTS SEE GENERAL NOTE ON SHEET 1
- 29) AS-BUILT DETAIL
- 30) SEE 1 SHEETS FOR MANDATORY PLANTERS TREES, ETC.

GRADING, PAVING AND UTILITY PLAN
IMPERIAL TRANSIT PARK

DATE: 2/27/2018

SHEET **4** OF **30**

C3.0

PSOMAS
 401 S. Alhambra, Suite 1000
 5050 Harbor Blvd, Suite 200
 Imperial, CA 92251
 www.psomas.com (619) 561-3332 Fax

CITY OF IMPERIAL
 420 South Imperial Avenue
 Imperial, CA 92251
 Ph: (760) 365-3840 • Fax: (760)365-4718

COMMUNITY DEVELOPMENT DEPARTMENT

Imperial
 420 South Imperial Avenue
 Imperial, CA 92251
 Ph: (760) 365-3840 • Fax: (760)365-4718

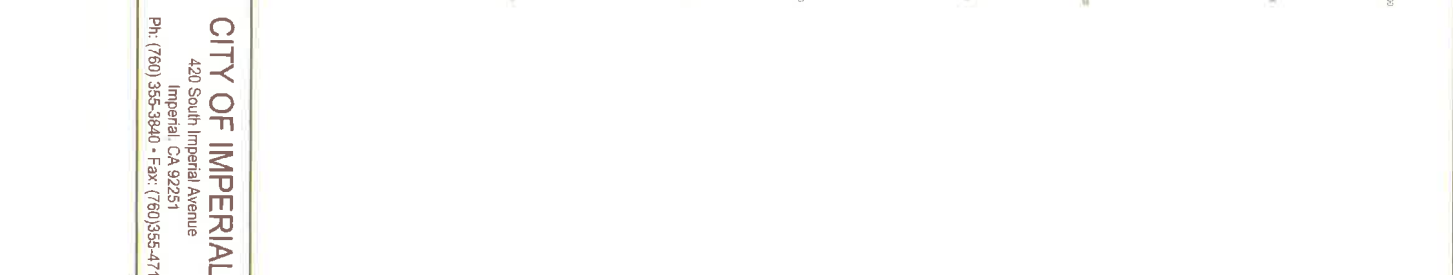
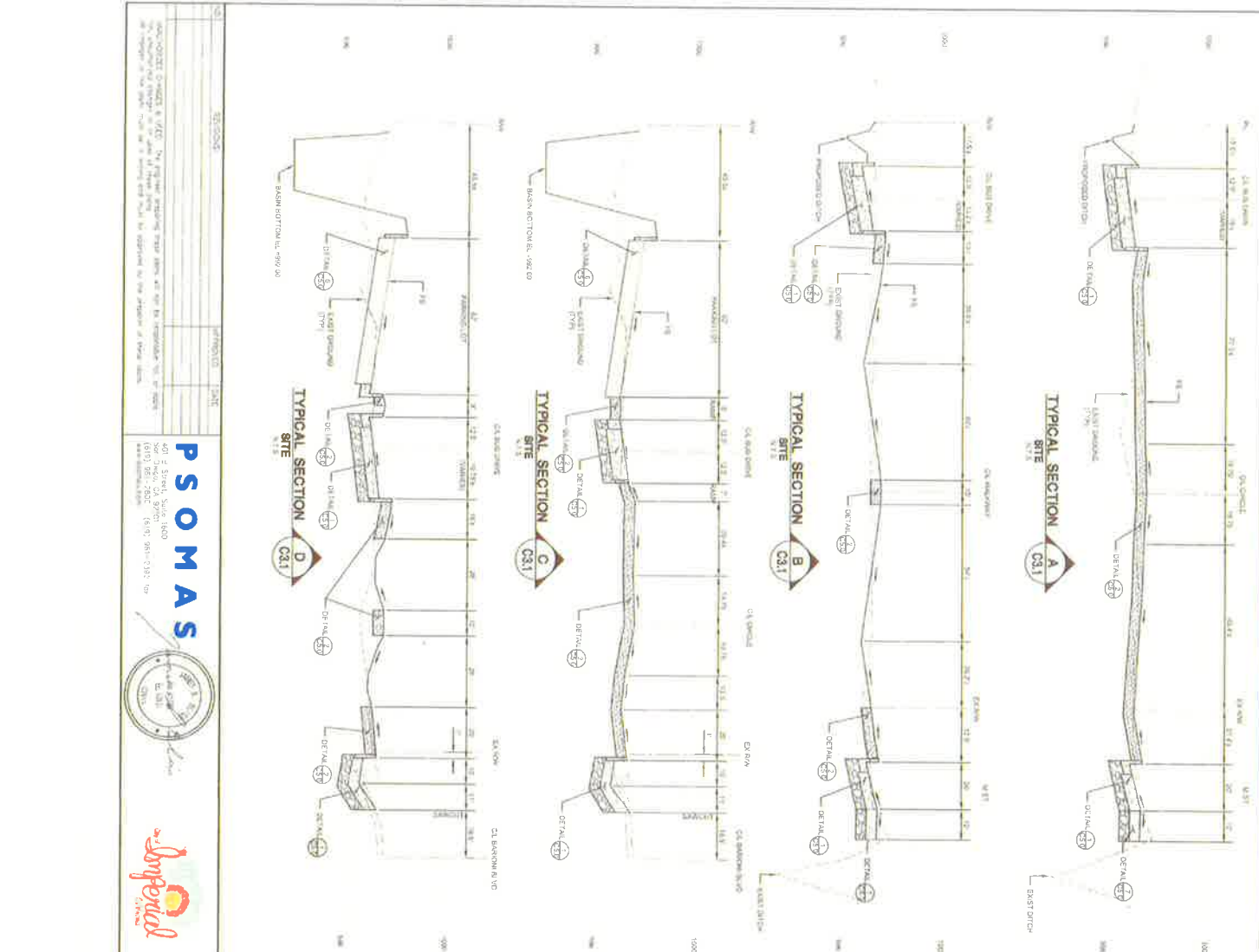

GEOTECHNICAL SPECIFICATIONS:

THE CONTRACTOR SHALL BE RESPONSIBLE FOR OBTAINING ALL NECESSARY PERMITS AND APPROVALS FROM THE CITY OF IMPERIAL AND THE CALIFORNIA DEPARTMENT OF WATER RESOURCES. THE CONTRACTOR SHALL BE RESPONSIBLE FOR OBTAINING ALL NECESSARY PERMITS AND APPROVALS FROM THE CALIFORNIA DEPARTMENT OF WATER RESOURCES. THE CONTRACTOR SHALL BE RESPONSIBLE FOR OBTAINING ALL NECESSARY PERMITS AND APPROVALS FROM THE CALIFORNIA DEPARTMENT OF WATER RESOURCES.

THE CONTRACTOR SHALL BE RESPONSIBLE FOR OBTAINING ALL NECESSARY PERMITS AND APPROVALS FROM THE CITY OF IMPERIAL AND THE CALIFORNIA DEPARTMENT OF WATER RESOURCES. THE CONTRACTOR SHALL BE RESPONSIBLE FOR OBTAINING ALL NECESSARY PERMITS AND APPROVALS FROM THE CALIFORNIA DEPARTMENT OF WATER RESOURCES. THE CONTRACTOR SHALL BE RESPONSIBLE FOR OBTAINING ALL NECESSARY PERMITS AND APPROVALS FROM THE CALIFORNIA DEPARTMENT OF WATER RESOURCES.

THE CONTRACTOR SHALL BE RESPONSIBLE FOR OBTAINING ALL NECESSARY PERMITS AND APPROVALS FROM THE CITY OF IMPERIAL AND THE CALIFORNIA DEPARTMENT OF WATER RESOURCES. THE CONTRACTOR SHALL BE RESPONSIBLE FOR OBTAINING ALL NECESSARY PERMITS AND APPROVALS FROM THE CALIFORNIA DEPARTMENT OF WATER RESOURCES. THE CONTRACTOR SHALL BE RESPONSIBLE FOR OBTAINING ALL NECESSARY PERMITS AND APPROVALS FROM THE CALIFORNIA DEPARTMENT OF WATER RESOURCES.

THE CONTRACTOR SHALL BE RESPONSIBLE FOR OBTAINING ALL NECESSARY PERMITS AND APPROVALS FROM THE CITY OF IMPERIAL AND THE CALIFORNIA DEPARTMENT OF WATER RESOURCES. THE CONTRACTOR SHALL BE RESPONSIBLE FOR OBTAINING ALL NECESSARY PERMITS AND APPROVALS FROM THE CALIFORNIA DEPARTMENT OF WATER RESOURCES. THE CONTRACTOR SHALL BE RESPONSIBLE FOR OBTAINING ALL NECESSARY PERMITS AND APPROVALS FROM THE CALIFORNIA DEPARTMENT OF WATER RESOURCES.

PSOMAS
5330 S. STATE ST., SUITE 1800
IMPERIAL, CA 92251
(619) 361-2800 (619) 361-0317 fax
www.psomas.com



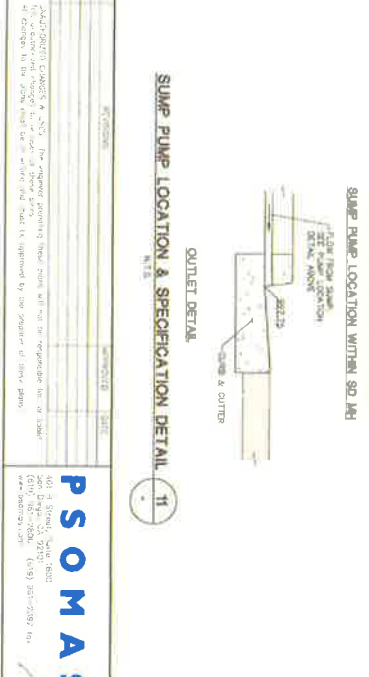
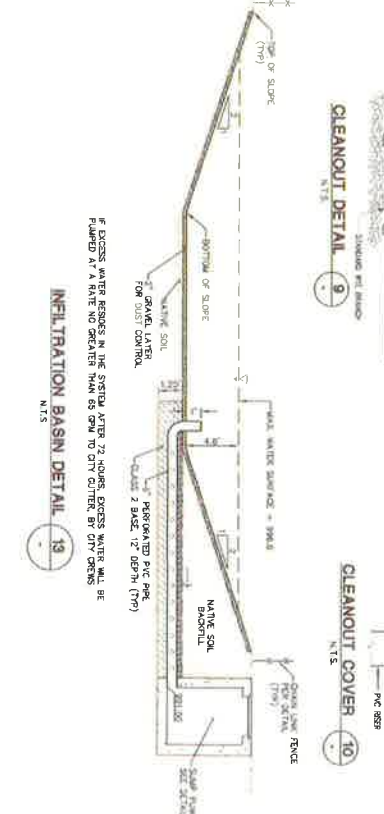
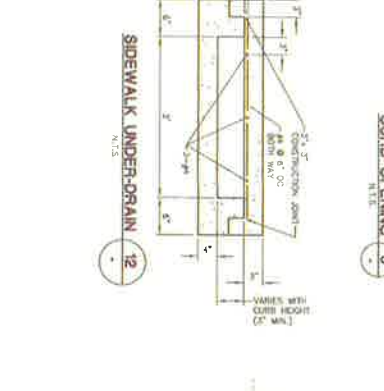
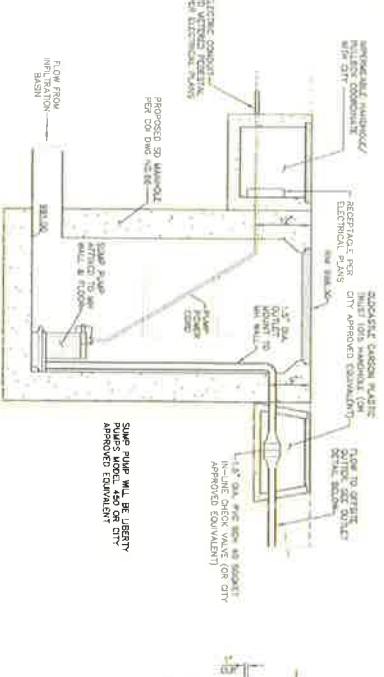
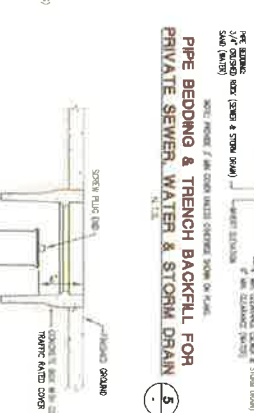
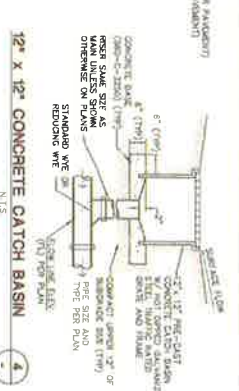
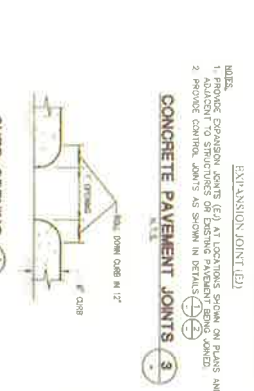
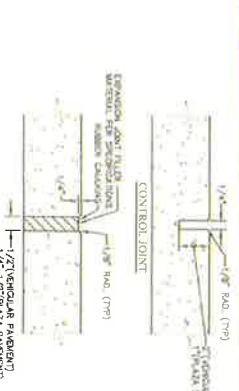
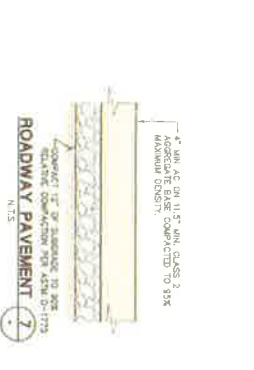
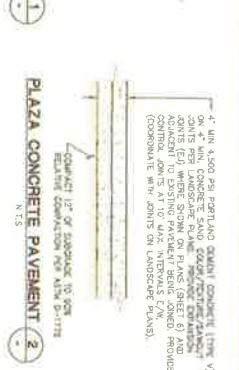

PSOMAS
 461 S Street, Suite 200
 San Diego, CA 92101
 (619) 592-2887
 www.psomas.com

CITY OF IMPERIAL
 420 South Imperial Avenue
 Imperial, CA 92251
 Ph: (760) 365-3840 • Fax: (760) 365-4718

COMMUNITY DEVELOPMENT DEPARTMENT
 IMPERIAL TRANSIT PARK
 DATE: 2/27/2018
 SHEET 7 OF 30

BUS SIGN GENERAL NOTES:

- 1) ALL DIMENSIONS SHALL BE PROVIDED BY SIGN CONTRACTOR. LETTERS SHALL BE FABRICATED BY SIGN CONTRACTOR. CONTRACTOR SHALL PROVIDE THE SIGN CONTRACTOR WITH THE SIGN CONTRACTOR'S SCHEDULE AND ON THE DRAWINGS.
- 2) ALL INSTALLATION LOCATIONS, SITE CONDITIONS AND EXISTING DIMENSIONS SHALL BE FIELD VERIFIED PRIOR TO INSTALLATION.
- 3) SIGN CONTRACTOR TO PROVIDE ALL ENGINEERING OF SIGN AND SIGNING. SIGN CONTRACTOR SHALL PROVIDE THE SIGN CONTRACTOR WITH THE SIGN CONTRACTOR'S SCHEDULE AND ON THE DRAWINGS.
- 4) SIGN CONTRACTOR TO PROVIDE SHOP DRAWINGS FOR ALL SIGNS. ALL ATTACHMENT DETAILS SHALL BE SIGN CONTRACTOR'S RESPONSIBILITY. SIGN CONTRACTOR SHALL PROVIDE THE SIGN CONTRACTOR WITH THE SIGN CONTRACTOR'S SCHEDULE AND ON THE DRAWINGS.
- 5) ALL DIMENSIONS SHALL CONFORM TO LOCAL CODES. TYPICAL SIGN CHARACTERISTICS SHALL BE FIELD VERIFIED PRIOR TO INSTALLATION.
- 6) ALL DIMENSIONS SHALL CONFORM TO LOCAL CODES. TYPICAL SIGN CHARACTERISTICS SHALL BE FIELD VERIFIED PRIOR TO INSTALLATION.
- 7) ALL DIMENSIONS SHALL CONFORM TO LOCAL CODES. TYPICAL SIGN CHARACTERISTICS SHALL BE FIELD VERIFIED PRIOR TO INSTALLATION.

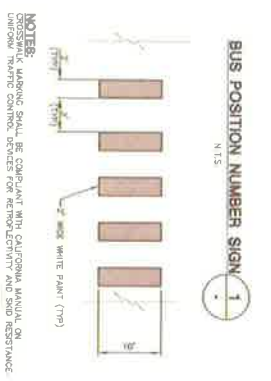
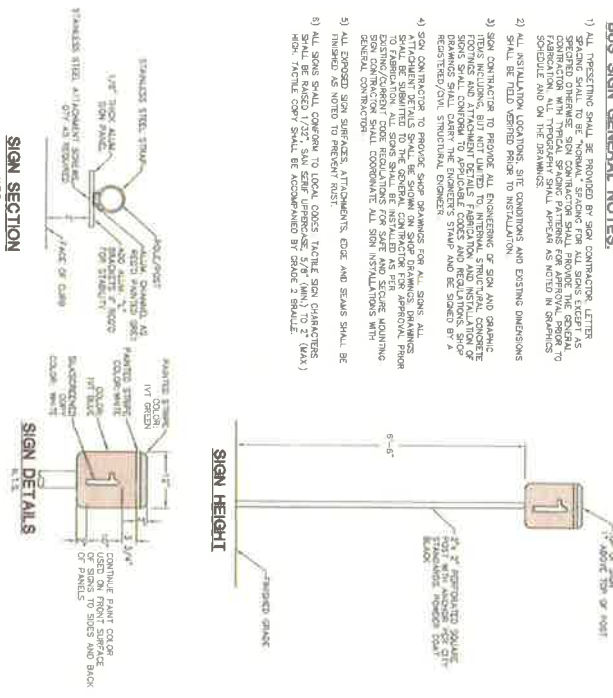

NOTES:
 CROSSWALK STRIPING SHALL BE COMPLIANT WITH CALIFORNIA MANUAL ON UNIFORM TRAFFIC CONTROL DEVICES FOR INTERSECTION AND ROAD RESURFACING.
 ALL DIMENSIONS SHALL BE FIELD VERIFIED PRIOR TO INSTALLATION.
 ALL DIMENSIONS SHALL CONFORM TO LOCAL CODES. TYPICAL SIGN CHARACTERISTICS SHALL BE FIELD VERIFIED PRIOR TO INSTALLATION.

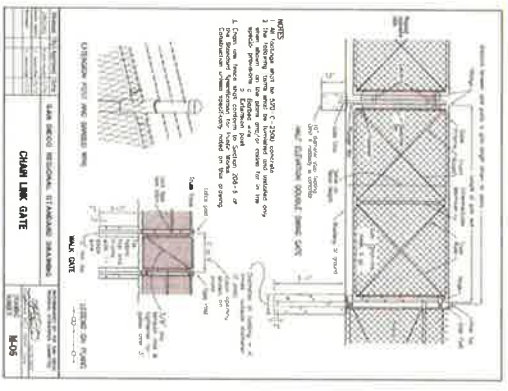
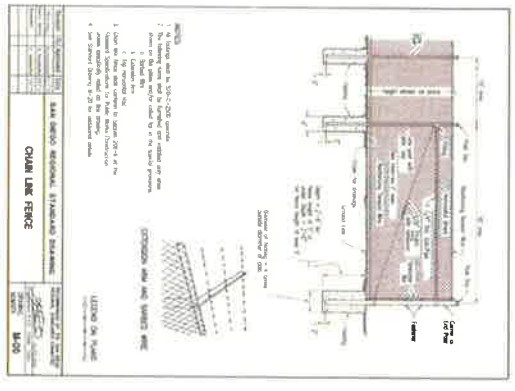
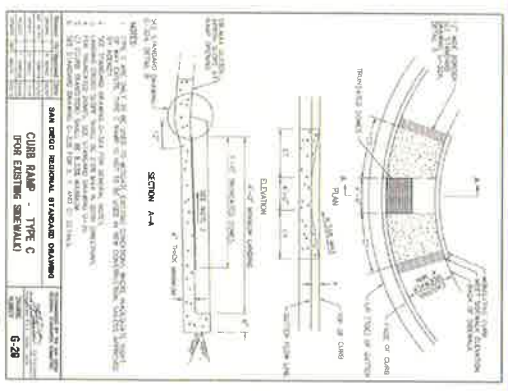

PSOMAS
 401 S. Street, Suite 1800
 San Diego, CA 92101
 (619) 581-3012
 www.psomas.com



CITY OF IMPERIAL
 420 South Imperial Avenue
 Imperial, CA 92251
 Ph: (760) 365-3840 - Fax: (760)355-4718

COMMUNITY DEVELOPMENT DEPARTMENT

IMPERIAL TRANSIT PARK

CIVIL DETAILS
 SHEET **8**
30 OF 30

C5.1

DATE: 2/27/2018

LANDSCAPE PLANS PREPARED FOR: IMPERIAL TRANSIT PARK AT BARRIONI BLVD. BETWEEN L ST. TO M ST. CITY OF IMPERIAL IMPERIAL COUNTY, CALIFORNIA

GENERAL SPECIFICATIONS

1. All local, municipal and state laws, rules and regulations governing or relating to any portion of this work are hereby incorporated into and made a part of these specifications and their provisions shall govern the work.
2. Contractor shall have a valid contractor license required for the particular work being done.
3. Contractor shall allow the contractor to be present during the entire project.
4. Contractor shall verify the location of all existing utilities, structures, and services before commencing work. The locations of utilities, structures and services shown on these plans are approximate only. Any discrepancies between these plans and actual field conditions shall be reported to the City of Imperial.
5. Contractor shall protect all existing utilities and features to remain on and adjacent to the project and during construction. Contractor shall repair all of its own damage or damage resulting from its operations or negligence.
6. Contractor shall obtain the permit engineering services or professional plans requiring permit engineering work.
7. Contractor shall obtain all necessary permits required to perform the work indicated herein under applicable laws.
8. Contractor shall arrange for payment of any permit fees and related expenses with the Owner's authorized representative.
9. Contractor shall obtain all necessary permits required to perform the work indicated herein under applicable laws.
10. Contractor shall not willfully violate any elements set forth on the plans, even if a variance in the field may exist. Conditions exist that were not evident at the time these plans were prepared. Any such conditions shall be brought to the attention of the City's representatives as soon as they are discovered. Contractor shall assume all responsibility for any field changes or conditions not shown on the plans.
11. All property lines shall be verified prior to commencing work, no construction item, including footings, shall extend past the property line.
12. Contractor shall be responsible for any coordination with subcontractors as required to accomplish all construction operations. All permit, conduit, sleeves, etc. shall be set in place prior to installation of construction items.
13. Contractor shall be responsible for relocating any existing materials that are damaged during construction.
14. The drawings and specifications represent the finished structure. All bracing, temporary supports, shoring, bracing, etc. are the sole responsibility of Contractor.
15. Obstruction shall be the job site by the Landscaper. Contractor is not responsible for any responsibility to communication methods and safety conditions at the work site. These shall not be construed as contractor and liability obligations.
16. All items and equipment of being shall be removed from the site as required by the Architect or City prior to opening a maximum of 48 hours notice is required.
17. All proposed surfaces shall meet existing surfaces with smooth hand construction transition and shall be finished with a smooth finish.
18. All dimensions are from outside face of paving, wall, curb, post, tree, etc. unless otherwise noted on plan. All angles are 90 or 45 degrees unless otherwise noted.
19. Contractor shall maintain a unilingual English speaking supervisor on site at all times during installation. Supervisor shall keep one copy available a current copy of the landscape and irrigation construction plans on which the site work shall be installed.
20. Contractor shall assume sole and complete responsibility for the job site conditions during construction of the project, including the safety of all persons and property. The Contractor shall protect all construction and existing foot, drainage and, when indicated, provide guards or covering. Any damage shall be repaired or replaced at the Contractor's expense.
21. Contractor shall defend, indemnify and hold the City and Landscaper harmless from any liability, real or alleged, in connection with the performance of the work on this project, including any claims arising out of this operation or the operations of any of its subcontractors, material suppliers, or agents accepting for liability, arising from the sole negligence of the City of Imperial.



VICINITY MAP

SHEET INDEX:

LANDSCAPE TITLE SHEET	9 (L-1)
HANDSCAPE PLAN, SITE AMENITIES AND FLAT WORK SCHEDULES	10 (L-2)
HANDSCAPE PLAN	11 (L-3)
HANDSCAPE DETAILS	12 (L-4)
HANDSCAPE DETAILS	13 (L-5)
HANDSCAPE DETAILS	14 (L-6)
HANDSCAPE DETAILS	15 (L-7)
IRRIGATION PLAN AND SCHEDULE	16 (L-8)
IRRIGATION PLAN AND NOTES	17 (L-9)
IRRIGATION LEGEND AND WATER USE CALCULATION	18 (L-10)
IRRIGATION DETAILS	19 (L-11)
IRRIGATION DETAILS	20 (L-12)
IRRIGATION DETAILS	21 (L-13)
PLANTING PLAN	22 (L-14)
PLANTING PLAN AND PLANT LIST	23 (L-15)
PLANTING DETAILS AND NOTES	24 (L-16)

PREPARED FOR:

CITY OF IMPERIAL
Phone: (760) 355-3840

PREPARED BY:

TESHIMA DESIGN GROUP
Contact: Mark Stempniak
9903 Businesspark Avenue, Suite 100
San Diego, CA 92131
858.693.8824

QUALITY CONTROL CHECKS & USES:
The contractor shall be responsible for maintaining these plans and shall be responsible for providing the necessary information to the City of Imperial for the purpose of the project. The contractor shall be responsible for providing the necessary information to the City of Imperial for the purpose of the project.

MAINTENANCE:
The contractor shall be responsible for maintaining the all systems and shall be responsible for providing the necessary information to the City of Imperial for the purpose of the project. The contractor shall be responsible for providing the necessary information to the City of Imperial for the purpose of the project.



L-1

PSOMAS
401 B Street, Suite 100
Imperial, CA 92251
(619) 355-2822
(619) 355-2822



CITY OF IMPERIAL
420 South Imperial Avenue
Imperial, CA 92251
Ph: (760) 355-3840 • Fax: (760) 355-4718

COMMUNITY
DEVELOPMENT
DEPARTMENT

LANDSCAPE TITLE SHEET
IMPERIAL TRANSIT PARK

DATE: 09/21/2017

SHEET
9
30 SHEETS



DATE: 2-1-18

TSD JOB NO. P-07

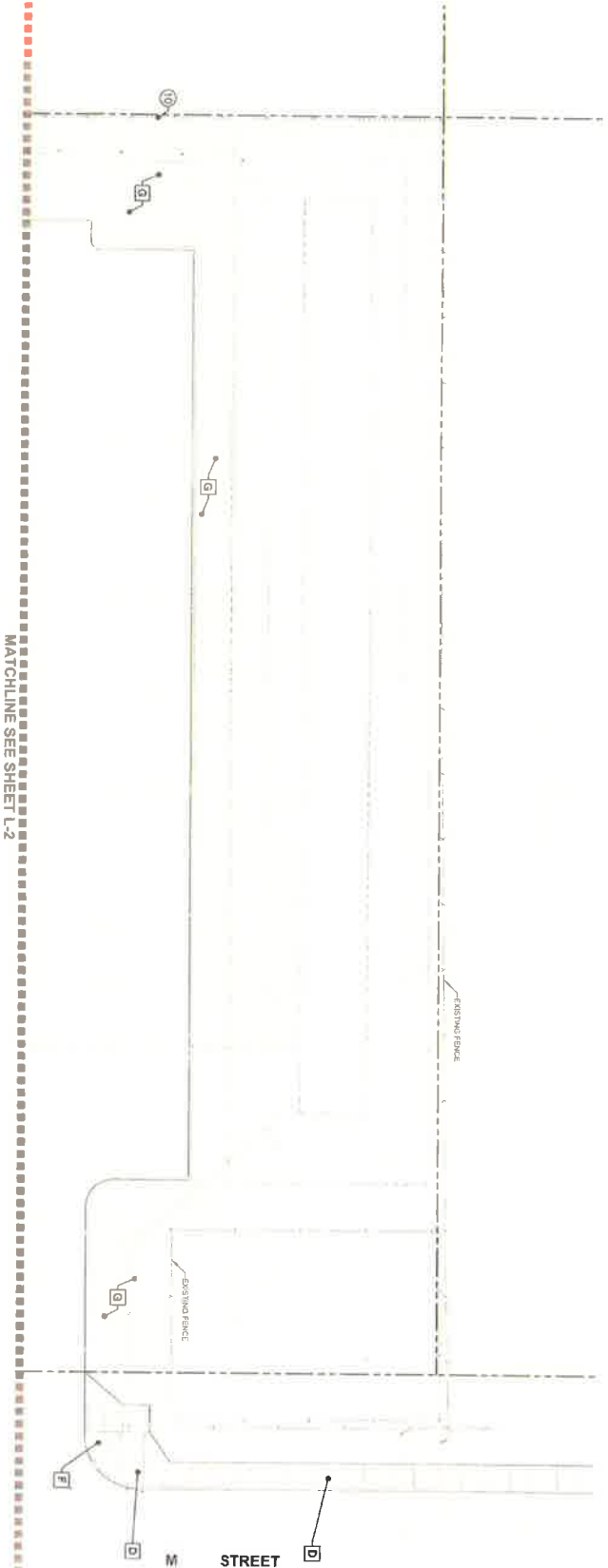

TESHIMA DESIGN GROUP
 ARCHITECTS
 1000 S. GARDEN AVENUE, SUITE 100
 ANAHEIM, CA 92805
 TEL: (714) 771-1100
 FAX: (714) 771-1101
 WWW.TESHIMADG.COM



SEE SHEET L-4, L-5, L-6 AND L-7 FOR HARDSCAPE DETAILS
 SEE SHEET L-2 FOR SITE AMENITIES SCHEDULE
 SEE SHEET L-2 FOR SITE FLAT WORK SCHEDULE

NO.	DESCRIPTION	DATE

PSOMAS
 401 B Street, Suite 150
 San Diego, CA 92101
 (619) 581-2500 (619) 581-2327 fax
 www.psomas.com



CITY OF IMPERIAL
 420 South Imperial Avenue
 Imperial, CA 92251
 Ph: (760) 355-3840 • Fax: (760)355-4718

COMMUNITY DEVELOPMENT DEPARTMENT

**HARDSCAPE PLAN
 IMPERIAL TRANSIT PARK**

DATE: 09/21/2017
 SHEET **11**
 OF **30** SHEETS

L-3

DATE: 09/21/2017

<p>1 BIKE RACK</p> <p>DATE: 2-5-18</p> <p>TESHIMA DESIGN GROUP 420 S STREET, SUITE 1000 IMPERIAL, CA 92251 (760) 355-9840 • FAX: (760) 355-4718</p>	<p>2 TRASH RECEPTACLE</p> <p>DATE: 2-5-18</p> <p>PSOMAS 420 S STREET, SUITE 1000 IMPERIAL, CA 92251 (760) 355-9840 • FAX: (760) 355-4718</p>	<p>3 SIGNAGE MONUMENT</p> <p>DATE: 2-5-18</p> <p>CITY OF IMPERIAL 420 SOUTH IMPERIAL AVENUE IMPERIAL, CA 92251 PH: (760) 355-9840 • FAX: (760) 355-4718</p>
<p>1</p>	<p>4 DECOMPOSED GRANITE WITH WEED CONTROL FABRIC</p>	<p>HARDSCAPE DETAILS</p> <p>IMPERIAL TRANSIT PARK</p> <p>DATE: 2/21/2017</p>

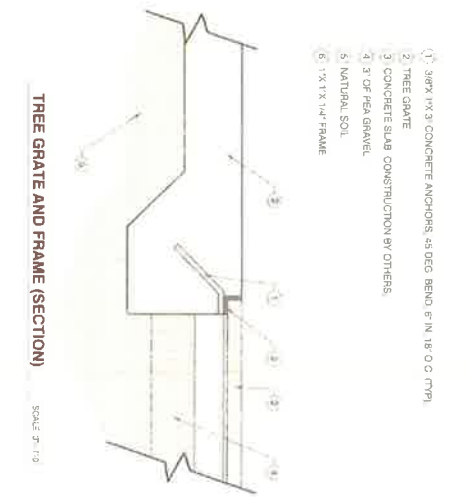
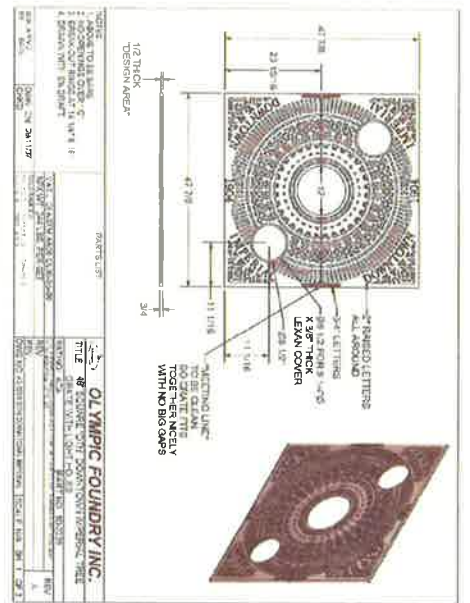
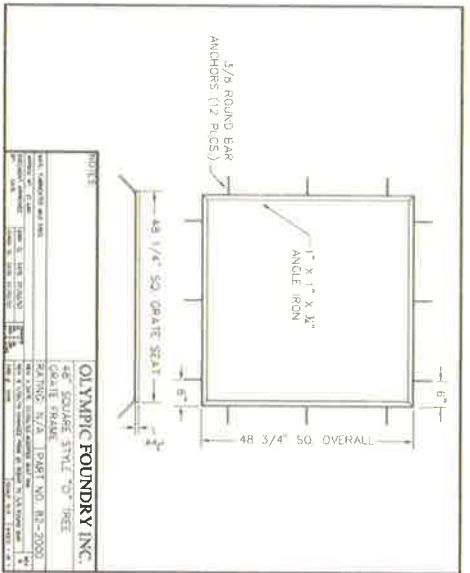

5 TREE GRATE AND FRAME

NOTE:
 1. ALL MATERIAL FROM OLYMPIC FOUNDRY, INC. CONTACT: (800) 878-1441
 2. ALL MATERIAL FROM MANUFACTURERS SPECIFICATIONS
 3. COLOR AND FINISH SHALL BE APPROVED BY THE CITY OF IMPERIAL PRIOR TO ORDERING

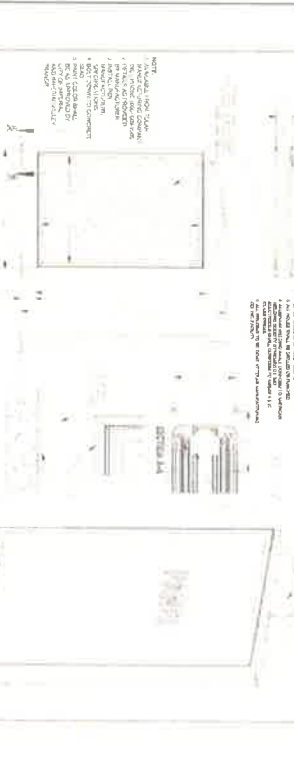
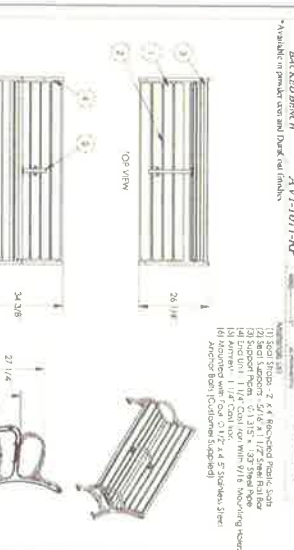
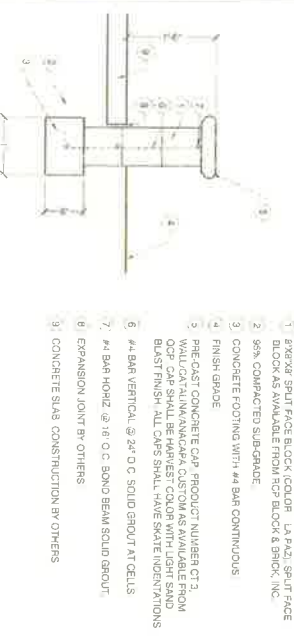

6 SEATWALL

NOTE:
 1. BRIDGE SPURT FACE BLOCK (COLOR - 1/4\"/>

7 BACKED BENCH

NOTE:
 1. ALL MATERIAL FROM OLYMPIC FOUNDRY, INC. CONTACT: (800) 878-1441
 2. ALL MATERIAL FROM MANUFACTURERS SPECIFICATIONS
 3. COLOR AND FINISH SHALL BE APPROVED BY THE CITY OF IMPERIAL PRIOR TO ORDERING

10 INFORMATION KIOSK

NOTE:
 1. ALL MATERIAL FROM OLYMPIC FOUNDRY, INC. CONTACT: (800) 878-1441
 2. ALL MATERIAL FROM MANUFACTURERS SPECIFICATIONS
 3. COLOR AND FINISH SHALL BE APPROVED BY THE CITY OF IMPERIAL PRIOR TO ORDERING

TESHIMA DESIGN GROUP
 LANDSCAPE ARCHITECTURE AND PLANNING
 1000 S. MICHIGAN AVE. SUITE 200
 ANAHEIM, CA 92805
 TEL: 714.771.1111 FAX: 714.771.1112
 WWW.TESHIMADG.COM

DATE: 2-2-18

PROJECT NO: 15-07

DATE: 2-2-18

PSOMAS
 401 E. STREET, SUITE 1500
 92501 P.O. BOX 37018
 95117 (916) 991-2352
 WWW.PSOMAS.COM

CITY OF IMPERIAL
 420 South Imperial Avenue
 Imperial, CA 92225
 Ph: (760) 355-3840 • Fax: (760)355-4718

COMMUNITY DEVELOPMENT DEPARTMENT

HARDCAPE DETAILS

IMPERIAL TRANSIT PARK

SHEET **13** OF **30** SHEETS

DATE: 09/31/2017

L-5

City of Imperial
Custom Peak Solar LED Bus Shelter

15'

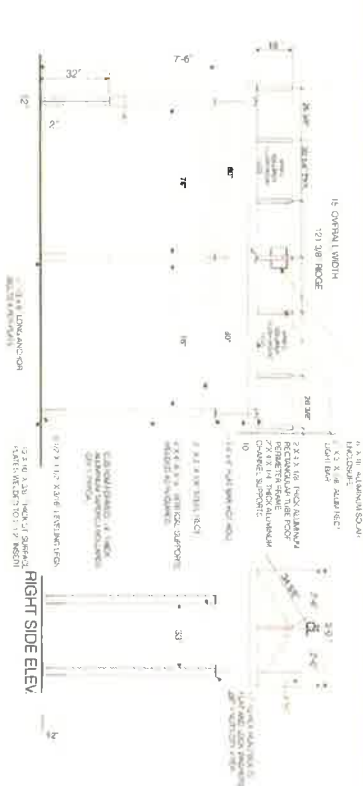
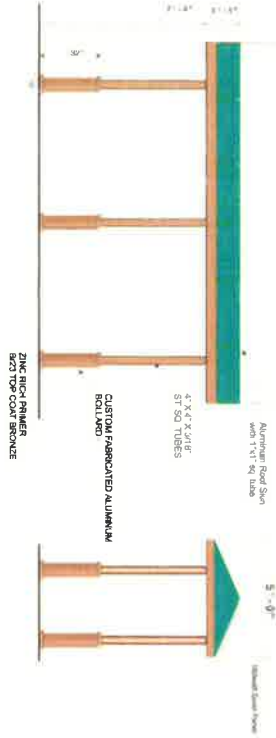

8

BUS SHELTER

TESHIMA DESIGN GROUP
LANDSCAPE ARCHITECTURE • LAND PLANNING
3000 S. MICHIGAN AVE. SUITE 200
SAN DIEGO, CA 92108
TEL: 619.591.1100 FAX: 619.591.1101
WWW.TESHIMADG.COM

PSOMAS
SAN DIEGO, CA 92108
(619) 591-7800 (619) 961-2392 fax
www.psomas.com

UNAPPROVED CHANGES & USES: The engineer preparing these plans will not be responsible for or liable for any changes to or uses of these plans, or any consequences that may result therefrom, unless approved by the engineer of these plans.

CITY OF IMPERIAL
420 South Imperial Avenue
Imperial, CA 92221
Ph: (760) 355-3840 • Fax: (760) 355-4718



COMMUNITY DEVELOPMENT DEPARTMENT

IMPERIAL TRANSIT PARK

SHEET **14** OF 30 SHEETS

L-6

City of Imperial
Custom 30th Peak x 8ft Walking Path Shade Shelter

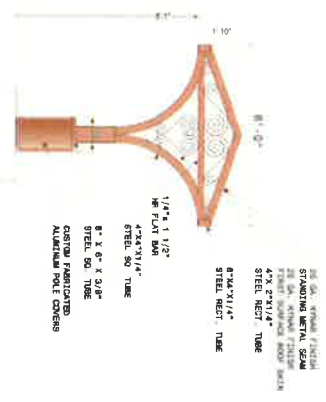
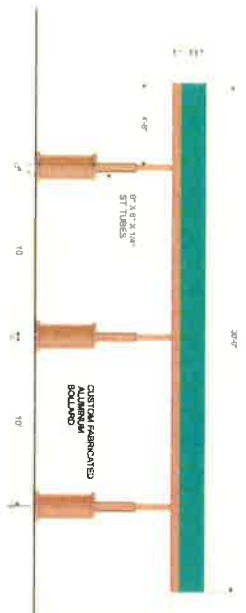

ZINC RICH PRIMER B23 TOP COAT

DATE: 09/21/2017
SCALE: 1/4" = 1'-0"

PROJECT: CUSTOM 30TH PEAK X 8FT WALKING PATH SHADE SHELTER
SHEET: 15 OF 30

ZINC RICH PRIMER B23 TOP COAT

DATE: 09/21/2017
SCALE: 1/4" = 1'-0"

PROJECT: CUSTOM 30TH PEAK X 8FT WALKING PATH SHADE SHELTER
SHEET: 15 OF 30

NOTE: STRUCTURAL ROOF



ZINC RICH PRIMER B23 TOP COAT

DATE: 09/21/2017
SCALE: 1/4" = 1'-0"

PROJECT: CUSTOM 30TH PEAK X 8FT WALKING PATH SHADE SHELTER
SHEET: 15 OF 30

SHADE STRUCTURE

9

TESHIMA DESIGN GROUP
ARCHITECTURE, INTERIOR DESIGN, LAND PLANNING
1001 JOB NO. 15-07 DATE: 1-1-18

UNAPPROVED CHANGES & USES: The engineer accepting these plans will not be responsible for or liable for any changes to the plans, such as in writing and shall be approved by the proprietor of these plans.

PSOMAS
401 B Street, Suite 1600
San Diego, CA 92101
(619) 581-2342 fax
www.psomas.com



CITY OF IMPERIAL
420 South Imperial Avenue
Imperial, CA 92251
Ph: (760) 355-3840 • Fax: (760)355-4718

COMMUNITY DEVELOPMENT DEPARTMENT

HARDSCAPE DETAILS
IMPERIAL TRANSIT PARK

SHEET **15**
OF 30 SHEETS

L-7

DATE: 09/21/2017

NOTES:
1. ALL FABRICATED METAL SHALL BE GALVALUME OR GALVALUME WITH ZINC RICH PRIMER B23 TOP COAT.
2. ALL FABRICATED METAL SHALL BE GALVALUME OR GALVALUME WITH ZINC RICH PRIMER B23 TOP COAT.
3. ALL FABRICATED METAL SHALL BE GALVALUME OR GALVALUME WITH ZINC RICH PRIMER B23 TOP COAT.
4. ALL FABRICATED METAL SHALL BE GALVALUME OR GALVALUME WITH ZINC RICH PRIMER B23 TOP COAT.
5. ALL FABRICATED METAL SHALL BE GALVALUME OR GALVALUME WITH ZINC RICH PRIMER B23 TOP COAT.
6. ALL FABRICATED METAL SHALL BE GALVALUME OR GALVALUME WITH ZINC RICH PRIMER B23 TOP COAT.
7. ALL FABRICATED METAL SHALL BE GALVALUME OR GALVALUME WITH ZINC RICH PRIMER B23 TOP COAT.
8. ALL FABRICATED METAL SHALL BE GALVALUME OR GALVALUME WITH ZINC RICH PRIMER B23 TOP COAT.
9. ALL FABRICATED METAL SHALL BE GALVALUME OR GALVALUME WITH ZINC RICH PRIMER B23 TOP COAT.

MATCHLINE SEE SHEET L-9

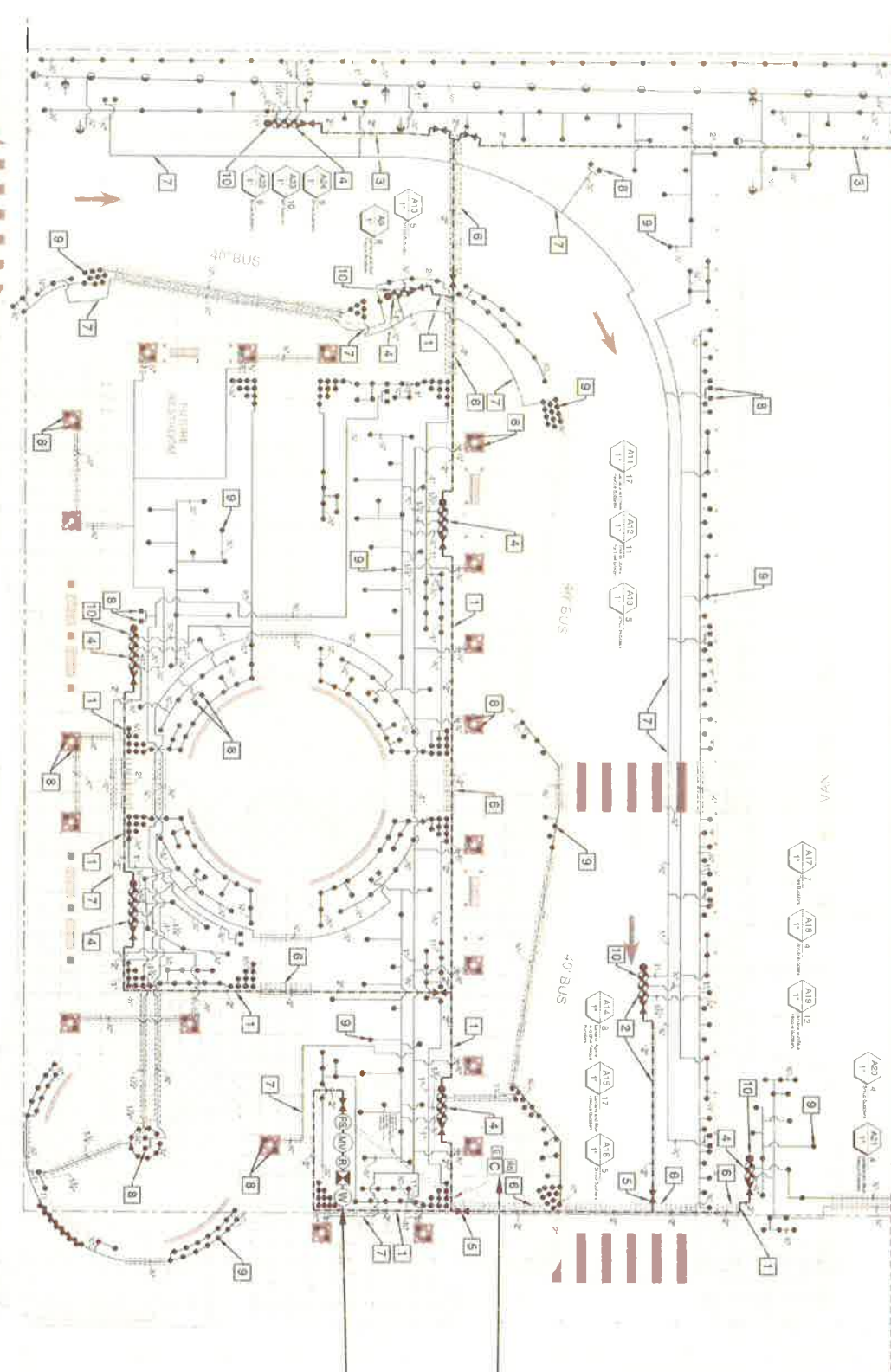

IRRIGATION SCHEDULE

1. Irrigation schedule of the system is as follows:
2. Mainline and front control valve stations in landscape for daily only. Front control valve stations in landscape for daily only. Front control valve stations in landscape for daily only.
3. Front control valve stations in landscape for daily only. Front control valve stations in landscape for daily only.
4. Front control valve stations in landscape for daily only. Front control valve stations in landscape for daily only.
5. Front control valve stations in landscape for daily only. Front control valve stations in landscape for daily only.
6. Front control valve stations in landscape for daily only. Front control valve stations in landscape for daily only.
7. Front control valve stations in landscape for daily only. Front control valve stations in landscape for daily only.
8. Front control valve stations in landscape for daily only. Front control valve stations in landscape for daily only.
9. Front control valve stations in landscape for daily only. Front control valve stations in landscape for daily only.
10. Front control valve stations in landscape for daily only. Front control valve stations in landscape for daily only.

IRRIGATION CONTROLLER

CONTRACTOR SHALL INSTALL 1" METAL CONDUIT FOR ALL IRRIGATION CONTROLLER WIRING. THE CONTRACTOR SHALL INSTALL AN IRRIGATION CONTROLLER AND WIRING TO CONTROL ALL IRRIGATION SYSTEMS. THE CONTRACTOR SHALL INSTALL AN IRRIGATION CONTROLLER AND WIRING TO CONTROL ALL IRRIGATION SYSTEMS. THE CONTRACTOR SHALL INSTALL AN IRRIGATION CONTROLLER AND WIRING TO CONTROL ALL IRRIGATION SYSTEMS.

POINT OF CONNECTION INFORMATION

Point of Connection	Notes
1. Mainline	1. Mainline
2. Front control valve	2. Front control valve
3. Front control valve	3. Front control valve
4. Front control valve	4. Front control valve
5. Front control valve	5. Front control valve
6. Front control valve	6. Front control valve
7. Front control valve	7. Front control valve
8. Front control valve	8. Front control valve
9. Front control valve	9. Front control valve
10. Front control valve	10. Front control valve

SEE SHEET L-10 FOR IRRIGATION LEGEND
SEE SHEET L-9 FOR IRRIGATION NOTES
SEE SHEET L-11, L-12 AND L-13 FOR DETAILS



TESHIMA DESIGN GROUP
ARCHITECTS
1000 B STREET, SUITE 100
IMPERIAL, CA 92251
TEL: (760) 355-3940
WWW.TESHIMADSG.COM

DATE: 2-2-18
JOB NO. L-8

PSOMAS
401 B STREET, SUITE 100
IMPERIAL, CA 92251
TEL: (760) 355-3940
WWW.PSOMAS.COM

BARIONI
BOULEVARD

CITY OF IMPERIAL
420 South Imperial Avenue
Imperial, CA 92251
Ph: (760) 355-3940 • Fax: (760) 355-4718

COMMUNITY DEVELOPMENT DEPARTMENT
IRRIGATION PLAN AND SCHEDULE
IMPERIAL TRANSIT PARK

SHEET 16
30
DATE: 09/21/2017
L-8

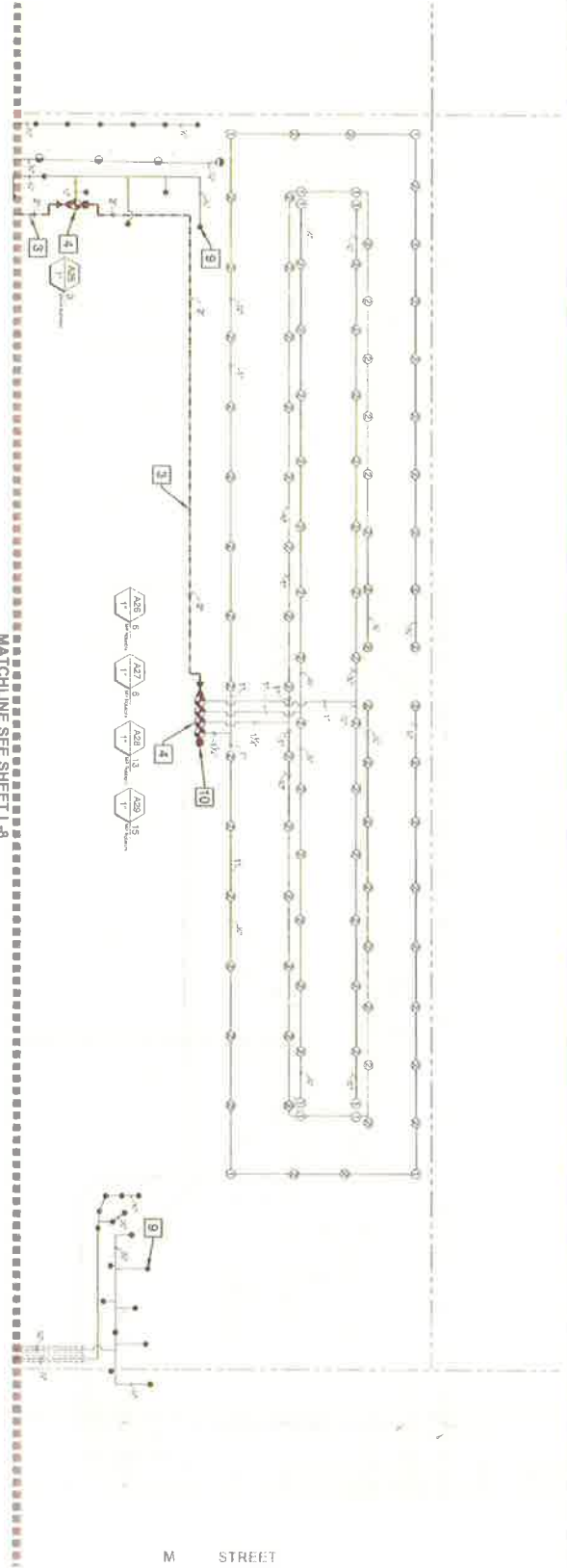

MATCHLINE SEE SHEET L-8

IRRIGATION NOTES

1. ALL LOCAL MUNICIPAL AND STATE LAWS, RULES AND REGULATIONS GOVERNING OR AFFECTING THE DESIGN AND INSTALLATION OF IRRIGATION SYSTEMS SHALL BE COMPLIED WITH AND MADE A PART OF THESE SPECIFICATIONS AND THEIR PROVISIONS SHALL BE CARRIED OUT BY THE CONTRACTOR.
2. THE CONTRACTOR SHALL VERIFY THE LOCATION OF ALL EXISTING UTILITIES OR SERVICES, INCLUDING BUT NOT LIMITED TO WATER, GAS, ELECTRIC, TELEPHONE, CABLE, AND OTHER SERVICES, PRIOR TO THE COMMENCEMENT OF ANY WORK. THE CONTRACTOR SHALL BE RESPONSIBLE FOR OBTAINING ALL NECESSARY PERMITS AND APPROVALS FROM THE CITY OF IMPERIAL AND THE CALIFORNIA DEPARTMENT OF WATER RESOURCES PRIOR TO THE COMMENCEMENT OF ANY WORK. THE CONTRACTOR SHALL BE RESPONSIBLE FOR OBTAINING ALL NECESSARY PERMITS AND APPROVALS FROM THE CITY OF IMPERIAL AND THE CALIFORNIA DEPARTMENT OF WATER RESOURCES PRIOR TO THE COMMENCEMENT OF ANY WORK.
3. THE CONTRACTOR SHALL VERIFY THE LOCATION OF ALL EXISTING UTILITIES OR SERVICES, INCLUDING BUT NOT LIMITED TO WATER, GAS, ELECTRIC, TELEPHONE, CABLE, AND OTHER SERVICES, PRIOR TO THE COMMENCEMENT OF ANY WORK. THE CONTRACTOR SHALL BE RESPONSIBLE FOR OBTAINING ALL NECESSARY PERMITS AND APPROVALS FROM THE CITY OF IMPERIAL AND THE CALIFORNIA DEPARTMENT OF WATER RESOURCES PRIOR TO THE COMMENCEMENT OF ANY WORK.
4. CONTRACTOR SHALL COORDINATE ALL IRRIGATION LINES AND CONTROL SYSTEMS WITH PROPOSED LOCATIONS OF PLANT MATERIAL AND ROOT BARRIERS PRIOR TO INSTALLATION. ALL IRRIGATION SYSTEMS SHALL BE COMPLETED AND INSTALLED PRIOR TO THE INSTALLATION OF ANY FINISHING OR PLANTING. PROVISIONS OF THIS SPECIFICATION SHALL BE CARRIED OUT BY THE CONTRACTOR.
5. THIS DESIGN IS DIAGRAMMATIC. ALL EQUIPMENT, SHOWING AND FIELD AREAS IS FOR DESIGN CLARITY ONLY AND IS TO BE INSTALLED WITHIN PLANTING AREAS AS NECESSARY.
6. DO NOT UNDERTAKE ANY CONSTRUCTION OR INSTALLATION OF ANY EQUIPMENT OR MATERIALS AT ANY LOCATION PRIOR TO THE APPROVAL OF THE CONTRACTOR. ALL CONSTRUCTION SHALL BE BROUGHT TO THE CONTRACTOR'S ATTENTION AND APPROVED PRIOR TO ANY WORK ON THE PROJECT. ANY CHANGES REQUIRED NECESSARY BY THE OWNER SHALL BE APPROVED BY THE CONTRACTOR AND SHOWN IN THE DETAILS AND SPECIFICATIONS.
7. CONTRACTOR SHALL BE RESPONSIBLE TO COMPLY WITH CITY OF IMPERIAL, COUNTY AND STATE REQUIREMENTS FOR SOFT EQUIPMENT AND INSTALLATION.
8. ALL LATERALS, MAINLINE AND WHEEL UNITS REQUIRING SAVED AREAS TO BE MAINTAINED SHALL BE INSTALLED WITHIN THE PLANTING AREAS. ALL LATERALS, MAINLINE AND WHEEL UNITS REQUIRING SAVED AREAS TO BE MAINTAINED SHALL BE INSTALLED WITHIN THE PLANTING AREAS. ALL LATERALS, MAINLINE AND WHEEL UNITS REQUIRING SAVED AREAS TO BE MAINTAINED SHALL BE INSTALLED WITHIN THE PLANTING AREAS.
9. ALL LATERALS, MAINLINE AND WHEEL UNITS REQUIRING SAVED AREAS TO BE MAINTAINED SHALL BE INSTALLED WITHIN THE PLANTING AREAS. ALL LATERALS, MAINLINE AND WHEEL UNITS REQUIRING SAVED AREAS TO BE MAINTAINED SHALL BE INSTALLED WITHIN THE PLANTING AREAS.
10. ALL LATERALS, MAINLINE AND WHEEL UNITS REQUIRING SAVED AREAS TO BE MAINTAINED SHALL BE INSTALLED WITHIN THE PLANTING AREAS. ALL LATERALS, MAINLINE AND WHEEL UNITS REQUIRING SAVED AREAS TO BE MAINTAINED SHALL BE INSTALLED WITHIN THE PLANTING AREAS.
11. PROVIDE CLEAN SAND BEDDING AND BACKFILL FOR PRESSURE MAINLINE PIPE 2 IN. BELOW AND 6 IN. ABOVE PIPE BANKTOP.
12. IRRIGATION SYSTEMS ARE TO BE INSTALLED AS SHOWN ON THE PLANS & SPECIFICATIONS WITH THE EXCEPTION OF ANY CHANGES MADE BY THE CONTRACTOR. ALL CHANGES SHALL BE APPROVED BY THE CITY OF IMPERIAL AND THE CALIFORNIA DEPARTMENT OF WATER RESOURCES PRIOR TO THE COMMENCEMENT OF ANY WORK.
13. USE VARIABLE AND NOZZLES AS REQUIRED TO ACHIEVE COMPLETE COVERAGE WITH MINIMAL OVERSPRAY.
14. SYSTEMS ARE DESIGNED FOR A MAXIMUM OF 30 PSI FOR SPRINKLER HEADS.
15. ALL LATERAL END HUBS SHALL BE 2" x 4" SCH. 40 UNLESS OTHERWISE NOTED.
16. ALL WASTE CONTROL VALVES SHALL BE INSTALLED IN WASTE DOWNS. ONE VALVE SHALL BE INSTALLED AT EACH WASTE DOWN. ALL WASTE CONTROL VALVES SHALL BE INSTALLED IN WASTE DOWNS. ONE VALVE SHALL BE INSTALLED AT EACH WASTE DOWN.
17. CHECK VALVES SHALL BE INSTALLED AS REQUIRED TO PREVENT ALL LOW HEAD DRAINAGE.
18. CONTRACTOR SHALL VERIFY THAT THERE IS ADEQUATE PRESSURE AVAILABLE AT THE SITE FOR THE IRRIGATION SYSTEM TO WORK PROPERLY. THE CONTRACTOR SHALL BE RESPONSIBLE FOR OBTAINING ALL NECESSARY PERMITS AND APPROVALS FROM THE CITY OF IMPERIAL AND THE CALIFORNIA DEPARTMENT OF WATER RESOURCES PRIOR TO THE COMMENCEMENT OF ANY WORK.
19. PROVIDE 2" TWO EXTRA CONTROL WIRES AND 1" EXTRA COMMON WIRE TO EACH END OF THE MAINLINE AND 6" TOTAL INSTALL WIRES WITH WATER TIGHT END CAPS AND END CAPS SHALL BE INSTALLED AT EACH END OF THE MAINLINE AND 6" TOTAL INSTALL WIRES WITH WATER TIGHT END CAPS AND END CAPS SHALL BE INSTALLED AT EACH END OF THE MAINLINE.

SEE SHEET L-10 FOR IRRIGATION LEGEND
SEE SHEET L-8 FOR IRRIGATION SCHEDULE
SEE SHEET L-11, L-12 AND L-13 FOR DETAILS

TESHIMA DESIGN GROUP
LANDSCAPE ARCHITECTURE & CIVIL ENGINEERING
1000 S. MICHIGAN AVE. SUITE 100
IMPERIAL, CA 92251
TEL: (760) 355-4718
FAX: (760) 355-4719
WWW.TESHIMADG.COM

PROJECT NO. 17-001
DATE: 04/25/2017

PSOMAS
401 B Street, Suite 1000
Imperial, CA 92251
(819) 951-2300 (819) 951-2321
www.psomas.com



CITY OF IMPERIAL
420 South Imperial Avenue
Imperial, CA 92251
Ph: (760) 355-3840 • Fax: (760)355-4718

COMMUNITY DEVELOPMENT DEPARTMENT

IRRIGATION PLAN AND NOTES
IMPERIAL TRANSIT PARK

SHEET **17** OF **30**
DATE: 04/25/2017

EQUIPMENT LEGEND

SYMBOL	DESCRIPTION	MANUF.	MODEL	SIZE	NOTES
W	Pressure Filter Backwash				By vendor's Spec. Civil Engineer's Drawings. Model where shown. Note any.
X	Backwash Pressure				Check manufacturer's literature for proper operation. Do not exceed manufacturer's recommended backwash pressure. Backwash pressure should be maintained at or below the recommended backwash pressure.
+	Pressure Control Valve				Install on water control valve in per. Ducts, B and C.
W	Pressure Reducing Valve	Waters	100 Series	1 1/2"	Install on water control valve in per. Ducts, B and C.
C	Control Valve	Tuohet	16200 Series	1 1/2"	Install on water control valve in per. Ducts, B and C.
F	Flow Meter	Dana	100 Series	1 1/2"	Data indicates flow sensor as manufactured by Dana. Flow sensor value at the controller. Control valve representative or additional information. Flow sensor representative or additional information. Flow sensor representative or additional information. Flow sensor representative or additional information.
Q	Flow Control	Flow Control	1 1/2"	1 1/2"	Install in 12" diameter. Install in 12" diameter. Install in 12" diameter. Install in 12" diameter.
Q	Flow Control	Flow Control	1 1/2"	1 1/2"	Install in 12" diameter. Install in 12" diameter. Install in 12" diameter. Install in 12" diameter.
Q	Flow Control	Flow Control	1 1/2"	1 1/2"	Install in 12" diameter. Install in 12" diameter. Install in 12" diameter. Install in 12" diameter.
Q	Flow Control	Flow Control	1 1/2"	1 1/2"	Install in 12" diameter. Install in 12" diameter. Install in 12" diameter. Install in 12" diameter.
Q	Flow Control	Flow Control	1 1/2"	1 1/2"	Install in 12" diameter. Install in 12" diameter. Install in 12" diameter. Install in 12" diameter.

NOTE: ALL SHOWN ITEMS ARE TO BE PROVIDED WITH IN-PIPE CHECK VALVES. ALL IN-PIPE CHECK VALVES TO BE EQUIPPED WITH A LANSBERRY AREA WITHOUT CHECK VALVES. CHECK VALVES TO BE PROVIDED TO PROTECT EACH CONTROL TO THE LANDSCAPE AREA WITHOUT CHECK VALVES. CHECK VALVES TO BE PROVIDED TO PROTECT EACH CONTROL TO THE LANDSCAPE AREA WITHOUT CHECK VALVES.

IMPORTANT NOTE: ALL SHOWN ITEMS ARE TO BE PROVIDED WITH IN-PIPE CHECK VALVES. ALL IN-PIPE CHECK VALVES TO BE EQUIPPED WITH A LANSBERRY AREA WITHOUT CHECK VALVES. CHECK VALVES TO BE PROVIDED TO PROTECT EACH CONTROL TO THE LANDSCAPE AREA WITHOUT CHECK VALVES.



TESHIMA DESIGN GROUP
7700 JOEL NO. 1547
DAYS 2-3-18

DESIGNED BY: TESHIMA DESIGN GROUP
CHECKED BY: TESHIMA DESIGN GROUP
DATE: 09/21/2017

PSOMAS
421 B Street, Suite 1100
Imperial, CA 92251
Phone: (760) 355-4718
Fax: (760) 355-4718

IRRIGATION LEGEND

SYMBOL	DESCRIPTION	MANUF.	MODEL	SIZE	NOTES
+	Flow Meter				Install on water control valve in per. Ducts, B and C.
+	Flow Meter				Install on water control valve in per. Ducts, B and C.
+	Flow Meter				Install on water control valve in per. Ducts, B and C.

PRESSURE CALCULATIONS

Pressure Calculations Table with columns for Pipe Size, Length, Friction Loss, etc.

WATER USE CALCULATIONS

MAXIMUM APPLIED WATER ALLOWANCE CALCULATION - MAWA

ESTIMATED TOTAL WATER USE CALCULATION - ETWU

CONCLUSION

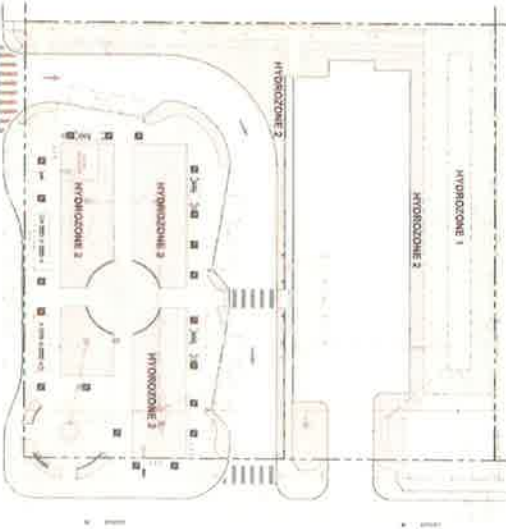

LEGEND

SYMBOL	DESCRIPTION
Hydrizone 1	Hydrizone 1
Hydrizone 2	Hydrizone 2
Hydrizone 3	Hydrizone 3

WATER USE CALCULATION

CITY OF IMPERIAL
420 South Imperial Avenue
Imperial, CA 92251
Ph: (760) 355-3840 • Fax: (760) 355-4718

COMMUNITY DEVELOPMENT DEPARTMENT
IMPERIAL TRANSIT PARK
DATE: 09/21/2017

SHEET **18** OF 30 SHEETS

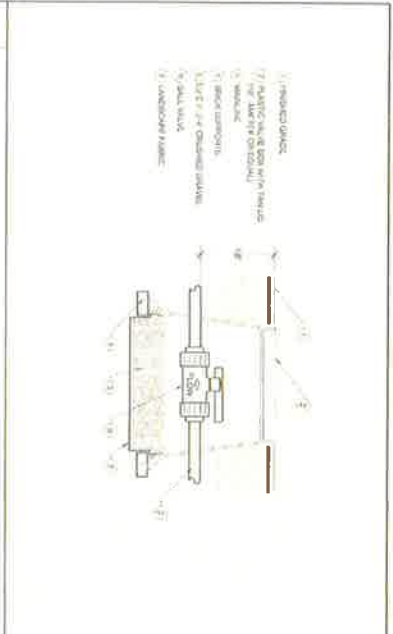

A BALL VALVE
NOT TO SCALE

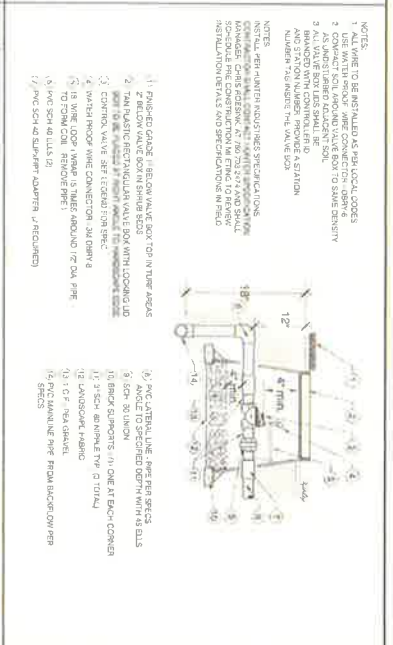

B MASTER/REMOTE CONTROL VALVE
NOT TO SCALE

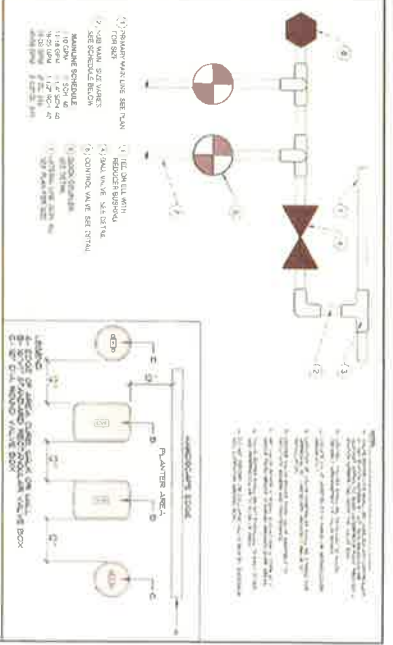

C VALVE MANIFOLD INSTALLATION (TYPICAL)
NOT TO SCALE

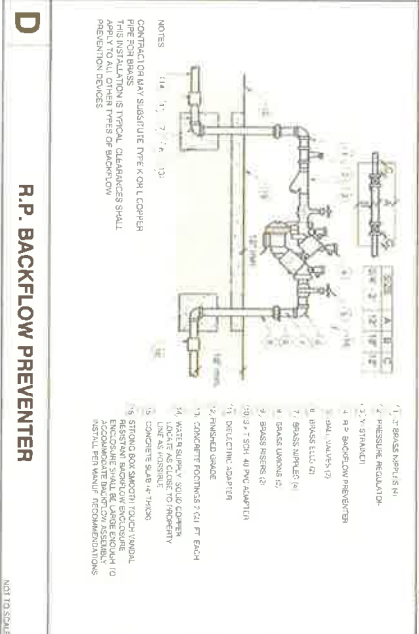

D R.P. BACKFLOW PREVENTER
NOT TO SCALE

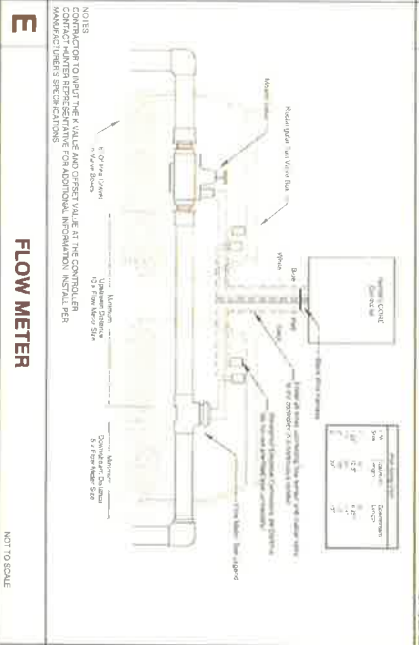

E FLOW METER
NOT TO SCALE

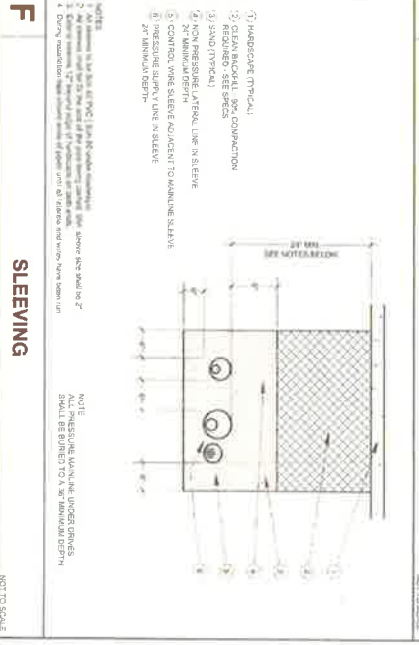

F SLEEVING
NOT TO SCALE

TESTIMA DESIGN GROUP
1000 S. GARDEN AVENUE, SUITE 100
GARDEN GROVE, CA 92640
TEL: 714.942.1100
WWW.TESTIMADSG.COM

TESTIMA DESIGN GROUP
1000 S. GARDEN AVENUE, SUITE 100
GARDEN GROVE, CA 92640
TEL: 714.942.1100
WWW.TESTIMADSG.COM

DATE: 2-2-08

APPROVED: [Signature]

DESIGNED: [Signature]

DATE: 2-2-08

TESTIMADSG.COM

1000 S. GARDEN AVENUE, SUITE 100
GARDEN GROVE, CA 92640
TEL: 714.942.1100
WWW.TESTIMADSG.COM

PSOMAS
401 B Street, Suite 1000
Imperial, CA 92251
Tel: 760.355.3840
Fax: 760.355.4718

CITY OF IMPERIAL
420 South Imperial Avenue
Imperial, CA 92251
Ph: (760) 355-3840 • Fax: (760)355-4718

COMMUNITY DEVELOPMENT DEPARTMENT

IRRIGATION DETAILS

IMPERIAL TRANSIT PARK

SHEET **19**

OF **30** SHEETS

L-11

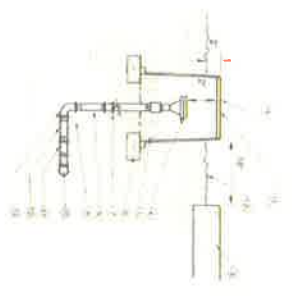

1. STAINLESS STEEL ENCLOSURE SEE LISTING
2. 1/2" CONNECTION CONDUIT
3. CONTINUOUS SET LEADING AND PIPING FOR MANUFACTURE AND TYPE
4. ANCHOR BOLTS IN MOUNTING BRACKET BOARDS SHOULD BE CHECKED
5. INSIDE BRACKET'S ATTACH POINTS TO BRACKET'S WITH CONNECTION BOLTS
6. 1/2" CONNECTION CONDUIT
7. 2" SCH 40 GALV FLUID TIGHT CONDUIT
8. COMPACTLY CONDUIT
9. FISH-GUARD
10. PULL BOX
11. 90 DEG SWEEP ELB
12. 1/2" SCH 40 GALV CONDUIT
13. 1/2" SCH 40 GALV CONDUIT

NOTE: INSTALL WITH WATER RESISTING SEPARATIONS. VERIFY ALL CONNECTIONS TO BE MADE TO THE ENCLOSURE. VERIFY ALL CONNECTIONS TO BE MADE TO THE ENCLOSURE. VERIFY ALL CONNECTIONS TO BE MADE TO THE ENCLOSURE.



1. MODEL SQUARE SENSING SENSOR
2. METAL POLE MOUNTING IN LOCATION WHERE SENSOR CAN RECEIVE FULL SUN IS BEST TO RECEIVE SIGNAL
3. CONDUIT FOR SOLAR SENSING COMMUNICATION
4. MOUNTING BRACKET
5. COMMUNICATION WIRE IS 18 GAUGE TYPE TO MEET INSTALLATION CODE REQUIREMENTS
6. POWER SOURCE

NOTE: INSTALL WITH WATER RESISTING SEPARATIONS. VERIFY ALL CONNECTIONS TO BE MADE TO THE ENCLOSURE. VERIFY ALL CONNECTIONS TO BE MADE TO THE ENCLOSURE. VERIFY ALL CONNECTIONS TO BE MADE TO THE ENCLOSURE.

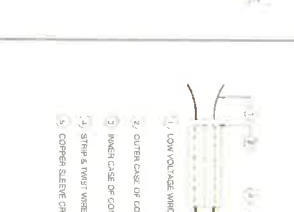

1. LOW VOLTAGE WIRE 2 AWG
2. CUTTER/CABLE CUT CONNECTOR
3. STRIP 5 WIRES FOR INSUR CONNECTION
4. COPPER SLEEVE CHAMP INSTALLED IN RECOMMENDED TOOL NOT TO SCALE

NOTE: MAKE PER MANUFACTURER'S SPECIFICATIONS. USE ONLY 20 GAUGE WIRE. MAKE PER MANUFACTURER'S SPECIFICATIONS. USE ONLY 20 GAUGE WIRE. MAKE PER MANUFACTURER'S SPECIFICATIONS. USE ONLY 20 GAUGE WIRE.

G QUICK COUPLER

NOT TO SCALE

H TRENCHING

NOT TO SCALE

I WIRE CONNECTOR

NOT TO SCALE

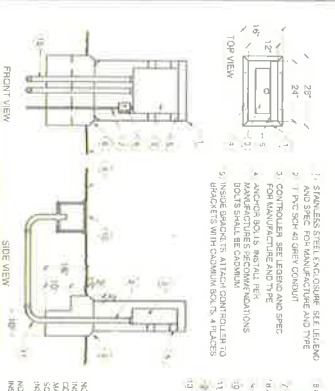

1. STAINLESS STEEL ENCLOSURE SEE LISTING
2. 1/2" CONNECTION CONDUIT
3. CONTINUOUS SET LEADING AND PIPING FOR MANUFACTURE AND TYPE
4. ANCHOR BOLTS IN MOUNTING BRACKET BOARDS SHOULD BE CHECKED
5. INSIDE BRACKET'S ATTACH POINTS TO BRACKET'S WITH CONNECTION BOLTS
6. 1/2" CONNECTION CONDUIT
7. 2" SCH 40 GALV FLUID TIGHT CONDUIT
8. COMPACTLY CONDUIT
9. FISH-GUARD
10. PULL BOX
11. 90 DEG SWEEP ELB
12. 1/2" SCH 40 GALV CONDUIT
13. 1/2" SCH 40 GALV CONDUIT

NOTE: INSTALL WITH WATER RESISTING SEPARATIONS. VERIFY ALL CONNECTIONS TO BE MADE TO THE ENCLOSURE. VERIFY ALL CONNECTIONS TO BE MADE TO THE ENCLOSURE. VERIFY ALL CONNECTIONS TO BE MADE TO THE ENCLOSURE.

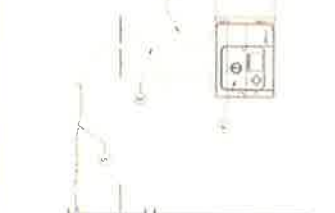

1. MODEL SQUARE SENSING SENSOR
2. METAL POLE MOUNTING IN LOCATION WHERE SENSOR CAN RECEIVE FULL SUN IS BEST TO RECEIVE SIGNAL
3. CONDUIT FOR SOLAR SENSING COMMUNICATION
4. MOUNTING BRACKET
5. COMMUNICATION WIRE IS 18 GAUGE TYPE TO MEET INSTALLATION CODE REQUIREMENTS
6. POWER SOURCE

NOTE: INSTALL WITH WATER RESISTING SEPARATIONS. VERIFY ALL CONNECTIONS TO BE MADE TO THE ENCLOSURE. VERIFY ALL CONNECTIONS TO BE MADE TO THE ENCLOSURE. VERIFY ALL CONNECTIONS TO BE MADE TO THE ENCLOSURE.

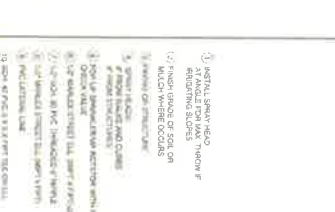

1. METAL SPRAY HEAD VIEW FROM ABOVE
2. 1/2" SCH 40 GALV FLUID TIGHT CONDUIT
3. 1/2" SCH 40 GALV FLUID TIGHT CONDUIT
4. 1/2" SCH 40 GALV FLUID TIGHT CONDUIT
5. 1/2" SCH 40 GALV FLUID TIGHT CONDUIT
6. 1/2" SCH 40 GALV FLUID TIGHT CONDUIT
7. 1/2" SCH 40 GALV FLUID TIGHT CONDUIT
8. 1/2" SCH 40 GALV FLUID TIGHT CONDUIT
9. 1/2" SCH 40 GALV FLUID TIGHT CONDUIT
10. 1/2" SCH 40 GALV FLUID TIGHT CONDUIT
11. 1/2" SCH 40 GALV FLUID TIGHT CONDUIT
12. 1/2" SCH 40 GALV FLUID TIGHT CONDUIT
13. 1/2" SCH 40 GALV FLUID TIGHT CONDUIT
14. 1/2" SCH 40 GALV FLUID TIGHT CONDUIT
15. 1/2" SCH 40 GALV FLUID TIGHT CONDUIT
16. 1/2" SCH 40 GALV FLUID TIGHT CONDUIT
17. 1/2" SCH 40 GALV FLUID TIGHT CONDUIT
18. 1/2" SCH 40 GALV FLUID TIGHT CONDUIT
19. 1/2" SCH 40 GALV FLUID TIGHT CONDUIT
20. 1/2" SCH 40 GALV FLUID TIGHT CONDUIT

NOTE: INSTALL WITH WATER RESISTING SEPARATIONS. VERIFY ALL CONNECTIONS TO BE MADE TO THE ENCLOSURE. VERIFY ALL CONNECTIONS TO BE MADE TO THE ENCLOSURE. VERIFY ALL CONNECTIONS TO BE MADE TO THE ENCLOSURE.

J IRRIGATION CONTROLLER IN ENCLOSURE

NOT TO SCALE

K RAIN SENSOR MOUNTING DETAIL

NOT TO SCALE

L POP-UP SPRAY HEAD

NOT TO SCALE

TESHIMA DESIGN GROUP
 1000 N. 10th St., Suite 100
 Phoenix, AZ 85016
 Phone: (602) 955-2800
 Fax: (602) 955-2801
 Website: www.teshimadesign.com

DATE: 2-2-8

PROJECT: IRRIGATION DETAILS
SHEET: 20
OF: 30

PSOMAS
 1000 N. 10th St., Suite 100
 Phoenix, AZ 85016
 Phone: (602) 955-2800
 Fax: (602) 955-2801
 Website: www.psomas.com

CITY OF IMPERIAL
 420 South Imperial Avenue
 Imperial, CA 92251
 Ph: (760) 355-3840 • Fax: (760) 355-4718

COMMUNITY DEVELOPMENT DEPARTMENT
 IRRIGATION DETAILS
 IMPERIAL TRANSIT PARK

DATE: 02/21/2017

SHEET 20
OF 30
SHEETS

1. TREE OR SHRUB BUBBLER BALL
2. BRASS END ASSEMBLY TO FIT TOE OF BUBBLER BALL
3. TREE AND SHRUB BUBBLER BALL SET FOR SPRAY AND BUBBLER BALL
4. TREE AND SHRUB BUBBLER BALL SET FOR SPRAY AND BUBBLER BALL
5. TREE AND SHRUB BUBBLER BALL SET FOR SPRAY AND BUBBLER BALL
6. 2" LAYER OF BIOCOMPOST DEBRIS

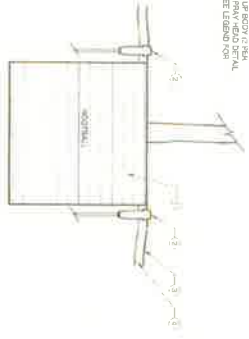

M TREE AND SHRUB BUBBLER INSTALLATION

TESHIMA DESIGN GROUP
 ARCHITECTURE, INTERIOR DESIGN, LANDSCAPE ARCHITECTURE, LAND PLANNING
 1000 S. GARDEN AVENUE, SUITE 100, ANAHEIM, CA 92805
 TEL: (714) 771-1111 FAX: (714) 771-1112
 WWW.TESHIMADG.COM

NO.	REVISION	APPROVAL	DATE

PSOMAS
 401 S. Street, Suite 1000
 Pomona, CA 92670
 (951) 861-2200
 (951) 861-2202 Fax



CITY OF IMPERIAL
 420 South Imperial Avenue
 Imperial, CA 92251
 Ph: (760) 365-3840 • Fax: (760) 365-4718

COMMUNITY DEVELOPMENT DEPARTMENT

IRRIGATION DETAILS
IMPERIAL TRANSIT PARK

L-13
 SHEET **21**
 OF **30** SHEETS

DATE: 09/31/2017

MATCHLINE SEE SHEET L-15

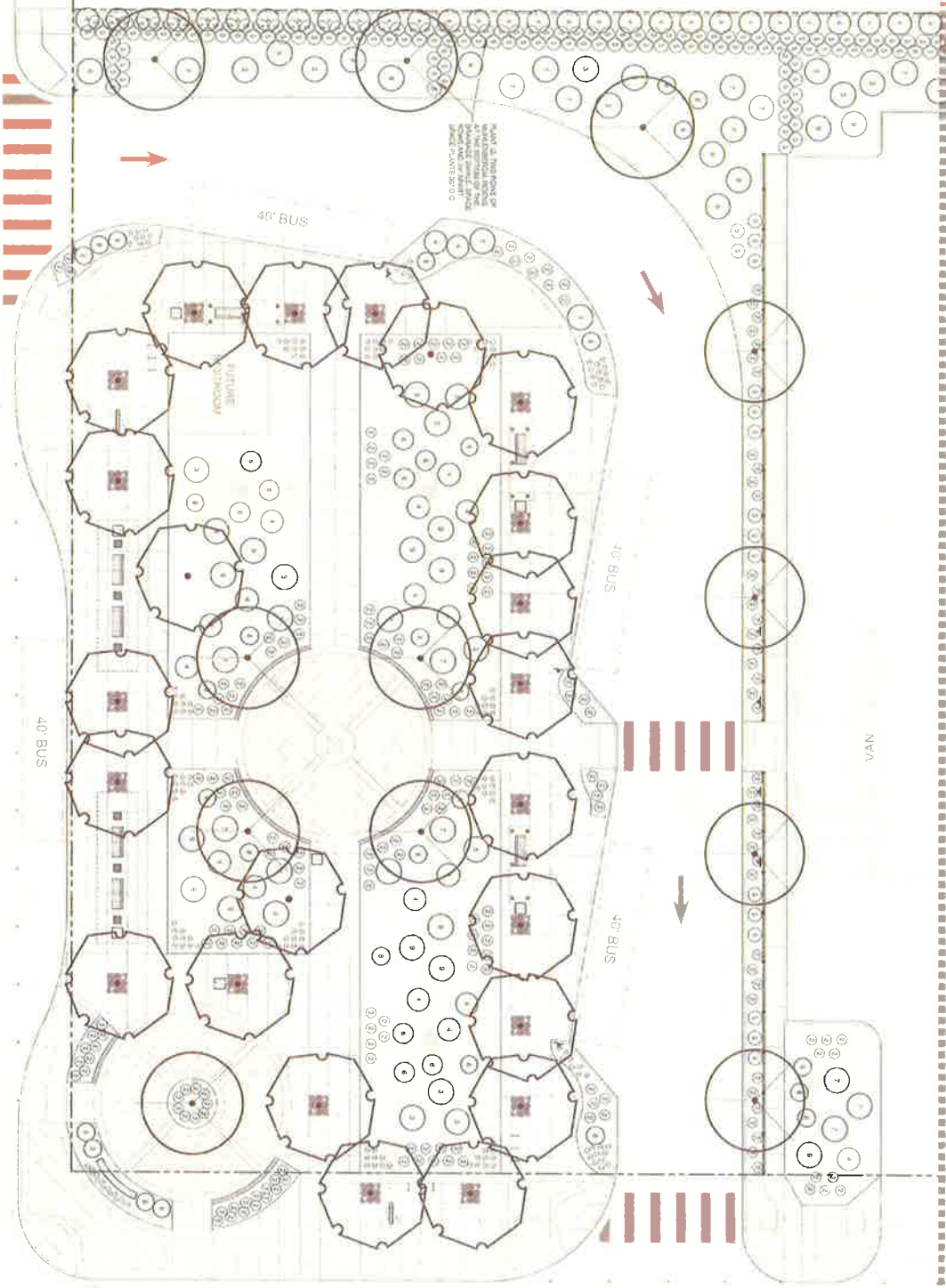

SEE SHEET L-5 FOR PLANT LIST
 SEE SHEET L-16 FOR PLANTING NOTES
 SEE SHEET L-16 FOR PLANTING DETAILS

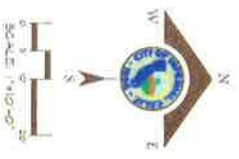

TESHIMA DESIGN GROUP
 1000 JOSHUA DRIVE, SUITE 200
 COSTA MESA, CALIFORNIA 92626
 TEL: (714) 440-1100 FAX: (714) 440-1101
 WWW.TESHIMADSG.COM



NO.	REVISIONS	DATE

PSOMAS
 401 B Street, Suite 1000
 Imperial, CA 92251
 (619) 355-3500 • (619) 355-4718
 www.psomas.com



CITY OF IMPERIAL
 420 South Imperial Avenue
 Imperial, CA 92251
 Ph: (760) 355-3840 • Fax: (760)355-4718

COMMUNITY DEVELOPMENT DEPARTMENT

IMPERIAL TRANSIT PARK
 PLANTING PLAN
 DATE: 04/21/2017

SHEET **22** OF **30** SHEETS
L-14

M STREET

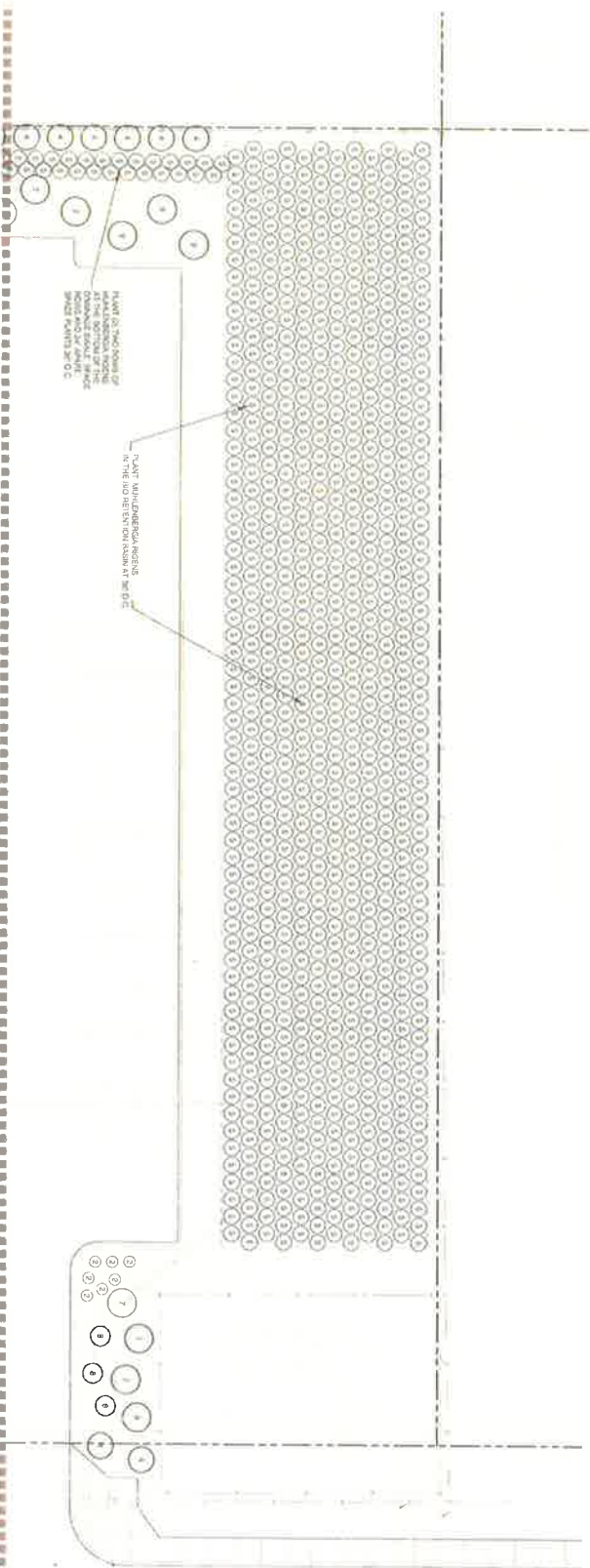

PLANT LIST

TREES

CODE	BOTANICAL NAME	COMMON NAME	QTY	SIZE	NOTES
1	<i>Palmisera Desert Museum</i>	Palm Tree	23	24 Box	Contractor shall hand select natural landscape trees of varying sizes from botanical nursery. Prior to each tree shall be approved prior to installation and shall be installed in the same area as indicated on the drawing. Full irrigation system shall be installed. Must include double drainage and double drainage. Must include P1 and P2. See additional notes below.
2	<i>Prosopis juliflora</i>	Mesquite	12	24 Box	Multi-trunk, full shade, straight trunk and medium. Make certain proper for MSNW. Full irrigation system shall be installed. Must include double drainage and double drainage per Detail P1 and P2. See additional notes below.

NOTE: ALL TREES LOCATED WITHIN 5 FEET OF ANY HANDSCAPE SHALL BE INSTALLED WITH ROOT BARRIER, ROOT BARRIER SHALL BE BID BARRIER. SEE DETAIL P3 ON SHEET L-16

SHRUBS

CODE	BOTANICAL NAME	COMMON NAME	QTY	SIZE	NOTES
1	<i>Ficus galeata</i>	Blue Fig	196	1 Gallon	Full and bushy. See Detail P1.
2	<i>Lantana macrodonensis</i>	Purple Trailing Lantana	200	1 Gallon	Full and bushy. Available from MSNW. See Detail P1.
3	<i>Desfontainia wickhamii</i>	Desert Spoon	20	5 Gallon	Full and bushy. Available from MSNW. See Detail P1.
4	<i>Lanopodium candidum</i>	Gran Cloud	58	5 Gallon	Full and bushy. Available from MSNW. See Detail P1.
5	<i>Muhlenbergia rigens</i>	Deer Grass	967	1 Gallon	Plant at the bottom of the drainage pipe and in the pot bottom (earth). Available from MSNW. See Detail P1.
6	<i>Yucca repandifolia</i>	Wavering Yucca	9	5 Gallon	Full and bushy. See Detail P1.
7	<i>Ceanothus mollebrunneus</i>	Red Bird of Paradise	27	5 Gallon	Full and bushy. Available from MSNW. See Detail P1.
8	<i>Agave americana</i>	Winged Century Plant	31	5 Gallon	Full and bushy. See Detail P1.
9	<i>Agave vittimolina</i>	Octopus Agave	5	5 Gallon	Full and bushy. See Detail P1.

NOTES:
 1. MANY OF THE AGAVE LISTED TREES AND SHRUBS ARE AVAILABLE FROM MOUNTAIN STATES WHOLESALE NURSERY. CONTACT MOUNTAIN STATES WHOLESALE NURSERY AT 10000 N. 10TH AVENUE, DENVER, CO 80231. (303) 751-1111. OTHER STATES WILL REQUIRE AN AGRICULTURAL INSPECTION WHICH IS THE CONTRACTOR'S RESPONSIBILITY. VERIFY CAN HELP THE CONTRACTOR WITH THE INSPECTIONS IF NEEDED.
 2. ALL PLANTS FOR THIS PROJECT SHALL COME FROM NURSERIES LOCATED IN THE SAME CLIMATE ZONE AS CITY OF IMPERIAL. CONTRACTOR SHALL PROVIDE NAME AND LOCATION OF THE NURSERY WITH THE PLANTING TO SUBMITTALS FOR APPROVAL BY LANDSCAPE ARCHITECT

SEE SHEET L-16 FOR PLANTING NOTES
 SEE SHEET L-16 FOR PLANTING DETAILS



TESHIMA DESIGN GROUP
 1000 W. BROADWAY, SUITE 100
 SAN ANTONIO, TEXAS 78207
 TEL: (214) 520-1234
 FAX: (214) 520-1234
 DATE: 2-2-8

NO.	REVISIONS	DATE

PSOMAS
 401 B Street, Suite 1000
 San Diego, CA 92101
 (619) 581-2592 fax



CITY OF IMPERIAL
 420 South Imperial Avenue
 Imperial, CA 92251
 Ph: (760) 355-3840 • Fax: (760) 355-4718

COMMUNITY DEVELOPMENT DEPARTMENT

PLANTING PLAN AND PLANT LIST
IMPERIAL TRANSIT PARK

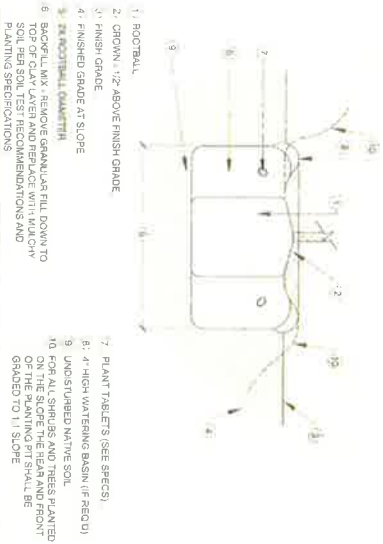

NOTE: SCALE

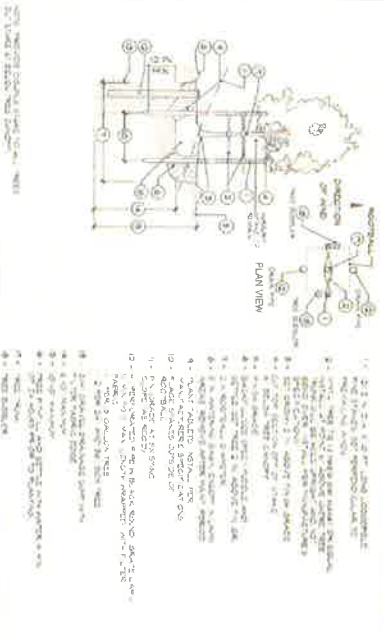

NOTE: SCALE

P1 TREE / SHRUB PLANTING

P2 TREE DOUBLE STAKING AND DRAINAGE

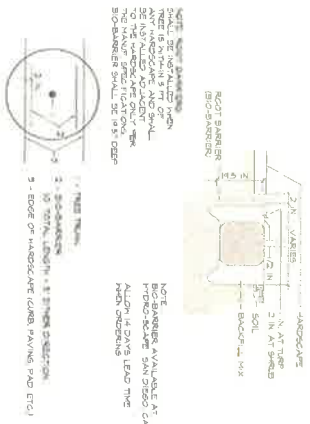

NOTE: SCALE

P3 ROOT BARRIER

P4 PLANTING NOTES

1. CONTRACTOR SHALL HAVE A MINIMUM OF 10% OF THE SOIL TEST, ASSIGNED IN THREE DIFFERENT LOCATIONS ON THE SITE AND COMPLETED BY A HELIUM CHEMICAL COMPANY (CONTACT TONY HITCHCOCK AT 780-442-1111) OR EQUIVALENT. THE SOIL TEST SHALL INCLUDE BUT NOT BE LIMITED TO THE TESTING OF SOIL SALT LEVELS, EC, PH, AND ORGANIC MATTER. THE SOIL TEST SHALL BE APPROVED BY THE CITY INSPECTOR PRIOR TO BEGINNING THE SOIL TEST. CONTRACTOR SHALL BE RESPONSIBLE FOR SUPPLYING AND INSTALLING THE SOIL TEST EQUIPMENT AND MATERIALS. CONTRACTOR SHALL PROVIDE A COPY OF THE SOIL TEST AND AMENDMENTS TO LANDSCAPE ARCHITECT.

2. THE CONTRACTOR IS RESPONSIBLE FOR OBTAINING ALL REQUIRED PERMITS PRIOR TO COMMENCING LANDSCAPE INSTALLATION.

3. CONTRACTOR SHALL COMPLY WITH THE CITY OF IMPERIAL STANDARDS AND SPECIFICATIONS FOR PLANTING.

4. ALL PLACEMENT OF PLANT MATERIAL SHALL BE APPROVED BY THE LANDSCAPE ARCHITECT PRIOR TO PLANTING.

5. ALL PLACEMENT OF PLANT MATERIAL SHALL BE APPROVED BY THE LANDSCAPE ARCHITECT PRIOR TO PLANTING.

6. ROOT BARRIERS SHALL BE INSTALLED WITH ALL TREES THAT ARE WITHIN FIVE (5) FEET OF ANY EXISTING OR PROPOSED UTILITY LINES AND SHALL BE INSTALLED IN ACCORDANCE WITH THE CITY OF IMPERIAL STANDARDS AND SPECIFICATIONS FOR PLANTING. ROOT BARRIERS WILL NOT BE INSTALLED AROUND THE ROOTBALL. ROOT BARRIERS SHALL BE INSTALLED WITHIN 2' OF DECOMPOSED GRANITE IN ALL LANDSCAPE AREAS. CONTRACTOR SHALL PROVIDE A COPY OF THE ROOT BARRIER INSTALLATION PLAN TO THE LANDSCAPE ARCHITECT PRIOR TO PLANTING.

7. ALL PLANT MATERIAL SHALL BE APPROVED BY THE LANDSCAPE ARCHITECT PRIOR TO PLANTING.

8. ALL PLANT MATERIAL SHALL BE APPROVED BY THE LANDSCAPE ARCHITECT PRIOR TO PLANTING.

9. ALL PLANT MATERIAL SHALL BE APPROVED BY THE LANDSCAPE ARCHITECT PRIOR TO PLANTING.

10. ALL PLANT MATERIAL SHALL BE APPROVED BY THE LANDSCAPE ARCHITECT PRIOR TO PLANTING.

11. ALL PLANT MATERIAL SHALL BE APPROVED BY THE LANDSCAPE ARCHITECT PRIOR TO PLANTING.

12. ALL PLANT MATERIAL SHALL BE APPROVED BY THE LANDSCAPE ARCHITECT PRIOR TO PLANTING.

13. ALL PLANT MATERIAL SHALL BE APPROVED BY THE LANDSCAPE ARCHITECT PRIOR TO PLANTING.

14. UPON COMPLETION OF PLANTING OPERATIONS AND BEFORE ANY SITE OBSERVATIONS, REMOVE ALL EXCESSIVE MATERIAL, AND DEBRIS AND BROOD AND WASH THE WORK AREA.

15. LOGS FROM REMOVAL OF TREES SHALL BE REMOVED BY THE CITY.

16. ALL TREES MUST BE STAKED, TRUNKED AND FULLY IRRIGATED AND MET ALL REQUIREMENTS BEFORE PLANTING.

17. ALL TREES MUST BE STAKED AS SHOWN IN THE DETAILS.

18. PRIOR TO CONSTRUCTION, THE CONTRACTOR SHALL BE RESPONSIBLE FOR LOCATING ALL UNDERGROUND UTILITIES AND SHALL PROVIDE TO ALL UTILITIES AND SHALL BE RESPONSIBLE FOR REPAIRING ANY AND ALL DAMAGE TO UTILITIES STRUCTURES, SITE APPURTENANCES, ETC. WHICH OCCURS AS A RESULT OF THE LANDSCAPE CONSTRUCTION.

19. THE CONTRACTOR IS RESPONSIBLE FOR VERIFYING ALL QUANTITIES SHOWN ON THESE PLANS BEFORE BEGINNING THE WORK.

20. CONTRACTOR IS RESPONSIBLE FOR VERIFYING ALL QUANTITIES SHOWN ON THESE PLANS BEFORE BEGINNING THE WORK.

21. CONTRACTOR IS RESPONSIBLE FOR VERIFYING ALL QUANTITIES SHOWN ON THESE PLANS BEFORE BEGINNING THE WORK.

22. THE CONTRACTOR IS RESPONSIBLE FOR FULL MAINTENANCE INCLUDING BUT NOT LIMITED TO WATERING, STAKING, TRUNKING, AND TRUNK WRAPPING OF ALL TREES THROUGHOUT THE PERIOD OF THE SHOWN IN NETWORK SPECIFICATIONS.

23. THE CONTRACTOR SHALL COMPLETELY GUARANTEE ALL PLANT MATERIAL FOR A PERIOD SPECIFIED IN THE NETWORK SPECIFICATIONS BEFORE THE END OF THE GUARANTEE PERIOD.

24. ANY PLANT MATERIAL WHICH DIES, THINS, BROWN, OR DEFORMS PRIOR TO TOTAL ACCEPTANCE OF THE SAME SPECIES, QUANTITY, AND SIZE AND MEETING ALL PLANT LIST SPECIFICATIONS SHALL BE REPLACED AT THE CONTRACTOR'S EXPENSE.

25. LOCATION OF EXISTING BARRIERS ON THESE PLANS ARE BASED UPON BEST AVAILABLE INFORMATION AND ARE TO BE CONSIDERED APPROXIMATE. IT SHALL BE THE RESPONSIBILITY OF THE CONTRACTOR TO VERIFY THE LOCATION OF ALL UTILITIES AND ADJUST TO THE WORK AREA PRIOR TO CONSTRUCTION. CONTRACTOR SHALL BE RESPONSIBLE FOR THE PROTECTION OF ALL UTILITIES DURING THE COURSE OF THE CONSTRUCTION PERIOD.

26. DURING THE CONSTRUCTION PERIOD.

27. ALL PLANT MATERIAL QUANTITIES SHOWN ARE APPROXIMATE. CONTRACTOR SHALL BE RESPONSIBLE FOR COMPLETING QUANTITIES IN ALL NETWORK SECTIONS THROUGHOUT THE CONSTRUCTION PERIOD.

28. THE CONTRACTOR IS RESPONSIBLE FOR OBTAINING ALL REQUIRED PERMITS PRIOR TO COMMENCING LANDSCAPE INSTALLATION.

29. THE CONTRACTOR SHALL BE RESPONSIBLE FOR OBTAINING ALL REQUIRED PERMITS PRIOR TO COMMENCING LANDSCAPE INSTALLATION.

PSOMAS

420 S. STATE ST., SUITE 1500
IMPERIAL, CA 92251
(619) 951-2850
www.psomas.com

CITY OF IMPERIAL
420 South Imperial Avenue
Imperial, CA 92251
Ph: (760) 355-3840 • Fax: (760)355-4718

COMMUNITY DEVELOPMENT DEPARTMENT

PLANTING DETAILS AND NOTES

IMPERIAL TRANSIT PARK

DATE: 09/31/2017

SHEET 24 OF 30

L-16

UNLICENSED CHANGES & USES: The engineer certifies these plans are not to be reproduced for a copy or otherwise changed in or out of their original design or intended use without the written approval of the engineer of record.

986 ENGINEERING, INC.
 2770 S. STATE ST. SUITE 200
 IMPERIAL, CA 92240
 TEL: 760-935-4716
 FAX: 760-935-4718



CITY OF IMPERIAL
 420 South Imperial Avenue
 Imperial, CA 92251
 Ph: (760) 355-3840 • Fax: (760) 355-4716

COMMUNITY DEVELOPMENT DEPARTMENT

DATE: 2/27/2018

IMPERIAL TRANSIT PARK

SHEET **26**
 OF 30 SHEETS

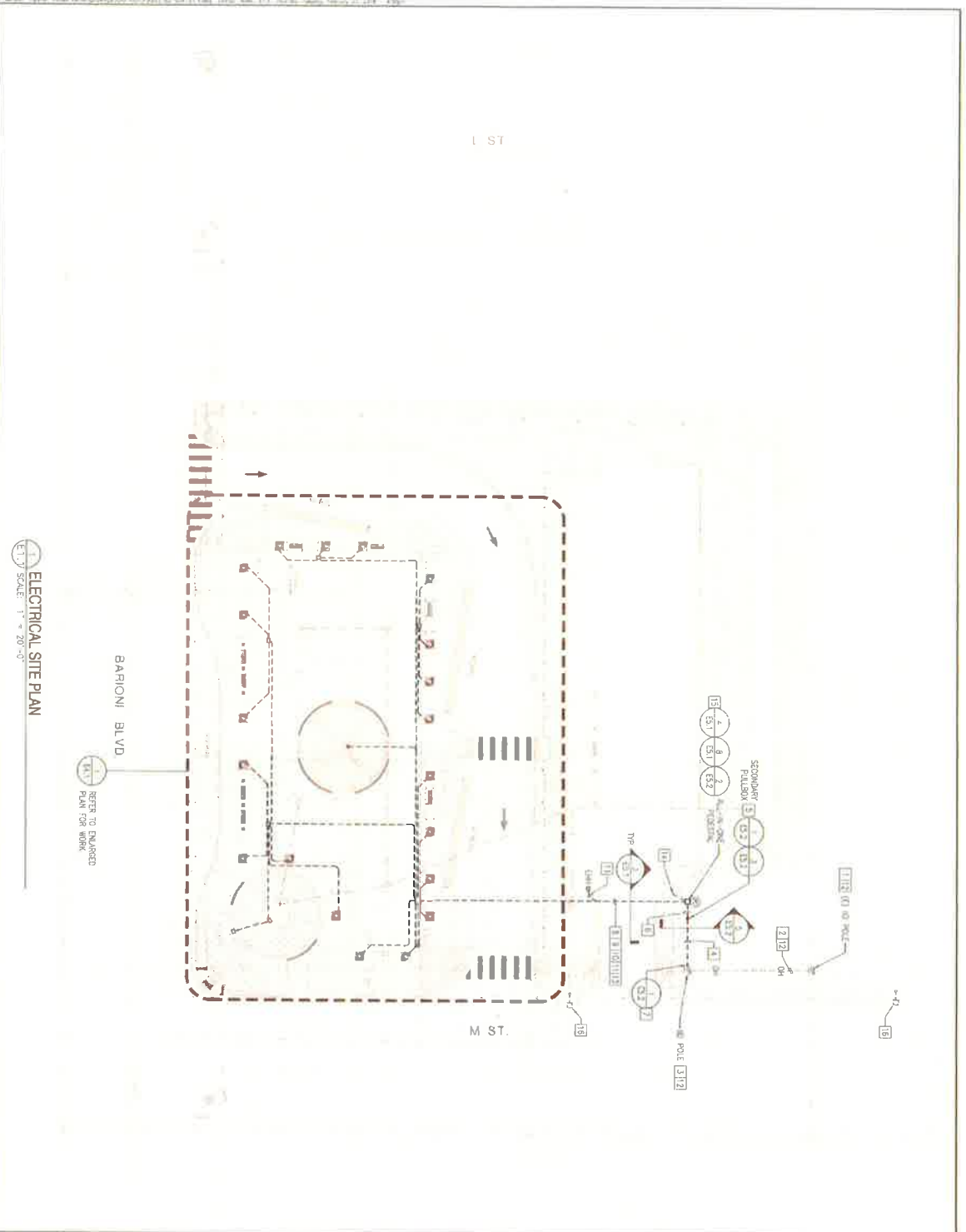

- KEY NOTES**
1. TO UPGRADE EXISTING 30 KVA TRANSFORMER AS NECESSARY TO ACCOMMODATE TRANSIT CENTER DEMAND AND PROVISION C&D
 2. TO PROVIDE OVERHEAD CONDUCTORS TO ALL IN-OVER PROTECTIVE
 3. TO PROVIDE SERVICE POLE
 4. CONTRACTOR TO TRENCH AND PROVIDE 3" C.O. SCHEDULE 40 PVC
 5. PROVIDE SECONDARY TUB BOX PROVIDE A MINIMUM CLEARANCE OF 8" FROM OTHER UTILITIES. TUB BOX SHALL BE INSTALLED NO LESS THAN 12" BEHIND SIDEWALK
 6. CONTRACTOR TO TRENCH AND PROVIDE 2" C.O. SCHEDULE 40 PVC
 7. CONTRACTOR TO PROVIDE 3" C.O. SCHEDULE 40 PVC SERVICE RISER TO UP POLE
 8. TRENCH AND PROVIDE 8410, 4" DIA. N. 1/2" FOR TREE UP LIGHTING
 9. TRENCH AND PROVIDE 8410, 4" DIA. N. 1/2" TO RELOCATION CONTROLLER COORDINATE WITH RELOCATION PLAN FOR LOCATION AND REQUIREMENTS
 10. TRENCH PROVIDE AND INSTALL 1 1/4" C.O. FOR FUTURE RESTROOM
 11. TRENCH PROVIDE AND INSTALL 1" C.O. FOR FUTURE USE
 12. COORDINATE WITH 10
 13. TRENCH PROVIDE AND INSTALL 3-1/4" C.O. FOR FUTURE USE
 14. TRENCH AND PROVIDE 8412, 4" DIA. 1" C.O. FOR STORM DRAIN SAME PUMP PROVIDE SWITCHED SWITCH "SLIP TRIP"
 15. PROVIDE PHOTO CELL AND MOUNT TOWARDS THE NORTH EAST ON PEDESTAL
 16. POLE MOUNTED LIGHT SHOWN FOR REFERENCE ONLY. TO PROVIDE AND INSTALL

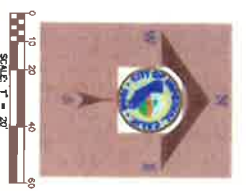

E1.1

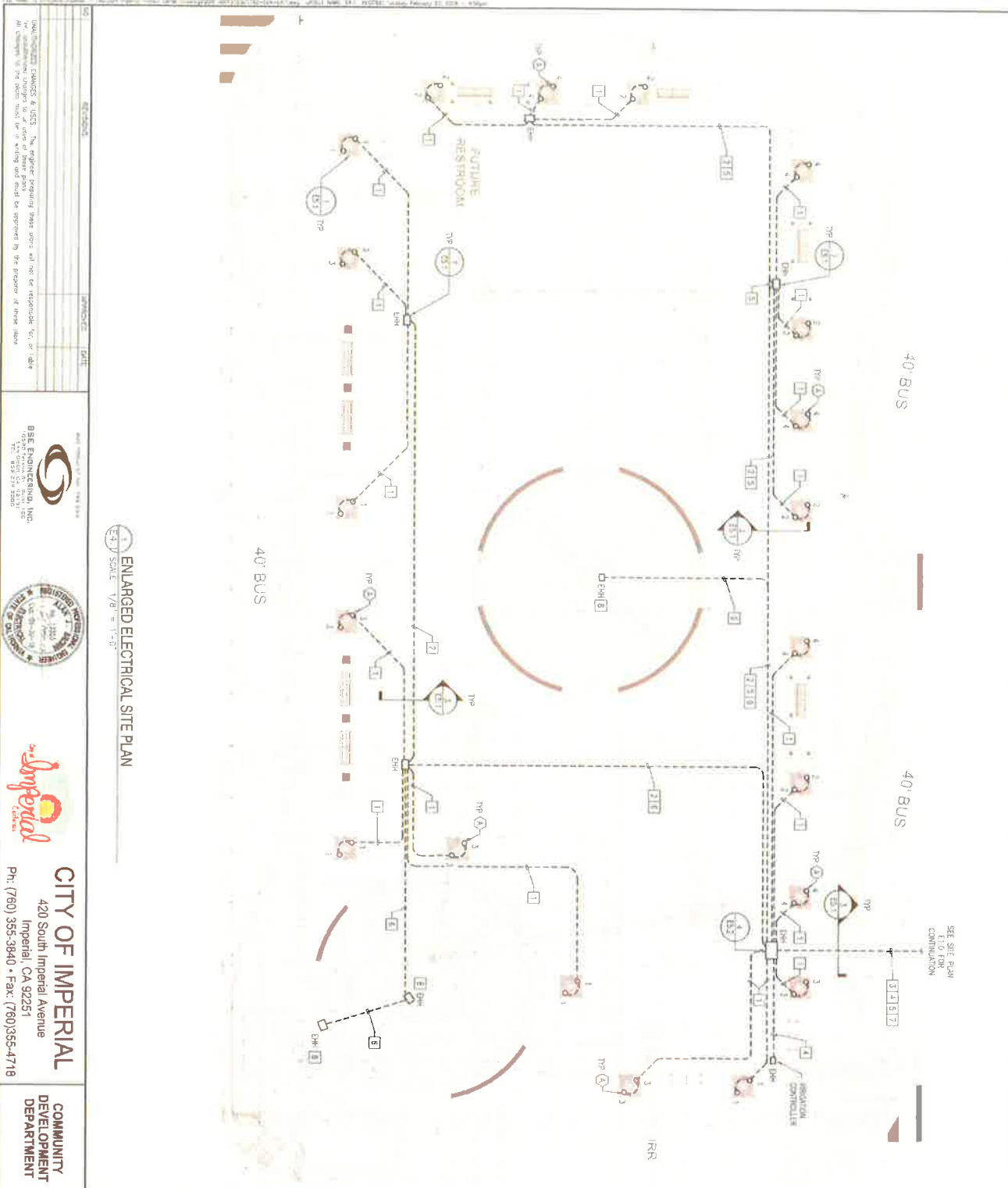

ENLARGED ELECTRICAL SITE PLAN
SCALE: 1/8" = 1'-0"

GENERAL NOTES

1. REFER TO LUMBER SCHEDULE 1/2"-6" FOR TYPES OF LUMBERS

KEY NOTES

- 1] RENOVC AND PROVIDE 2410 #100, 1" C FOR HELL UP LIGHTING
- 2] RENOVC AND PROVIDE 4410, 2410, 2410, IN 1" C FOR HELL UP LIGHTING
- 3] RENOVC AND PROVIDE 8410, 4410, IN 1-1/2" C FOR HELL UP LIGHTING
- 4] RENOVC AND PROVIDE 2412 #100, IN 1" C TO REGISTRATION CONTROLLER COMPART WITH PROTECTIVE DOOR FOR LOCATION AND REQUIREMENTS
- 5] RENOVC, PROVIDE AND INSTALL 1 1/4" C.O. FOR SQUARE RESTROOM
- 6] RENOVC, PROVIDE AND INSTALL 1" C.O. FOR DUNGEON USE
- 7] RENOVC PROVIDE AND INSTALL 3-1" C.O. FOR FUTURE USE
- 8] COORDINATE HANDHOLE LOCATION WITH HARDSCAPE PATTERS

NO.	REVISION	DATE

DATE CHANGES & USES: The engineer preparing these notes will not be responsible for, or date at Company. All the plans shall be in writing and must be approved by the presence of these notes



CITY OF IMPERIAL
420 South Imperial Avenue
Imperial, CA 92251
Ph: (760) 365-3840 • Fax: (760) 365-4718

COMMUNITY DEVELOPMENT DEPARTMENT

ENLARGED ELECTRICAL SITE PLAN
IMPERIAL TRANSIT PARK
DATE: 2/27/2018
SHEET 27
E4.1
30

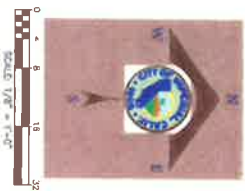

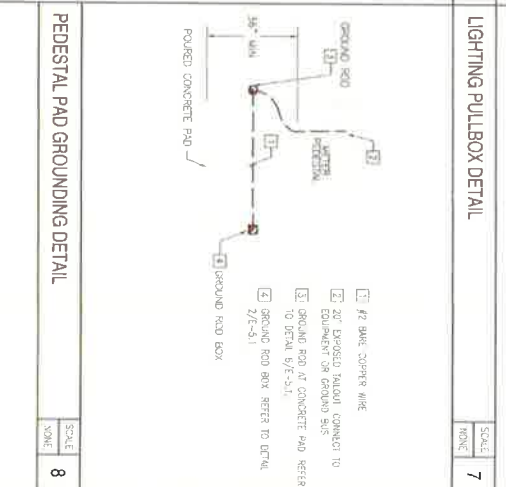
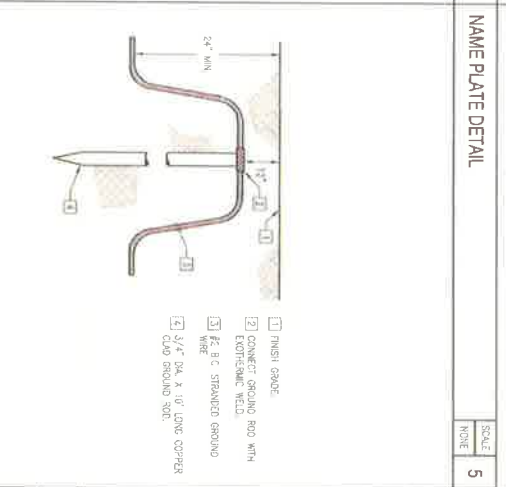
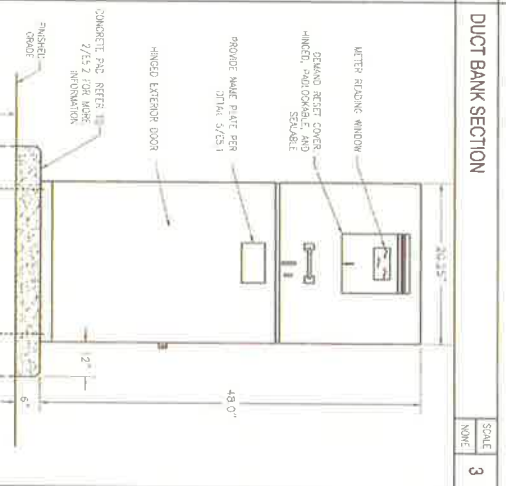
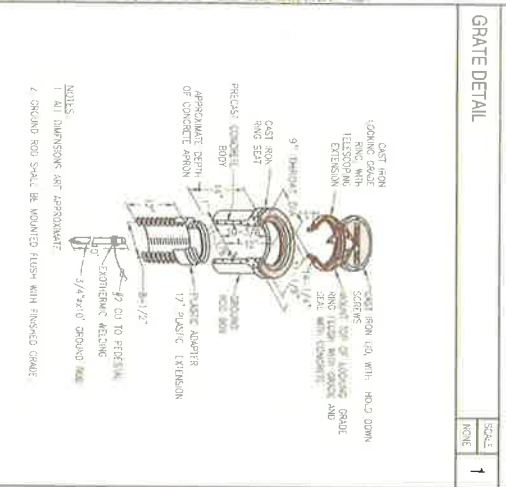
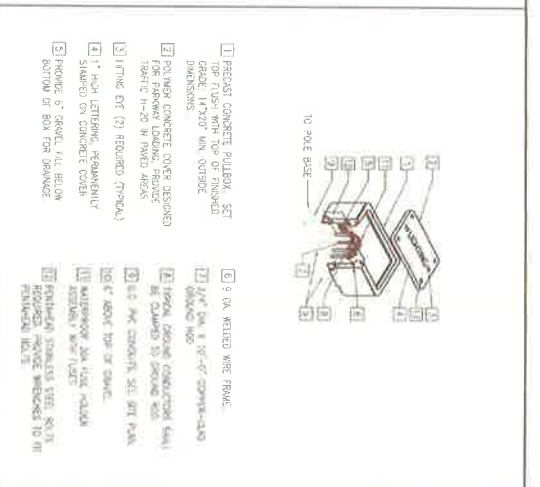
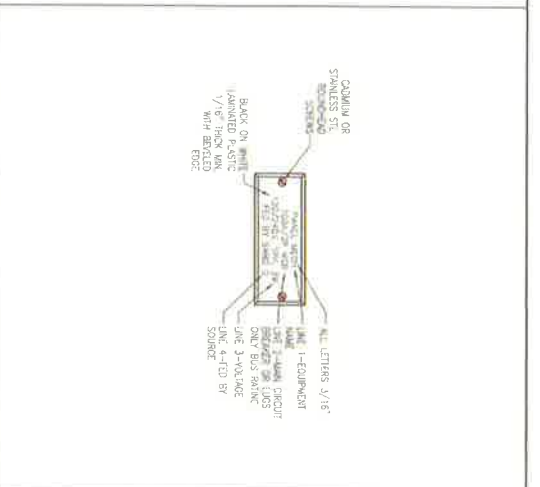
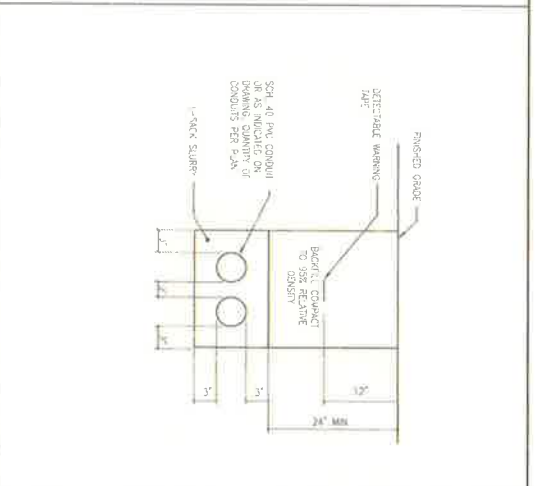
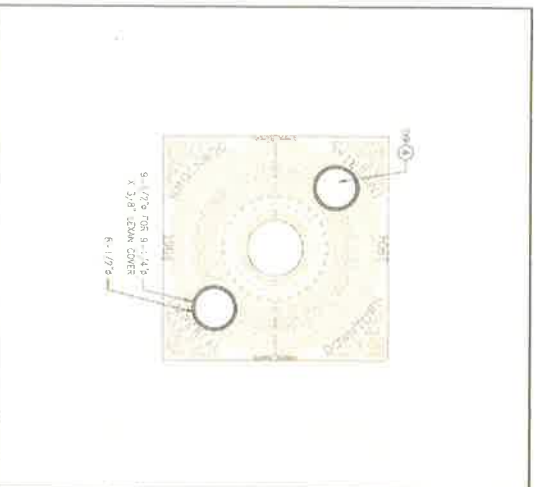

REVISIONS	DATE	BY	SCALE

GROUND ROD BOX DETAIL

SCALE: NONE

DATE: 2

DUCT BANK SECTION

SCALE: NONE

DATE: 1

METERED PEDESTAL DETAIL

SCALE: NONE

DATE: 4

GROUND ROD INSTALLATION

SCALE: NONE

DATE: 6

LIGHTING PULL BOX DETAIL

SCALE: NONE

DATE: 7

NOTES:
 1. ALL DIMENSIONS ARE APPROXIMATE.
 2. GROUND ROD SHALL BE ANCHORED FLUSH WITH FINISHED GRADE.

FINISHED GRADE
 1'-THICK SLURRY
 4\"/>

CALLING OR STAINLESS STEEL BOND-BOND STAINLESS
 BACK ON WHITE 1/2\"/>

10 POLE BOX
 1\"/>

OUT FROM RING WITH 1/2\"/>

1'-THICK SLURRY
 4\"/>

HINGED EXTERIOR DOOR
 CONCRETE PAD REFERS TO DETAIL 5/CS-1
 HINGED REAR WINDOW
 HINGED REAR COVER
 HINGED REAR WINDOW SLAB
 PROVIDE WAKE PLATE PER DETAIL 5/CS-1
 48'-0\"/>

24\"/>

1. FINISH GRADE
 2. CONCRETE GROUND ROD WITH EXOTHERMIC WELD
 3. #3 C STRAPPED GROUND WIRE
 4. 3/4\"/>

1. #7 B&E COPPER WIRE
 2. 20' EXPOSED METAL CONDUIT TO EQUIPMENT OR GROUND BUS
 3. GROUND ROD AT CONCRETE PAD REFERS TO DETAIL 5/CS-1
 4. GROUND ROD BOX REFERS TO DETAIL 2/2-5.1
 5. GROUND ROD BOX

1. #7 B&E COPPER WIRE
 2. 20' EXPOSED METAL CONDUIT TO EQUIPMENT OR GROUND BUS
 3. GROUND ROD AT CONCRETE PAD REFERS TO DETAIL 5/CS-1
 4. GROUND ROD BOX REFERS TO DETAIL 2/2-5.1
 5. GROUND ROD BOX

1. PRECAST CONCRETE PULLBOX SET INTO GRADE. 14'-0\"/>

2. 1\"/>

3. 1\"/>

4. 1\"/>

5. PROVIDE 6\"/>

6. 9\"/>

7. 1\"/>

8. 1\"/>

9. 1\"/>

10. 1\"/>

11. 1\"/>

12. 1\"/>

13. 1\"/>

14. 1\"/>

15. 1\"/>

16. 1\"/>

17. 1\"/>

18. 1\"/>

19. 1\"/>

20. 1\"/>

21. 1\"/>

22. 1\"/>

23. 1\"/>

24. 1\"/>

25. 1\"/>

26. 1\"/>

27. 1\"/>

28. 1\"/>

29. 1\"/>

30. 1\"/>

31. 1\"/>

32. 1\"/>

33. 1\"/>

34. 1\"/>

35. 1\"/>

36. 1\"/>

37. 1\"/>

38. 1\"/>

39. 1\"/>

40. 1\"/>

41. 1\"/>

42. 1\"/>

43. 1\"/>

44. 1\"/>

45. 1\"/>

46. 1\"/>

47. 1\"/>

48. 1\"/>

49. 1\"/>

50. 1\"/>

51. 1\"/>

52. 1\"/>

53. 1\"/>

54. 1\"/>

55. 1\"/>

56. 1\"/>

57. 1\"/>

58. 1\"/>

59. 1\"/>

60. 1\"/>

61. 1\"/>

62. 1\"/>

63. 1\"/>

64. 1\"/>

65. 1\"/>

66. 1\"/>

67. 1\"/>

68. 1\"/>

69. 1\"/>

70. 1\"/>

71. 1\"/>

72. 1\"/>

73. 1\"/>

74. 1\"/>

75. 1\"/>

76. 1\"/>

77. 1\"/>

78. 1\"/>

79. 1\"/>

80. 1\"/>

81. 1\"/>

82. 1\"/>

83. 1\"/>

84. 1\"/>

85. 1\"/>

86. 1\"/>

87. 1\"/>

88. 1\"/>

89. 1\"/>

90. 1\"/>

91. 1\"/>

92. 1\"/>

93. 1\"/>

94. 1\"/>

95. 1\"/>

96. 1\"/>

97. 1\"/>

98. 1\"/>

99. 1\"/>

100. 1\"/>

101. 1\"/>

102. 1\"/>

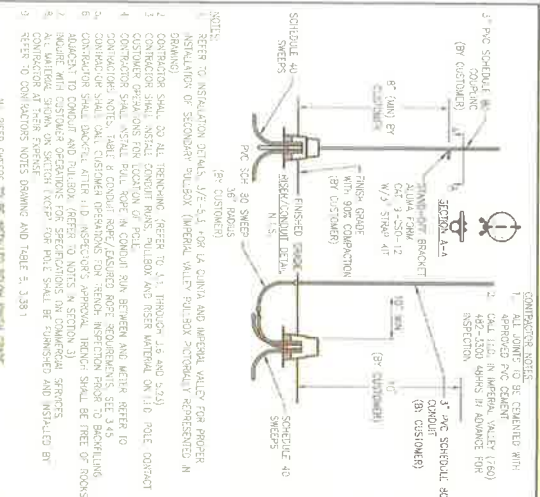

IID RISER AND PULLBOX DETAIL

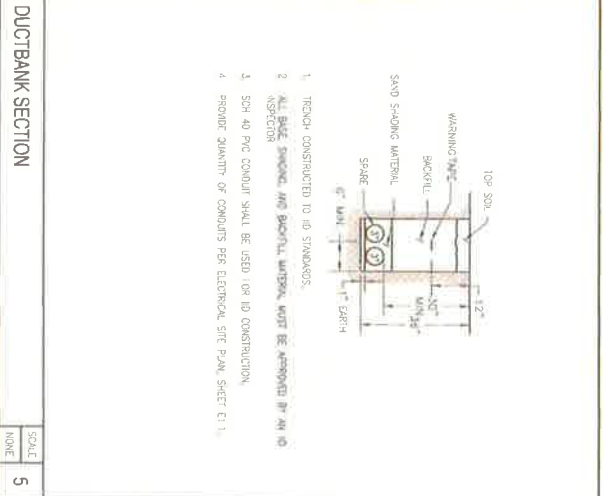
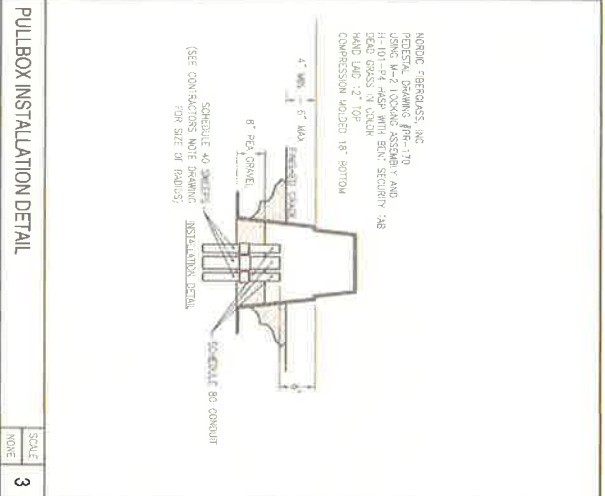

DUCTBANK SECTION

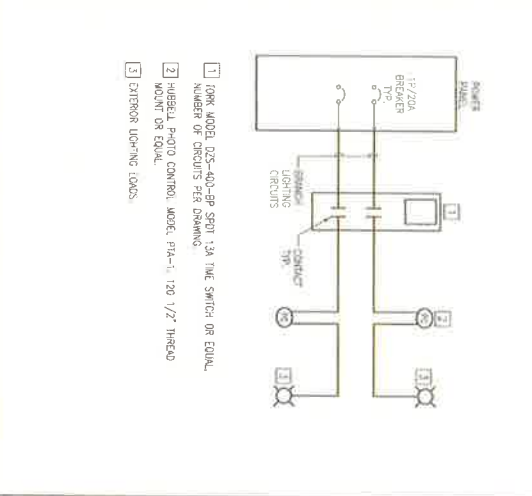
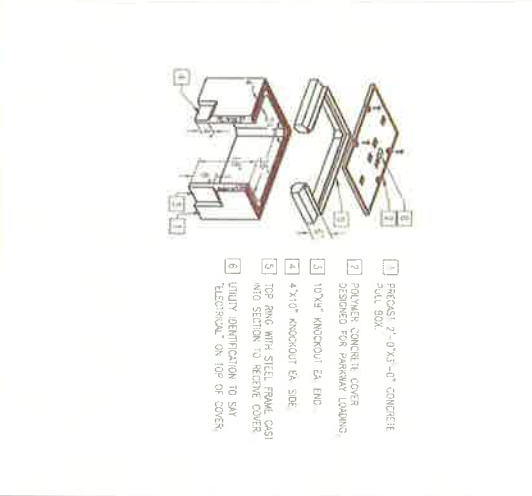
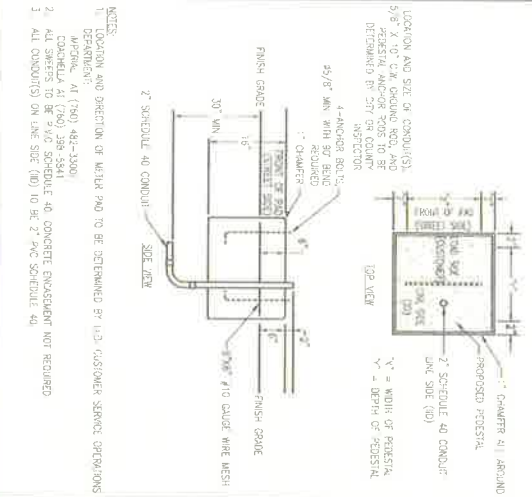

EXTERIOR LIGHTING WIRING DIAGRAM

NO.	DESCRIPTION	SCALE
1	IID RISER AND PULLBOX DETAIL	NONE
2	ELECTRICAL HANDHOLE DETAIL W/O BASE	NONE
3	PULLBOX INSTALLATION DETAIL	NONE
4	EXTERIOR LIGHTING WIRING DIAGRAM	NONE
5	DUCTBANK SECTION	NONE
6	PEDESTAL PAD DETAIL	NONE

UNWARRANTED CHANGES & ISSUES: The engineer preparing these plans will not be responsible for or liable for any errors or omissions in these plans. The contractor shall be responsible for obtaining all necessary permits and for obtaining all necessary approvals from the appropriate authorities. The contractor shall be responsible for obtaining all necessary approvals from the appropriate authorities.

B&E ENGINEERING, INC.
 10000 IMPERIAL AVENUE, SUITE 100
 IMPERIAL, CA 92251
 TEL: (760) 355-5840 FAX: (760) 355-4718

IMPERIAL COUNTY
 COUNTY ENGINEER
 10000 IMPERIAL AVENUE, SUITE 100
 IMPERIAL, CA 92251
 TEL: (760) 355-5840 FAX: (760) 355-4718

CITY OF IMPERIAL
 420 South Imperial Avenue
 Imperial, CA 92251
 Ph: (760) 355-5840 • Fax: (760) 355-4718

COMMUNITY DEVELOPMENT DEPARTMENT

ELECTRICAL DETAILS

IMPERIAL TRANSIT PARK

SHEET **29** OF 30 SHEETS

DATE: 4/27/2015

CALLOUT	SYMBOL	LAMP	DESCRIPTION	BALLAST	MOUNTING	MODEL	HEIGHT	VOLTS
4		(1) TW LED 4000K	LED TREC GRATE UP LIGHT WITH MACHINED STAINLESS STEEL TREE GRATE COLLAR COORDINATE WITH TREE GRATE MANUFACTURER BOROSILICATE GLASS LENS INTEGRATED TRANSFORMER HOUSING MADE OF CORROSION FREE COMPOSITE HIGH STRENGTH ALUMINUM BRACKET LUMINAIRE DIAMETER TO MATCH TRANSFORMER DIAMETER FOR DARK BRONZE FINISH (L LISTED FOR MET LOCATION)	ELECTRONIC	GROUND	RF LIGHTING HP2-LED-TREC-EGG-ICE WITH TREE GRATE COLLAR	120V IP 2W	
7								

74 - OUTDOOR LIGHTING COMPLIANCE
LUMINAIRE LIGHTING IS DESIGN FROM 74 REGULATIONS
PER EXCEPTION TO 1407(d) OF THE 2016 BUILDING
ENERGY EFFICIENCY STANDARDS.

LUMINAIRE SCHEDULE

SCALE: 1/8" = 1'-0"

DEVICE	FEDER	BEANCU CIRCUIT	WIRE SIZE	WIRE LENGTH	TOTAL VOLTAGE DROP
A	#2	0.09%	0.31% (CCK 3)	#12	624
					0.8%

VOLTAGE DROP

SCALE: 1/8" = 1'-0"

DEVICE	FEDER	FEDER	FEDER
A	4201'S	42000	#2
			#2

SHORT CIRCUIT CALCULATION

SCALE: 1/8" = 1'-0"

NO.	DESCRIPTION	AMPS	FEEDER	FEEDER	FEEDER
1	200' LIGHTING - TREE UP LIGHT	64	2	200' LIGHTING - TREE UP LIGHT	70
2	200' LIGHTING - TREE UP LIGHT	100	6	200' RESTROOM (V-TRIED)	3
3	200' RESTROOM (V-TRIED)	900	8	200' TIME CLOCK	160
4	200' TIME CLOCK	0	12	200' STAIRS	0
5	200' STAIRS	0	13	200' STAIRS	0
TOTAL CONNECTED W/ BY PHASE 234 1172					
CONN VA					
CALC VA					
CONTINUOUS 200 (125%)					
NONCONTINUOUS 0 (100%)					
DIVERSITY 0 (N/A)					
BALANCED AMPS 1428 7382					

PANEL SCHEDULE

SCALE: 1/8" = 1'-0"

REVISIONS
DATE
BY



CITY OF IMPERIAL
420 South Imperial Avenue
Imperial, CA 92251
Ph: (760) 355-3840 • Fax: (760) 355-4718

COMMUNITY DEVELOPMENT DEPARTMENT

DATE: 2/21/2015

SINGLE LINE DIAGRAM AND CALCULATIONS

SHEET 30 OF 30 SHEETS

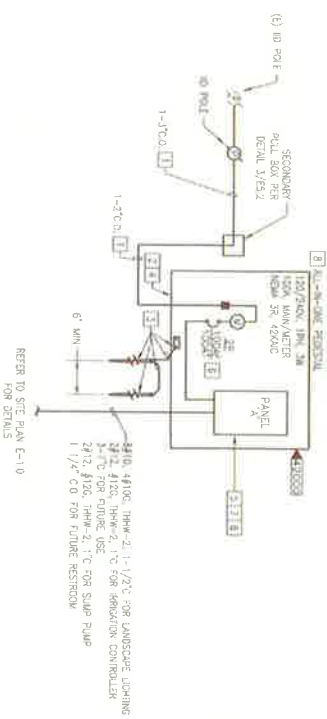

SINGLE LINE DIAGRAM

SCALE: 1/8" = 1'-0"

- ### KEY NOTES
1. SERVICE ENTRANCE CONDUCTIONS SHALL BE FINISHED AND REPAIRED BY ID.
 2. PROVIDE 120/240, 1 PHASE, 3 WIRE, 100 AMP W/AL-H-0NF W/TERMINAL RECEPT, MAIN CIRCUIT BREAKER SHALL BE 500A WITH BATTERY BACK UP FOR THE CLOCK MEMORY AND LOGGING CONDUCTOR. SEE LIGHTING CONTROL PANEL WIRING DIAGRAM 6/13.2 CABINET SHALL BE NEMA 3R RATED ENCLOSURE.
 3. PROVIDE #1 COPPER WIRE STRANDED GROUND WIRE AND 3/4" X 1/2" COPPER COLD STEEL GROUND ROD.
 4. ELECTRICAL SERVICE EQUIPMENT SHALL HAVE MINIMUM AC RATING OF 42,000 AMPS.
 5. OVERCURRENT DEVICE ENCLOSURES SHALL BE IDENTIFIED LABELS IN ACCORDANCE WITH NEC 110-22.
 6. LABEL CIRCUIT BREAKER AS SERVICE DISCONNECTING W/ANS IN ACCORDANCE WITH NEC 430-10(B).
 7. REFER TO 4/1-6.1 FOR PANEL SCHEDULE.
 8. PROVIDE NUBRIDGE PER DETAIL 5/1-5.1.
 9. PROVIDE SWITCHED RECEPTACLE FOR SLUMP PUMP PROVIDE SWITCH TO CONTROL RECEPTACLE INSIDE RECEPTACLE LABEL SWITCH SLUMP PUMP.
 10. REQUIRE GROUND FAULT CIRCUIT BREAKER FOR SLUMP PUMP.

E6.1



Proposed Project Timeline

Imperial Transit Park
CA-04-0248-00
Northwest Corner of Barioni Blvd & M Street

Plans & Bid Documents Completion	Tuesday	3/6/18	City Hall
City Council Agenda Item Due	Wednesday	3/28/18	City Hall
City Council Meeting Notice to Seek Bids	Wednesday	4/4/18	City Council
Send Notice to IV Press for Invitation to Bid	Wednesday / Wednesday	5/16/18 5/23/18	Publication Period
Publish Invitation to Bid IV Press	Sunday/Sunday	5/20/18 5/27/18	City Hall
Pre-Bid Meeting	Tuesday	6/5/18	City Hall 10:00 a.m.
Bid Opening	Thursday	6/28/18	City Hall 3:00 p.m.
Review Bids	Monday – Friday	7/9/18 - 7/13/18	City Hall
City Council Agenda Item Due	Wednesday	7/11/18	City Hall
City Council Meeting to Award Project	Wednesday	7/18/18	City Council
Notify Contractor	Thursday	7/19/18	Mail & phone
Send Notification to Residents of Project	Friday	7/20/18	US Mail
Notice to Proceed	Wednesday	8/1/18	City Hall (10 days after Award)
Pre-Con Meeting	Thursday	8/2/18	City Hall 10:00 a.m.
Start Project	Monday	8/6/18	City Hall
Completion of Project 120 calendar days	Monday	12/3/18	City Hall

ONSITE

Description	Quantity	Unit	Unit Price	Total
Mobilization				
1	1	LS	\$25,000.00	\$25,000.00
Traffic Control/DeTour Safety	1	LS	\$30,000.00	\$30,000.00
Stormwater Compliance	1	LS	\$10,000.00	\$10,000.00
Demolition & Site Preparation				
Clearing & Grubbing	0.2	AC	\$5,000.00	\$803.00
Unclassified Excavation	3,000	CY	\$5.00	\$15,000.00
Export	3,000	CY	\$15.00	\$45,000.00
Remove Concrete Footings	1	LS	\$1,000.00	\$1,000.00
Subgrade Preparation	31,460	SF	\$0.50	\$15,730.00
Site Improvements				
Vehicular Pavement (8" Conc)	201	CY	\$400.00	\$80,413.00
Parking Lot Pavement (4" Asphalt)	278	TON	\$120.00	\$33,330.00
Roadway Pavement (4" Asphalt)	0	TON	\$120.00	\$0.00
Plaza Pavement (4" Concrete)	135	CY	\$400.00	\$54,188.00
Sand Base (4")	135	CY	\$50.00	\$6,774.00
Aggregate Base	625	CY	\$65.00	\$40,610.00
Concrete Sidewalk	600	SF	\$10.00	\$6,000.00
Concrete Curb & Gutter	563	LF	\$15.00	\$8,445.00
Concrete Curb	560	LF	\$12.00	\$6,720.00
Pedestrian Ramp	4	EA	\$2,500.00	\$10,000.00
6' High Chain Link Fencing/Gate	470	LF	\$25.00	\$11,750.00
42" High Chain Link Fencing	190	LF	\$25.00	\$4,750.00
Storm Drain Cleanout w/ Sump Pump and Piping to Curb	1	EA	\$10,000.00	\$10,000.00
Storm Drain Cleanout	2	EA	\$5,000.00	\$10,000.00
Catch Basin- 12" x 12"	7	EA	\$1,500.00	\$10,500.00
6" PVC Storm Drain Pipe	480	LF	\$30.00	\$14,400.00
Storm Drain Cleanout	1	EA	\$500.00	\$500.00
Stormwater Storage/ Infiltration System	1	LS	\$10,000.00	\$10,000.00

Sidewalk Under-Drain	0	LS	\$2,000.00	\$0.00
Traffic Signage	1	LS	\$1,000.00	\$1,000.00
Traffic Striping/Markings	1	LS	\$1,000.00	\$1,000.00
Station Striping/ Markings	1	LS	\$1,000.00	\$1,000.00
Site Amenities				
Prefab Bus Shelter (15' long by 5' wide)	3	EA	\$9,000.00	\$27,000.00
Prefab Shade Structure (30' long by 8' wide)	2	EA	\$32,350.00	\$64,700.00
Backed Bench	7	EA	\$1,350.00	\$9,450.00
Trash Receptical	7	EA	\$1,060.00	\$7,420.00
Tree Gate	18	EA	\$1,300.00	\$23,400.00
Bike Rack	9	EA	\$350.00	\$3,150.00
Signage Monument	1	LS	\$5,953.00	\$5,953.00
Sealwall with Pre-cast Concrete Cap	1	LS	\$20,000.00	\$20,000.00
Kiosk (2-sided)	2	EA	\$5,000.00	\$10,000.00
Landscaping/Irrigation				
Irrigation System	1	LS	\$70,500.00	\$70,500.00
Decomposed Granite with Weed Barrier	1	LS	\$34,000.00	\$34,000.00
Weed Abatement	1	LS	\$2,500.00	\$2,500.00
Soil Prep & Final Grading	23,500	SF	\$0.40	\$9,400.00
Trees with Root Barrier (24" Box)	33	EA	\$490.00	\$16,170.00
Shrubs (1 Gallon)	1,346	EA	\$8.00	\$10,768.00
Shrubs (5 Gallon)	163	EA	\$24.00	\$4,056.00
Electrical/ Lighting				
Handhole 14x20	6	EA	\$300.00	\$1,800.00
Handhole 2"x3"	1	EA	\$750.00	\$750.00
Type A - Tree Lights	36	EA	\$1,000.00	\$36,000
Conduit 1" PVC	1	LS	\$3,200.00	\$3,200.00
Conduit 3" PVC	1	LS	\$500.00	\$500.00
Cabel	1	LS	\$4,500.00	\$4,500.00

Trenching	1	LS	\$4,000.00	\$4,000.00
Secondary Pull Box	1	EA	\$300.00	\$300.00
All-In-One Pedestal	1	LS	\$7,000.00	\$7,000.00
Total - Construction Costs				\$840,430.00
Contingency (15%)				\$126,064.50
Total Construction				\$966,495

OFFSITE

Description	Quantity	Unit	Unit Price	Total
Demolition & Site Preparation				
Clearing & Grubbing	0.14	AC	\$5,000.00	\$689.00
Remove Conc Walk/Ramp/Driveway/Slab/Sidewalk	1,300	SF	\$2.00	\$2,600.00
Remove Conc Curb & Gutter	260	LF	\$2.00	\$520.00
Remove Light	3	ES	\$500.00	\$1,500.00
Remove Sign	1	ES	\$100.00	\$100.00
Remove Concrete Footings (49)	0	LS	\$1,000.00	\$0.00
Remove Chain Link Fence	500	LF	\$5.00	\$2,500.00
Remove Individual Fence Posts (3)	1	LS	\$500.00	\$500.00
Subgrade Preparation	19,500	SF	\$0.50	\$9,750.00
Survey Monument	2	EA	\$1,000.00	\$2,000.00
Site Improvements				
Vehicular Pavement (8" Conc)	176	CY	\$400.00	\$70,547.00
Parking Lot Pavement (4" Asphalt)	9	TON	\$120.00	\$1,037.00
Roadway Pavement (4" Asphalt)	139	TON	\$120.00	\$16,667.00
Plaza Pavement (4" Concrete)	34	CY	\$400.00	\$13,532.00
Sand Base (4")	34	CY	\$50.00	\$1,692.00
Aggregate Base	446	CY	\$65.00	\$29,012.00
Concrete Sidewalk	650	SF	\$10.00	\$6,500.00
Concrete Cross Gutter	1,125	SF	\$12.00	\$13,500.00
Concrete Curb & Gutter	170	LF	\$15.00	\$2,550.00
Concrete Curb	175	LF	\$12.00	\$2,100.00
Pedestrian Ramp	7	EA	\$2,500.00	\$17,500.00
Sidewalk Under-Drain	1	LS	\$2,000.00	\$2,000.00
Water Service/Meter/BFD	1	EA	\$7,000.00	\$7,000.00
Irrigation Service/Meter/BFD	1	EA	\$7,000.00	\$7,000.00
Sewer Lateral	1	LS	\$7,000.00	\$7,000.00

Sewer Cleanout

1	EA	\$200.00	\$200.00
0			

Site Amenities

2	EA	\$1,300.00	\$2,600.00
---	----	------------	------------

Landscaping/ Irrigation

2	EA	\$490.00	\$980.00
---	----	----------	----------

Electrical/ Lighting

4	EA	\$1,000.00	\$4,000.00
---	----	------------	------------

Total- Construction Costs

			\$225,576.00
--	--	--	--------------

Contingency (15%)

			\$33,836.00
--	--	--	-------------

Total Construction

			\$259,412.00
--	--	--	--------------