

DATE SUBMITTED 04/08/2025
 SUBMITTED BY COMMUNITY DEVELOPMENT DIRECTOR
 DATE ACTION REQUIRED 04/16/2025

COUNCIL ACTION (x)
 PUBLIC HEARING REQUIRED ()
 RESOLUTION ()
 ORDINANCE 1ST READING ()
 ORDINANCE 2ND READING ()
 CITY CLERK'S INITIALS ()

**IMPERIAL CITY COUNCIL
AGENDA ITEM**

SUBJECT: DISCUSSION/ACTION:
 ATEN BLVD. SIDEWALK INSTALLATION - PHASE I
 BETWEEN PROGRESS TRAIL & OLD SR-86 - CML-5134(031)
 1. ADOPT THE PLANS AND SPECIFICATIONS PREPARED FOR THIS PROJECT
 2. AUTHORIZATION TO SEEK BIDS

DEPARTMENT COMMUNITY DEVELOPMENT DEPARTMENT
 INVOLVED:

BACKGROUND/SUMMARY:

The Community Development Department was directed by City Council per Resolution 2024-10 (CC04-03-24) to submit an application requesting Federal Funds of the Congestion Mitigation and Air Quality (CMAQ) Improvement Program for the construction of new segments of PCC sidewalk, as well as the removal and replacement of three (3) handicap curb returns currently in poor conditions.

Afterwards, staff secured funds for \$150,000 composed from \$132,000 of said Federal Funds plus \$18,000 of Local Match (11.47% as stipulated in the application), and also worked on the preparation of the required improvement plans.

Now the Community Development Department is requesting City Council to adopt the plans and specifications prepared for this project and the authorization to seek bids from qualified contractors thru a competitive BID process for the construction of the project as illustrated in the Exhibit A, attached herewith, for details.

FISCAL IMPACT:

\$150,000 as follows:

\$132,000 from Federal Funds (CMAQ) &
 \$ 18,000 from LTA Measure "D"

ADMIN
 SERVICES
 SIGN INITIALS

JMS

STAFF RECOMMENDATION:

1. ADOPT THE PLANS AND SPECIFICATIONS PREPARED FOR THIS PROJECT.
2. AUTHORIZATION TO SEEK BIDS

DEPT.
 INITIALS

DM

MANAGER'S RECOMMENDATION:

approve

CITY
 MANAGER's
 INITIALS

JHM

MOTION:

SECONDED:

AYES:

NAYES:

ABSENT:

APPROVED ()

DISAPPROVED ()

REJECTED ()

DEFERRED ()

REFERRED TO:

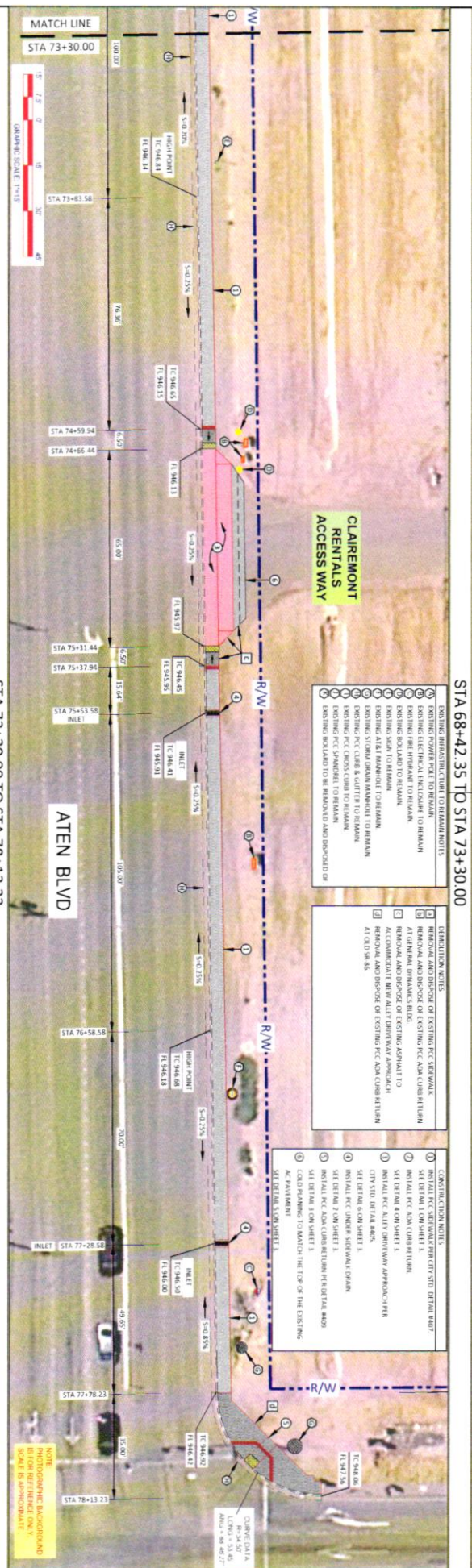

SHEET
2
OF 4 SHEETS

AND/OR RELOCATE AND PROTECT THE UTILITIES AND ALL OTHERS FROM INJURY OR DAMAGE INCLUDING, BUT NOT LIMITED TO, TRUCKS, STORAGE, TRAFFIC OBSTRUCTIONS, LIFTING, PLACING, REMOVING DEVICES, JOE COORDINATION AND SUPERVISION, ALL COORDINATION, EQUIPMENT, AND OTHER LABOR REQUIRED FOR OFFSHORE SHALL BE PROVIDED BY THE CONTRACTOR.

SPECIAL ADVERTISING SECTION 1997 U.S. SECTIONS 2304-2318 PLANNING TO ENRICHMENT AND GROWTH

Table 2 shows the effect of the different levels of feeding rate on the growth of the larvae. The larvae fed with 100 mg of dry weight per 100 mg of dry weight of the water (100 mg/100 mg) grew significantly faster than the larvae fed with 50 mg/100 mg and 25 mg/100 mg. The larvae fed with 100 mg/100 mg also had a significantly higher survival rate than the larvae fed with 50 mg/100 mg and 25 mg/100 mg. The larvae fed with 100 mg/100 mg also had a significantly higher survival rate than the larvae fed with 50 mg/100 mg and 25 mg/100 mg. The larvae fed with 100 mg/100 mg also had a significantly higher survival rate than the larvae fed with 50 mg/100 mg and 25 mg/100 mg.