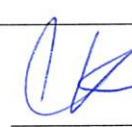
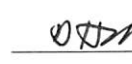

DATE SUBMITTED 08/11/21
 SUBMITTED BY Public Services
 DATE ACTION REQUIRED 08/18/21

COUNCIL ACTION ()
 PUBLIC HEARING REQUIRED ()
 RESOLUTION ()
 ORDINANCE 1ST READING ()
 ORDINANCE 2ND READING ()
 CITY CLERK'S INITIALS ab

**IMPERIAL CITY COUNCIL
 AGENDA ITEM**

SUBJECT: DISCUSSION/ACTION: WWTP Paving 1. Discuss, Approve/Disapprove pavement improvement at WWTP	
DEPARTMENT INVOLVED: Public Services – Wastewater Treatment Plant	
BACKGROUND/SUMMARY: The pavement east of the Influent Pump Station has been further damaged by construction activities. Rather than patch paving/replacing the damaged pavement, W.M. Lyles proposes to excavate, compact to 95% RC and fine grade the area highlighted in the attached Civil Drawing, along with providing a \$21,000 credit by contract deductive Change Order. WML has acquired the attached quote for the labor and material required for the 6" base course & 4" section of AC paving of the highlighted area from SLA Paving.	
FISCAL IMPACT: \$32,561.07 - \$21,000 = \$11,561.00 (WW Bond)	FINANCE INITIALS <u></u>
STAFF RECOMMENDATION: Approve	DEPT. INITIALS <u></u>
MANAGER'S RECOMMENDATION: <p style="text-align: center;"><i>approve</i></p>	CITY MANAGER'S INITIALS <u></u>
MOTION:	
SECONDED: AYES: NAYES: ABSENT:	APPROVED () REJECTED () DISAPPROVED () DEFERRED () REFERRED TO:

W. M. LYLES CO.
CONTRACTOR
Since 1945

Progress Through Performance

California Contractor's License No. 422390

Southern Division - **Temecula Office**
42142 Roick Drive
Temecula, CA 92590
Telephone (951) 973-7393
Fax (951) 698-3031

www.wmlyles.com
An Equal Opportunity Employer

Date: August 11, 2021

Owner: City of Imperial

Attn: Jackie Loper

Project: City of Imperial WWTP Upgrades Project

Subject: Proposal for the Repair of the Roadway East of the Imperial WWTP Influent Pump Station

Mr. Loper,

As discussed, the pavement east of the Influent Pump Station, while in a lesser state of disrepair when WML mobilized, has been further damaged by construction activities. We believe the following proposal is a fair and reasonable solution to the repair of the affected area.

Rather than patch paving/replacing the damaged pavement, WML proposes to excavate, compact to 95% RC and fine grade the area highlighted in the attached Civil Drawing, along with providing a \$21,000 credit by contract deductive Change Order. The City of Imperial would then contract with a local AC paving contractor of their choice to provide labor and material for the class II base course and pavement for the affected area.

In anticipation of a mutual agreement, WML has acquired the attached quote for the labor and material required for the 6" base course & 4" section of AC paving of the highlighted area from SLA Paving as a reference.

Please advise if this proposal is acceptable to the City.

Sincerely,



Jeff Tholen
Project Engineer
W. M. Lyles Co.

PNT	NORTHING	EASTING	ELEVATION	DESCRIPTION
1	9.78	440.48	934.82	MANUAL FLUSH*
2	-18.78	1174.34	935.40	MANUAL FLUSH*
3	207.84	477.08	933.12	2x2 W/MAD FLUSH*
4	1097.35	619.88	935.10	SCORE X FLUSH*
10	870.39	848.63	935.50	F00 DEWATERING BUILDING CORNER
11	854.80	822.03	935.50	F00 DEWATERING BUILDING CORNER
12	862.18	828.00	936.82	F00 MEMBER BUILDING CORNER
13	872.18	832.00	936.82	F00 MEMBER BUILDING CORNER
14	870.18	834.00	936.79	F00 KEATON BASIN CORNER

PNT	NORTHING	EASTING	ELEVATION	DESCRIPTION
15	872.18	782.02	936.12	F00 KEATON BASIN CORNER
16	868.33	782.02	935.00	F00 ORIT TRAP CORNER
17	844.33	811.02	935.00	F00 ORIT TRAP CORNER
18	841.32	833.22	936.00	GENERATOR PAD CORNER
19	828.82	850.22	936.00	GENERATOR PAD CORNER

* POINT NOT LOCATED ON SHEET.

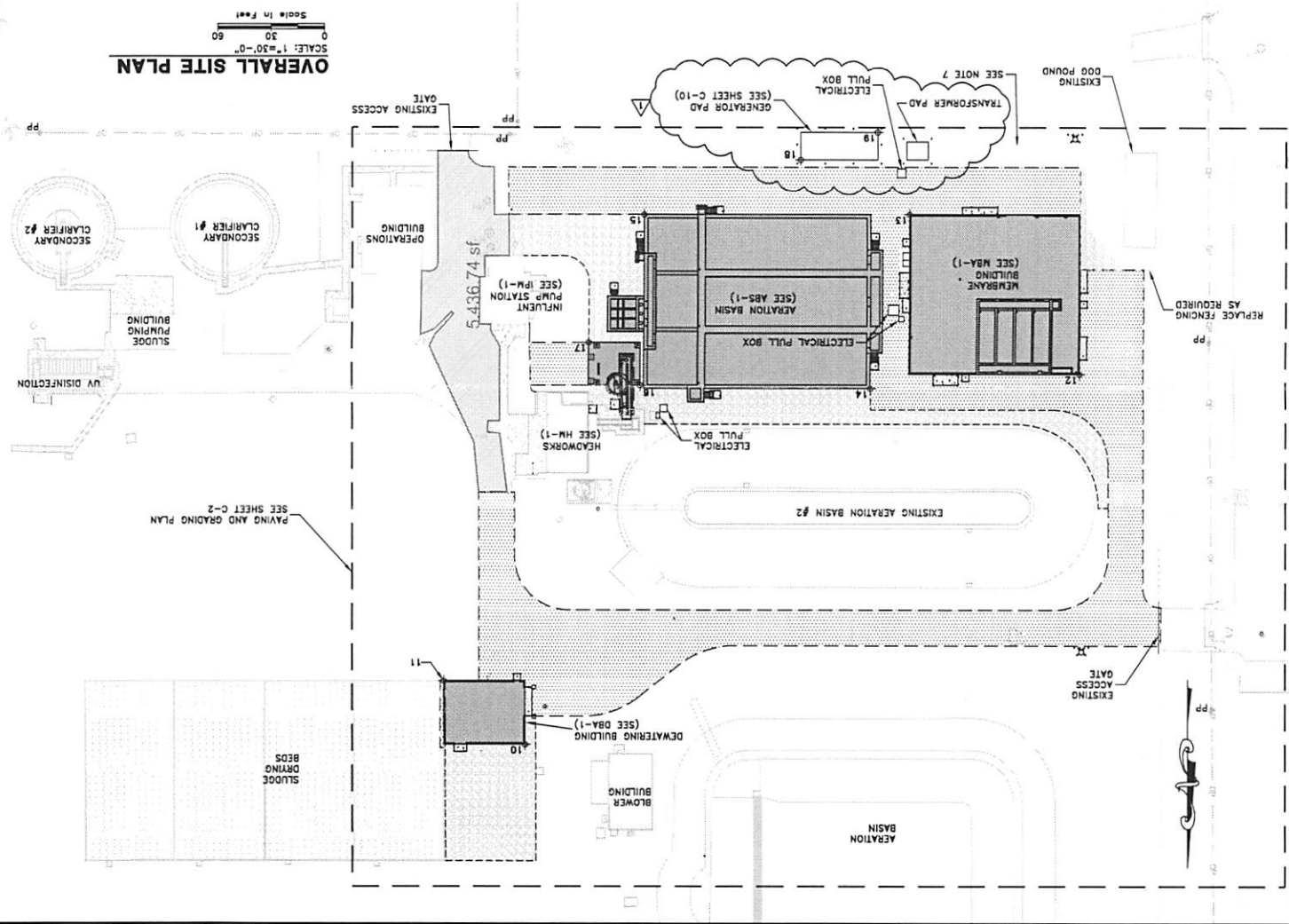

OVERALL SITE PLAN

- NOTES:
- SEE SECTION 01100 OF THE SPECIFICATIONS FOR DEMOLITION AND CONSTRUCTION WORK PHASING.
 - THE LOCATION OF EXISTING STRUCTURES AND UNDERGROUND FACILITIES (PIPING, VALVES, CONDUCTORS, ELECTRICAL CONDUIT, ETC.) ARE SHOWN IN AN APPROXIMATE WAY ONLY AND ARE BASED ON OWNERS EXISTING RECORDS. CONTRACTOR SHALL EXERCISE CARE DURING EXCAVATION TO AVOID DAMAGE TO SAID FACILITIES. CONTRACTOR SHALL DETERMINE THE EXACT LOCATION OF ALL EXISTING UNDERGROUND FACILITIES BEFORE COMMENCING WORK. CONTRACTOR AGREES TO BE FULLY RESPONSIBLE FOR ANY DAMAGES WHICH MIGHT BE OCCASIONED BY FAILURE TO EXACTLY LOCATE AND PROTECT ANY AND ALL FACILITIES.
 - AT LEAST 48 HOURS BEFORE COMMENCING ANY EXCAVATION, CONTRACTOR SHALL REQUEST UNDERGROUND SERVICE ALERT AND NON-MEMBER COMPANIES OR UTILITIES TO MARK OR OTHERWISE INDICATE THE LOCATION(S) OF THEIR SUBSURFACE FACILITIES INCLUDING, BUT NOT LIMITED TO STRUCTURES, VALVES, PIPING, VALVES, CONDUCTORS, CONDUITS, CABLES AND SERVICE CONNECTIONS.
 - AS FIRST ITEM OF WORK CONTRACTOR SHALL EXCAVATE AND EXPOSE EXISTING FACILITIES ARE PROPOSED TO ESTABLISH (POTHOLE) AND DETERMINE IF THERE WILL BE AN INTERFERENCE WITH NEW WORK. CONTRACTOR'S FAILURE TO PERFORM UPON LEARNING OF THE EXISTENCE OR LOCATION OF ANY UNDERGROUND FACILITY OMITTED OR SHOWN INCORRECTLY ON THESE DRAWINGS, OR IMPROPERLY MARKED OR OTHERWISE INDICATED, CONTRACTOR SHALL IMMEDIATELY NOTIFY THE OWNER, PROVIDING FULL DETAILS AS TO DEPTH, LOCATION, SIZE, AND FUNCTION.
 - EXISTING IMPROVEMENTS WHERE DAMAGED OR REMOVED BY CONSTRUCTION SHALL BE REPLACED IN ACCORDANCE WITH TECHNICAL SPECIFICATION SECTION 015300.
 - UNLESS NOTED OTHERWISE REGRADE ADJACENT TO NEW AND/OR IMPROVED STRUCTURE TO RESTORE GRADE AFTER WORK IS COMPLETED.
 - EXISTING FENCE WILL BE REMOVED BY OWNER PRIOR TO START OF CONSTRUCTION.

1/2" = FULL SCALE
1/4" = HALF SCALE
DRAWING IS TO SCALE IF BAR WEARS: 0 1/2 1

ALBERT A. CIVIL ENGINEERING
WEBB ASSOCIATES
REGISTERED PROFESSIONAL ENGINEERING CONSULTANTS
22000 RIVERSIDE CA 92706
TEL: 951-798-1529
FAX: 951-798-1528

AQUA ENGINEERING

CITY OF IMPERIAL
WASTEWATER TREATMENT PLANT UPGRADE
CIVIL
OVERALL SITE PLAN

NO.	DATE	REVISION	DRAWN	CHECKED
1	02/21/20	SR	DCH	JHL
C	10/04/18	REVISIONS	DCH	JHL

ORIGINAL

SLA Paving Inc.

CA License 919453, SB (Micro) Certification ID 2004743
 360 Ritter Ct, Imperial, CA 92251 - (760) 701-9011 office - (760) 332-0335 fax
 slapaving.com

Date:	06/24/21	Plans Drawn By:	N/A
Submitted To:	Jeff Tholen – W.M. Lyles Co.	Plans Dated:	N/A
From:	Seth Hoehl (760) 412-0134	Quote Number:	6777
Project:	Paving @ Imperial WWTP	Job Location:	Imperial, CA

Proposal

We propose to furnish and install all labor, material and equipment to perform the following items of work, subject to the terms and conditions stated hereon.

Item	Description	Amount
1	5,437 SF Import, install, and compact 6" of Class II base	\$10,169.76
2	5,437 SF Import, install, and compact 4" of hot mix asphalt	<u>\$22,391.31</u>
TOTAL:		\$32,561.07

*Non-prevailing wage rates

*Approved mix designs to be used

*Asphalt to be installed in two lifts

Terms and Conditions

- This proposal shall be considered withdrawn if not accepted within (30) thirty days. Payments due at time services are rendered.
- Unless expressly provided above, this quotation does not include: (a) permits, including any required fees or bonds; (b) engineering, testing or staking; (c) bond premiums; prevailing wages; adjusting or lifting utilities to grade.
- Unless expressly included in above listing of work to be done, unusual site conditions such as buried trash, concrete, abandoned utilities, mud, over optimum moisture content; unstable, pumping sub grade etc that were not apparent on the surface, shall be deemed cause for additional compensation, and cessation of work until agreement for same has been reached.
- If the work provided herein is not commenced within two months of acceptance, SLA Paving Inc. may elect not to be bound to perform.
- If suit is commenced to enforce any provision hereof or for damages for breach hereof, the accepting party will pay, in addition, reasonable attorneys' fees and costs, expenses of preparing and prosecuting such suit.
- One week written notice to commence this work provided herein will be given.
- SLA Paving Inc. is to perform according to lines and grades established by owner or his engineer, and assumes no responsibility for engineering, or drainage.
- In the event of rescission of this agreement by the accepting party prior to the commencement of work, SLA Paving Inc. will be paid as liquidated damages. On the account of extreme difficulty of ascertainment of actual damages, the sum will be equal to 20% of the total contract price. In the event of rescission following commencement of work, SLA Paving Inc. will be paid for work done and materials supplied, a percentage of the total contract price in proportion as the amount of such work and materials relates to the total job and also will be paid 20% of a sum computed by subtracting from the total contract price the sum owing for completed work and materials.
- Owner assumes all responsibility and shall notify SLA Paving Inc. in writing of the location and depth of all underground utilities.
- This agreement expresses the entire agreement between the parties. Changes shall be in writing signed by both parties.
- The above quantities are approximate. Payment will be based on the field measurement at the completion of the project.
- Proposal is based on plans identified above.

Acceptance of Proposal

 Name and Title

 Company Name

 Date

 Signature





