

Agenda Item No. D-6

DATE SUBMITTED 11/24/2021
 SUBMITTED BY COMMUNITY DEVELOPMENT DIRECTOR
 DATE ACTION REQUIRED 12/01/2021

COUNCIL ACTION (x)
 PUBLIC HEARING REQUIRED ()
 RESOLUTION ()
 ORDINANCE 1ST READING ()
 ORDINANCE 2ND READING ()
 CITY CLERK'S INITIALS em

**IMPERIAL CITY COUNCIL
 AGENDA ITEM**

SUBJECT: DISCUSSION/ACTION: LABOR COMPLIANCE CONSULTING SERVICES FOR 2ND STREET REHABILITATION AND RECONSTRUCTION PROJECT FROM OLD SR-86 TO "P" STREET (RFP No. P2021-08) 1. Award contract for labor compliance consulting services to "Labor Compliance Consultants of Southern California LLC"	
DEPARTMENT INVOLVED: COMMUNITY DEVELOPMENT DEPARTMENT	
BACKGROUND/SUMMARY: The Community Development Department was directed by City Council to conduct a competitive BID process for the 2nd Street Rehabilitation and Reconstruction Project from Old SR-86 to "P" Street. See Exhibit 1 attached herewith for details. The project is funded by Caltrans STBG (Surface Transportation Block Grant) Program. LTA Measure D funds will be used to leverage the federal funds for the construction of the project. This labor compliance consulting services contract is to monitor and enforce compliance with federal and/or State prevailing wage laws on public works projects and it's required by Caltrans as part of the process to confirm the construction is in conformance with said laws. The City sent out this RFP to eight (8) firms and received one proposal: 1. Labor Compliance Consultants of Southern California LLC - \$7,200.00	
FISCAL IMPACT: \$7,200.00 from STBG 5134(024) and LTA Measure D	ADMIN SERVICES SIGN INITIALS <u>J.A.</u>
STAFF RECOMMENDATION: Staff recommends City Council award a contract for labor compliance consulting services to "Labor Compliance Consultants of Southern California LLC" in the amount of \$7,200.00.	DEPT. INITIALS <u>OM</u>
MANAGER'S RECOMMENDATION: <u>approve</u>	CITY MANAGER'S INITIALS <u>[Signature]</u>
MOTION: SECONDED: APPROVED () REJECTED () AYES: DISAPPROVED () DEFERRED () NAYES: ABSENT: REFERRED TO:	

EXHIBIT 1

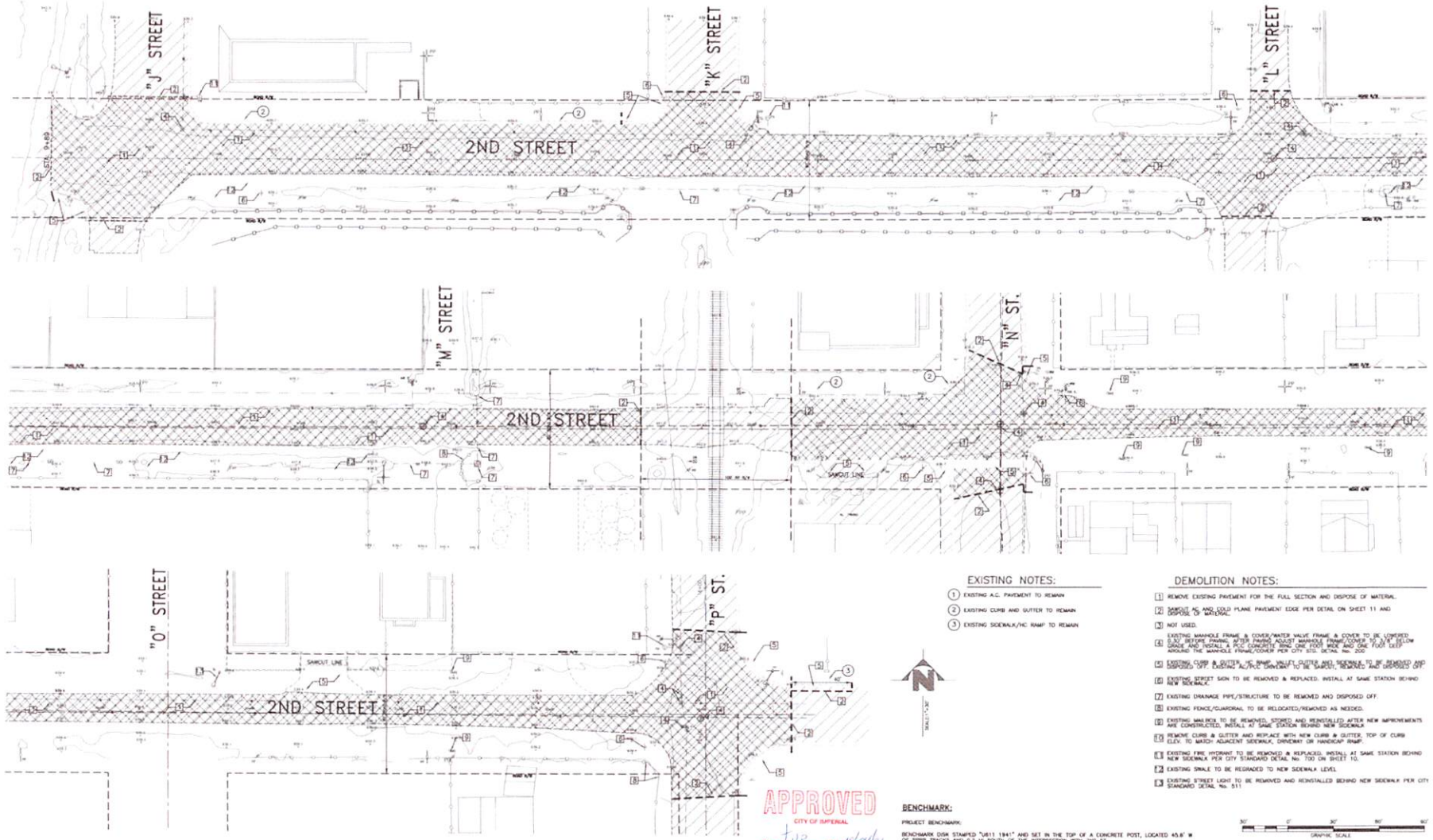

- EXISTING NOTES:**
- 1 EXISTING A.C. PAVEMENT TO REMAIN
 - 2 EXISTING CURB AND GUTTER TO REMAIN
 - 3 EXISTING SIDEWALK/HC RAMP TO REMAIN

- DEMOLITION NOTES:**
- 1 REMOVE EXISTING PAVEMENT FOR THE FULL SECTION AND DISPOSE OF MATERIAL.
 - 2 REMOVE A.C. AND COLD PLANE PAVEMENT EDGE PER DETAIL ON SHEET 11 AND DISPOSE OF MATERIAL.
 - 3 NOT USED.
 - 4 EXISTING MANHOLE FRAME & COVER/WATER VALVE FRAME & COVER TO BE LOWERED 6.0' BELOW FINISH GRADE AFTER FINISH ADJUST MANHOLE FRAME COVER PER CITY SPEC. AND INSTALL A 6" CONCRETE RING ONE FOOT HIGH AND ONE FOOT IN DIAMETER AROUND THE MANHOLE FRAME/COVER PER CITY SPEC. DETAIL No. 202.
 - 5 EXISTING CURB AND GUTTER TO BE REMOVED, REGRADE AND REINSTALLED OFF.
 - 6 EXISTING STREET SIGN TO BE REMOVED & REPLACED INSTAL AT SAME STATION BEHIND NEW SIDEWALK.
 - 7 EXISTING DRAINAGE PIPE/STRUCTURE TO BE REMOVED AND DISPOSED OFF.
 - 8 EXISTING FENCE/GUARDRAIL TO BE RELOCATED/REMOVED AS NEEDED.
 - 9 EXISTING WALKWAY TO BE REMOVED, STORED AND REINSTALLED AFTER NEW IMPROVEMENTS ARE CONSTRUCTED. INSTAL AT SAME STATION BEHIND NEW SIDEWALK.
 - 10 REMOVE CURB & GUTTER AND REPLACE WITH NEW CURB & GUTTER. TOP OF CURB ELEV. TO MATCH ADJACENT SIDEWALK, DRIVEWAY OR HANDICAP RAMP.
 - 11 EXISTING FIRE HYDRANT TO BE REMOVED & REPLACED INSTAL AT SAME STATION BEHIND NEW SIDEWALK PER CITY STANDARD DETAIL No. 100 ON SHEET 10.
 - 12 EXISTING SIGNAL TO BE REGRADED TO NEW SIDEWALK LEVEL.
 - 13 EXISTING STREET LIGHT TO BE REMOVED AND REINSTALLED BEHIND NEW SIDEWALK PER CITY STANDARD DETAIL No. 811.

APPROVED

CITY OF IMPERIAL

BY: *JOP* DATE: 10/01/21

BENCHMARK:
PROJECT BENCHMARK:
BENCHMARK DGM STATIONED 7811 1941' AND SET IN THE TOP OF A CONCRETE POST, LOCATED 45.8' W OF SPUR TRACKS AND 0.2' W SOUTH OF THE INTERSECTION WITH 2ND ST.
E.L. = 940.38'



No.	DESCRIPTION	BY	DATE
1	CITY OF IMPERIAL PLAN CHECK 7/02/21	SMF	7/06/21
2	CITY OF IMPERIAL PLAN CHECK 8/04/21	STAF	8/08/21
3	CITY OF IMPERIAL PLAN CHECK 9/10/21	STAF	9/15/21
4	CITY OF IMPERIAL PLAN CHECK 9/17/21	STAF	9/21/21
5	CITY OF IMPERIAL PLAN CHECK 9/22/21	SMF	9/28/21

APPROVED BY PUBLIC SERVICES DIRECTOR
CITY OF IMPERIAL, CA

BY: *Jackie Lopez* DATE: 10/1/21
JACKIE LOPEZ

ENGINEER OF RECORD
PLANS PREPARED UNDER THE SUPERVISION OF

BY: *Carlos Corrales* DATE: 10/1/21
CARLOS CORRALES

R.C.E. NO.: 55432

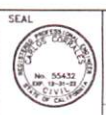

LC ENGINEERING CONSULTANTS INC.
CIVIL ENGINEER/PLANNING/CONSTRUCTION MANAGEMENT SERVICES
4055 State Street
El Centro CA 92543

DATE: OCTOBER 01, 2021 BENCHMARK: SEE SHEET NO. 1

CITY OF IMPERIAL
**IMPROVEMENT PLANS
TOPO & DEMOLITION PLAN**
2ND STREET REHABILITATION AND CONSTRUCTION
FROM OLD SR 86 TO 1ST STREET

SHEET
2 OF
13 SHEETS
JOB NO.
G20029-00

C:\ProgramData\LC\2021\G20029-00_001.dwg - Imperial 2nd Street - msc\LC\Engineering\mcs\G20029-00_001.dwg - 10/01/2021 11:05AM

EXHIBIT 1

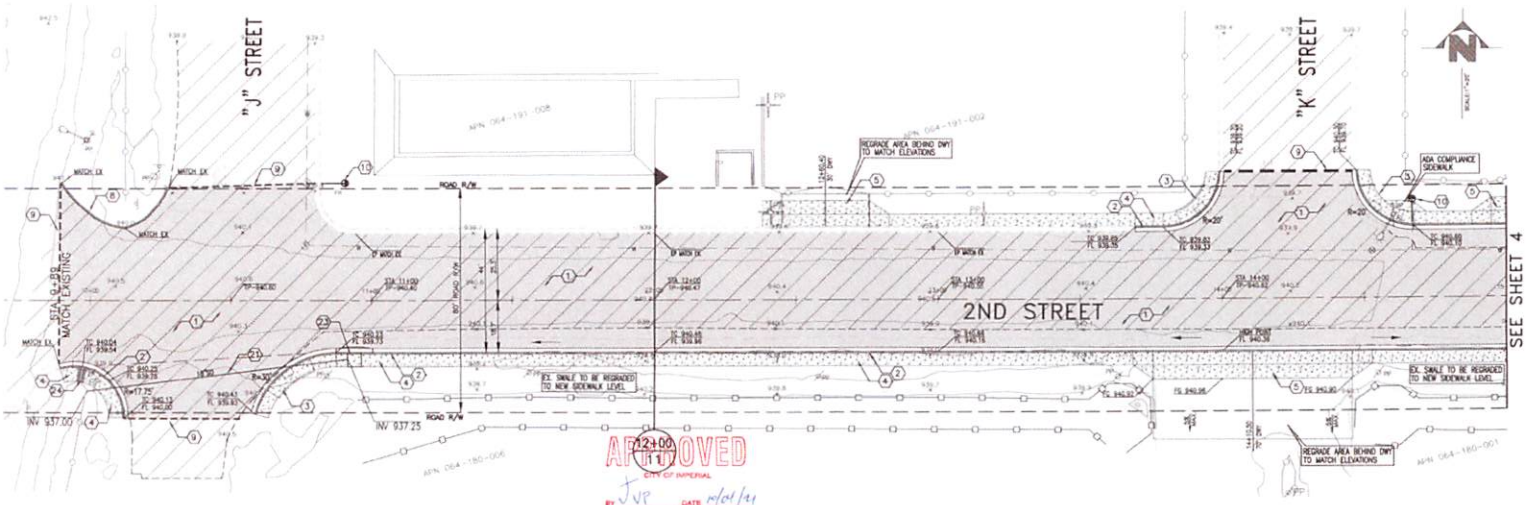
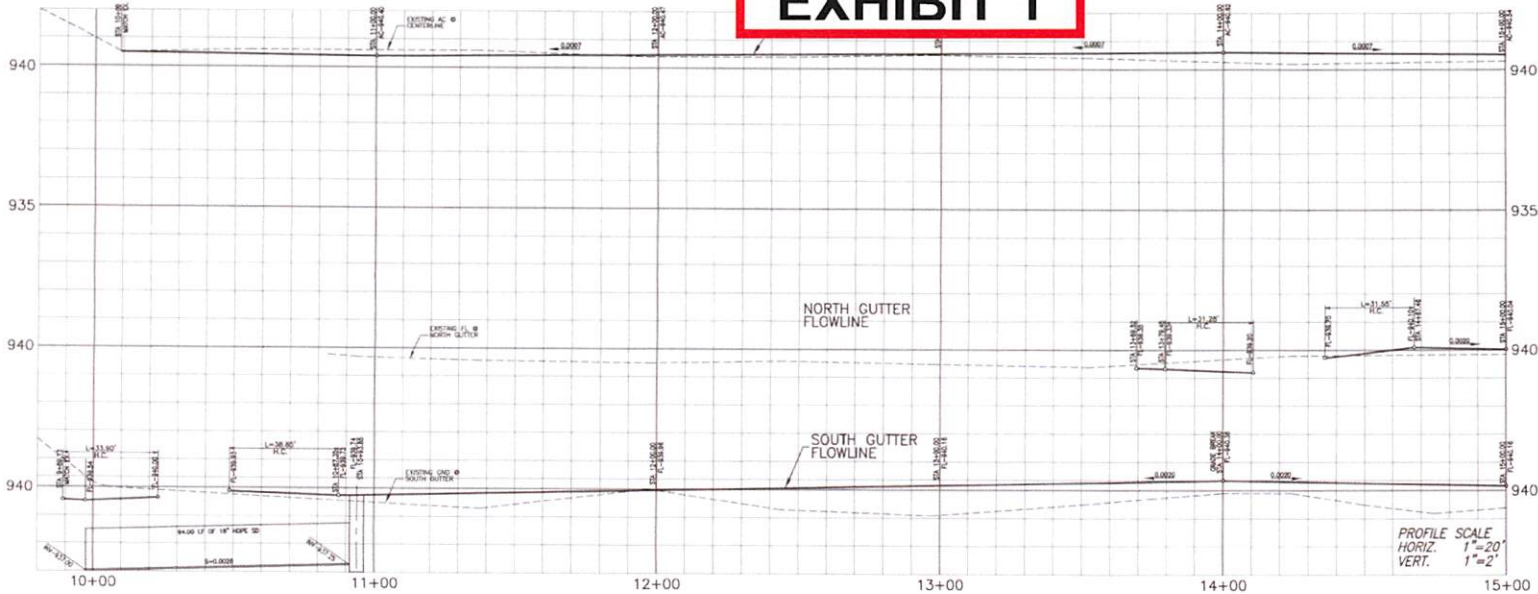

CONSTRUCTION KEYNOTES:

- 1 NEW 4" OF AC PAVEMENT OVER 18" OF CLASS 2 BASE
- 2 NEW 6" PCC CURB & GUTTER PER CITY OF IMPERIAL DET. NO. 400
- 3 NEW ADA HANDICAP RAMP PER CITY OF IMPERIAL DET. NO. 409-B
- 4 NEW ADA HANDICAP RAMP PER CITY OF IMPERIAL DET. NO. 409
- 5 NEW 4" PCC SIDEWALK PER CITY OF IMPERIAL DET. NO. 407
- 6 NEW PCC DRIVEWAY APPROACH PER CITY OF IMPERIAL DET. NO. 403
- 6 NEW PCC SPANDREL PER CITY OF IMPERIAL DET. NO. 410
- 7 NEW 6" PCC CROSS GUTTER PER DETAIL ON SHEET 11
- 8 NEW 6" PCC BARRIER CURB PER CITY OF IMPERIAL DET. NO. 401
- 9 SAWCUT AC AND COLD PLANE PAVEMENT EDGE PER DETAIL ON SHEET 11 AND GEODIC OF MATERIAL
- 10 NEW FIRE HYDRANT ASSEMBLY PER CITY OF IMPERIAL DET. NO. 700
- 11 NOT USED.
- 12 NEW 12" DIA. ADS 11-12 HOPE PIPE FOR STORM DRAIN PER CITY OF IMPERIAL STD. DET. NO. 515
- 13 NEW 18" DIA. ADS 11-12 HOPE PIPE FOR STORM DRAIN PER CITY OF IMPERIAL STD. DET. NO. 515
- 14 NEW 34" DIA. ADS 11-12 HOPE PIPE FOR STORM DRAIN PER DETAIL ON SHEET 12
- 15 NEW S.D. CATCH BASIN PER DETAIL ON SHEET 11
- 16 NEW UNDERGUTTER DRAIN PER DETAIL ON SHEET 11
- 17 NEW 28"x28" CATCH BASIN PER DETAIL ON SHEET 11

- NOTES:**
- 1- WHEN COVER ON TOP OF PIPES IS LESS THAN 36" (INCHES) SLURRY SHOULDER SHALL BE USED.
 - 2- EXISTING MANHOLE FRAME & COVER/WATER VALVE FRAME & COVER TO BE LOWERED 0.30' BEFORE PAVING, AFTER PAVING ADJUST MANHOLE FRAME/COVER TO 3/8" BELOW GRADE AND INSTALL A PCC CONCRETE DRG. ONE FOOT WIDE AND ONE FOOT DEEP AROUND THE MANHOLE FRAME/COVER PER CITY STD. DET. NO. 200.



UNDERGROUND SERVICE ALERT
CALL TOLL FREE
811
TWO WORKING DAYS
BEFORE YOU DIG

No.	DESCRIPTION	BY	DATE
1	CITY OF IMPERIAL PLAN CHECK 7/02/21	STAFF	7/02/21
2	CITY OF IMPERIAL PLAN CHECK 8/04/21	STAFF	8/04/21
3	CITY OF IMPERIAL PLAN CHECK 9/10/21	STAFF	9/10/21
4	CITY OF IMPERIAL PLAN CHECK 9/17/21	STAFF	9/17/21
5	CITY OF IMPERIAL PLAN CHECK 9/22/21	STAFF	9/22/21

APPROVED BY PUBLIC SERVICES DIRECTOR
CITY OF IMPERIAL, CA
BY: *JACKIE LOFFER* DATE: 10/21/21

ENGINEER OF RECORD
PLANS PREPARED UNDER THE SUPERVISION OF
BY: *Carlos Corrales* DATE: 10/21/21
CARLOS CORRALES
R.C.E. NO.: 55432

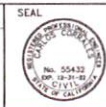

LC ENGINEERING CONSULTANTS INC.
CIVIL ENGINEERING-CONSTRUCTION MANAGEMENT SERVICES
406 State Street
EJ Condo CA 92543
DATE: OCTOBER 01, 2021 BENCHMARK: SEE SHEET NO. 1

CITY OF IMPERIAL
IMPROVEMENT PLANS
PLAN & PROFILE
2ND STREET REHABILITATION AND CONSTRUCTION
FROM OLD SR-86 TO T^H STREET
SHEET 3 OF 13 SHEETS
JOB NO. C20029-00

EXHIBIT 1

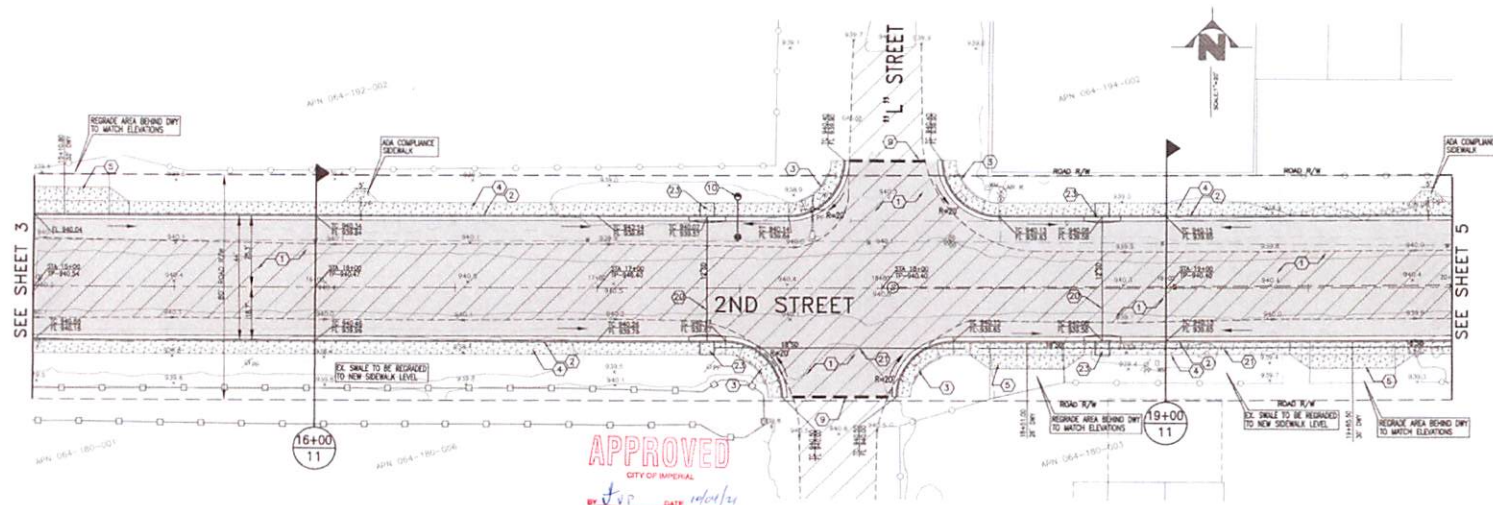
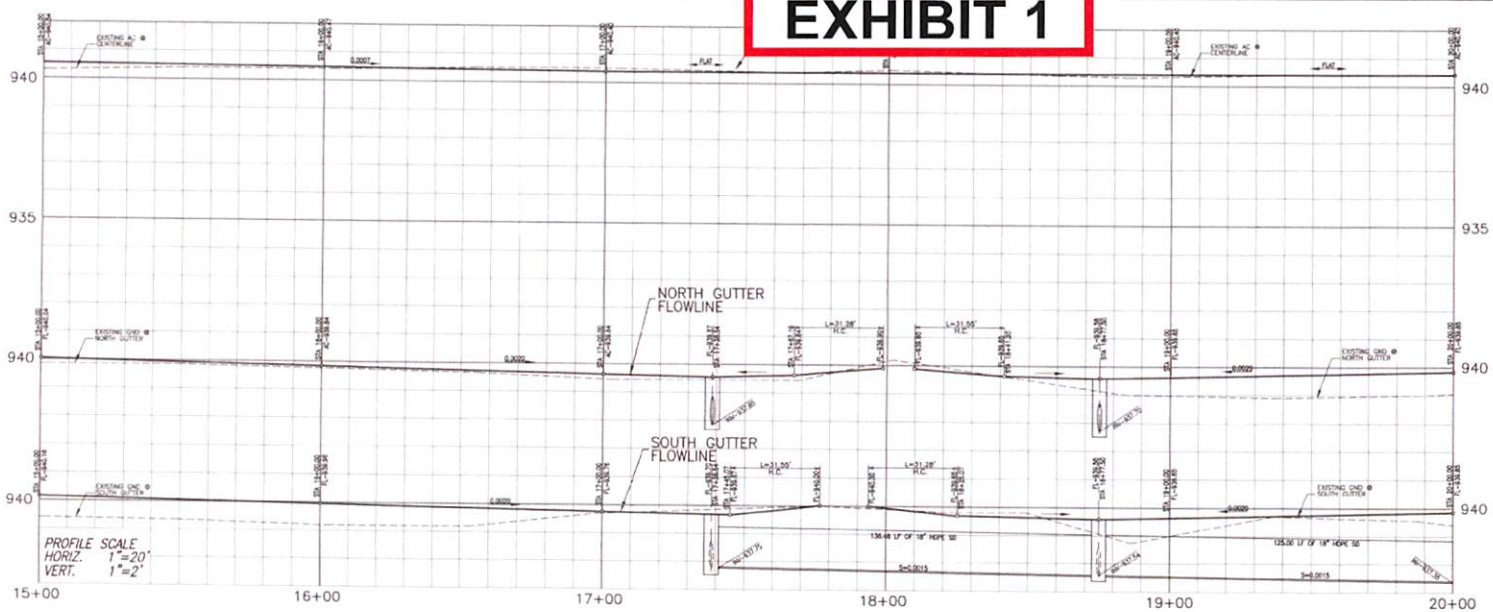

- CONSTRUCTION KEYNOTES:**
- 1 NEW 4" OF AC PAVEMENT OVER 18" OF CLASS 2 BASE
 - 2 NEW 6" PCC CURB & GUTTER PER CITY OF IMPERIAL DET. No. 400
 - 3 NEW ADA HANDCAP RAMP PER CITY OF IMPERIAL DET. No. 409-B
 - 3A NEW ADA HANDCAP RAMP PER CITY OF IMPERIAL DET. No. 409
 - 4 NEW 4" PCC SIDEWALK PER CITY OF IMPERIAL DETAL No. 407
 - 5 NEW PCC DRIVEWAY APPROACH PER CITY OF IMPERIAL DET. No. 403
 - 6 NEW PCC SPANDREL PER CITY OF IMPERIAL DET. No. 410
 - 7 NEW 6" PCC CROSS GUTTER PER DETAL ON SHEET 11
 - 8 NEW 6" PCC BARRIER CURB PER CITY OF IMPERIAL DET. No. 401
 - 9 SANICUT AC AND COLD PLANE PAVEMENT EDGE PER DETAL ON SHEET 11 AND DISPOSE OF MATERIAL
 - 10 NEW FIRE HYDRANT ASSEMBLY PER CITY OF IMPERIAL DETAL No. 700
 - 11 NOT USED.
 - 20 NEW 12" DIA ADS N-12 HOPE PIPE FOR STORM DRAIN PER CITY OF IMPERIAL STDS DETAL No. 513
 - 21 NEW 18" DIA ADS N-12 HOPE PIPE FOR STORM DRAIN PER CITY OF IMPERIAL STDS DETAL No. 513
 - 22 NEW 24" DIA ADS N-12 HOPE PIPE FOR STORM DRAIN PER DETAL ON SHEET 12
 - 23 NEW S.O. CATCH BASIN PER DETAL ON SHEET 11
 - 24 NEW UNDERDRAIN DRAIN PER DETAL ON SHEET 11
 - 25 NEW 20"x20" CATCH BASIN PER DETAL ON SHEET 11
- NOTES:**
- 1- WHEN COVER ON TOP OF PIPES IS LESS THAN 36" (INCHES) SLURRY SHOULDER SHALL BE USED.
 - 2- EXISTING MANHOLE FRAME & COVER/WATER VALVE FRAME & COVER TO BE LOWERED 0.30' BEFORE PAVING, AFTER PAVING ADJUST MANHOLE FRAME/COVER TO 3/8" BELOW GRADE AND INSTALL A PCC CONCRETE RING ONE FOOT WIDE AND ONE FOOT DEEP AROUND THE MANHOLE FRAME/COVER PER CITY STD. DETAL No. 200.

APPROVED

CITY OF IMPERIAL

BY: *J. Lopez* DATE: 10/1/21

<p>UNDERGROUND SERVICE ALERT</p> <p>CALL TOLL FREE 811</p> <p>TWO WORKING DAYS BEFORE YOU DIG</p>	<table border="1" style="width: 100%; border-collapse: collapse;"> <thead> <tr> <th>No.</th> <th>DESCRIPTION</th> <th>BY</th> <th>DATE</th> </tr> </thead> <tbody> <tr> <td>1</td> <td>CITY OF IMPERIAL PLAN CHECK 7/02/21</td> <td>STAFF</td> <td>7/02/21</td> </tr> <tr> <td>2</td> <td>CITY OF IMPERIAL PLAN CHECK 8/04/21</td> <td>STAFF</td> <td>8/04/21</td> </tr> <tr> <td>3</td> <td>CITY OF IMPERIAL PLAN CHECK 9/10/21</td> <td>STAFF</td> <td>9/10/21</td> </tr> <tr> <td>4</td> <td>CITY OF IMPERIAL PLAN CHECK 9/17/21</td> <td>STAFF</td> <td>9/17/21</td> </tr> <tr> <td>5</td> <td>CITY OF IMPERIAL PLAN CHECK 9/22/21</td> <td>STAFF</td> <td>9/22/21</td> </tr> </tbody> </table>	No.	DESCRIPTION	BY	DATE	1	CITY OF IMPERIAL PLAN CHECK 7/02/21	STAFF	7/02/21	2	CITY OF IMPERIAL PLAN CHECK 8/04/21	STAFF	8/04/21	3	CITY OF IMPERIAL PLAN CHECK 9/10/21	STAFF	9/10/21	4	CITY OF IMPERIAL PLAN CHECK 9/17/21	STAFF	9/17/21	5	CITY OF IMPERIAL PLAN CHECK 9/22/21	STAFF	9/22/21	<p>APPROVED BY PUBLIC SERVICES DIRECTOR</p> <p>CITY OF IMPERIAL, CA</p> <p>BY: <i>J. Lopez</i> DATE: 10-1-21</p> <p>JACQUE LEWER</p>	<p>ENGINEER OF RECORD</p> <p>PLANS PREPARED UNDER THE SUPERVISION OF</p> <p>BY: <i>Carlos Corrales</i> DATE: 10/01/2021</p> <p>CARLOS CORRALES</p> <p>R.C.E. NO.: 55432</p>	<p>SEAL</p>	<p>LC ENGINEERING CONSULTANTS INC.</p> <p>CIVIL ENGINEERING - LAND SURVEYING - CONSTRUCTION MANAGEMENT SERVICES</p> <p>1406 5th Street Escondido, CA 92025</p> <p>DATE: OCTOBER 01, 2021 BENCHMARK: SEE SHEET NO. 1</p>	<p>CITY OF IMPERIAL</p> <p style="text-align: center;">IMPROVEMENT PLANS PLAN & PROFILE</p> <p>2ND STREET REHABILITATION AND CONSTRUCTION FROM OLD SR-66 TO 7th STREET</p>	<p>SHEET</p> <p style="text-align: center;">4 OF 13 SHEETS</p> <p>JOB NO. G20029-00</p>
No.	DESCRIPTION	BY	DATE																												
1	CITY OF IMPERIAL PLAN CHECK 7/02/21	STAFF	7/02/21																												
2	CITY OF IMPERIAL PLAN CHECK 8/04/21	STAFF	8/04/21																												
3	CITY OF IMPERIAL PLAN CHECK 9/10/21	STAFF	9/10/21																												
4	CITY OF IMPERIAL PLAN CHECK 9/17/21	STAFF	9/17/21																												
5	CITY OF IMPERIAL PLAN CHECK 9/22/21	STAFF	9/22/21																												

EXHIBIT 1

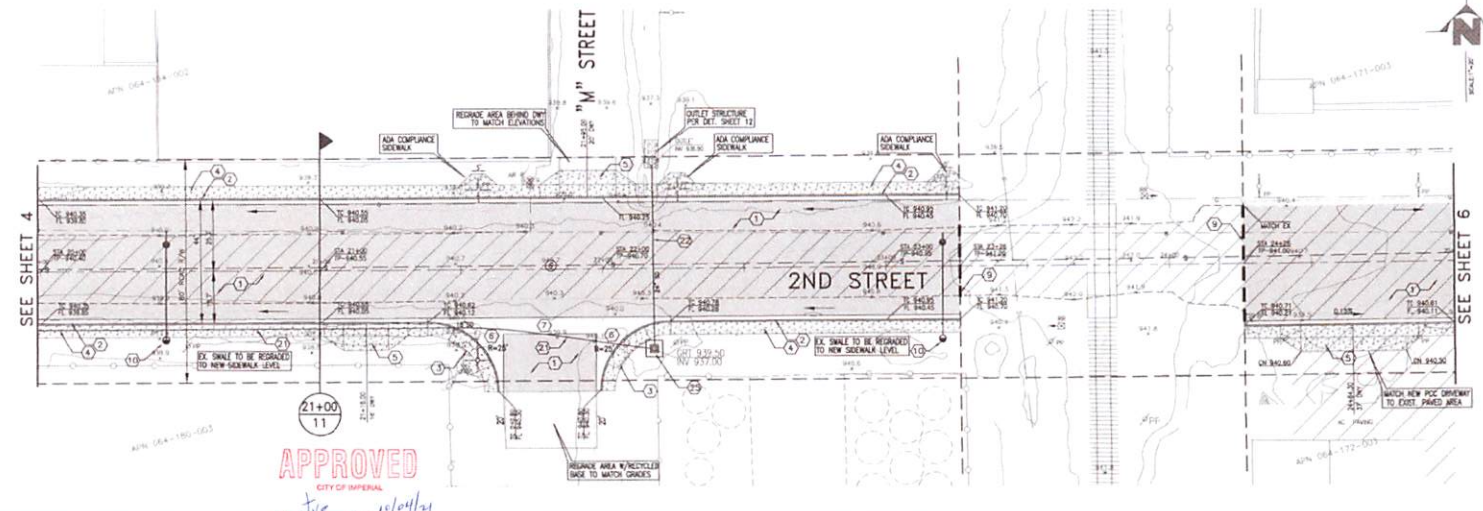
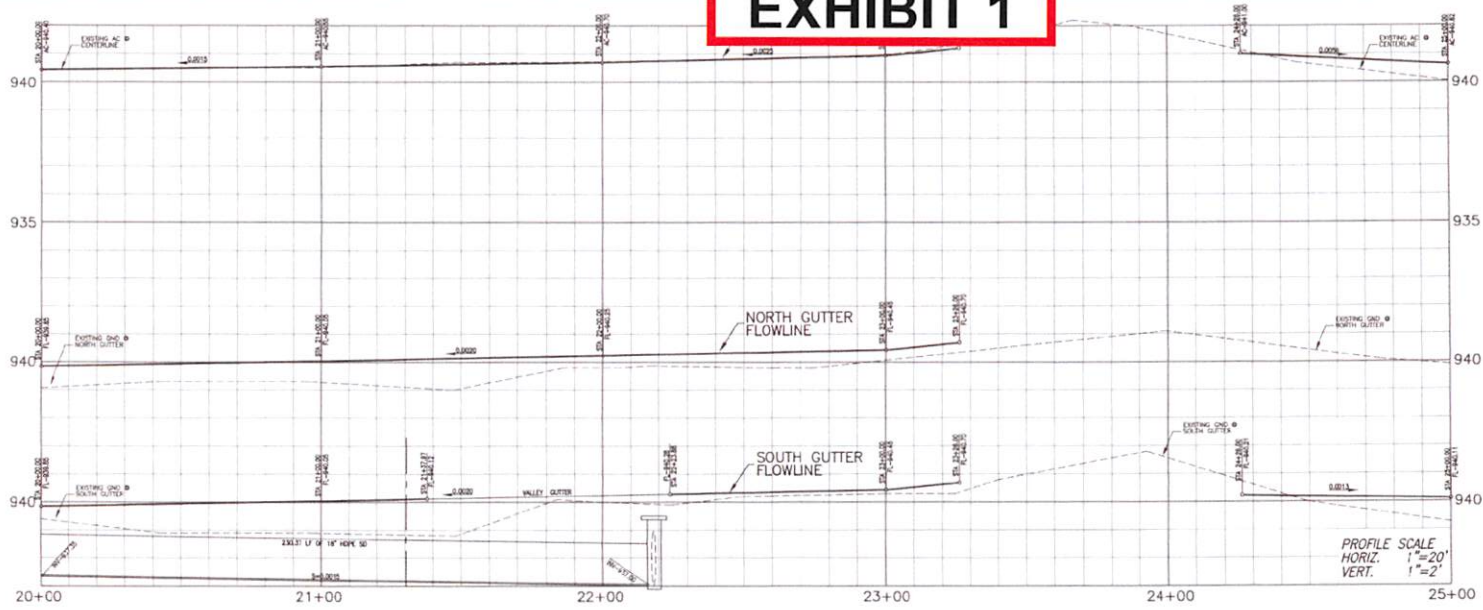

- CONSTRUCTION KEYNOTES:**
- 1 NEW 4" OF AC PAVEMENT OVER 10" OF CLASS 2 BASE.
 - 2 NEW 6" PCC CURB & GUTTER PER CITY OF IMPERIAL DET. NO. 403
 - 3 NEW ADA HANDICAP RAMP PER CITY OF IMPERIAL DET. NO. 409-E
 - 4A NEW ADA HANDICAP RAMP PER CITY OF IMPERIAL DET. NO. 409
 - 4 NEW 4" PCC SIDEWALK PER CITY OF IMPERIAL DET. NO. 407
 - 5 NEW PCC DRIVEWAY APPROACH PER CITY OF IMPERIAL DET. NO. 433
 - 6 NEW PCC SPANDREL PER CITY OF IMPERIAL DET. NO. 410
 - 7 NEW 6" PCC CROSS GUTTER PER DETAIL ON SHEET 11
 - 8 NEW 6" PCC BARRIER CURB PER CITY OF IMPERIAL DET. NO. 401
 - 9 REMOVE AC AND COLD PLANE PAVEMENT EDGE PER DETAIL ON SHEET 11 AND DISPOSE OF MATERIAL.
 - 10 NEW FIRE HYDRANT ASSEMBLY PER CITY OF IMPERIAL DETAIL NO. 700
 - 11 NOT USED.
 - 12 NEW 12" DIA. ADS N-12 HDPE PIPE FOR STORM DRAIN PER CITY OF IMPERIAL STD. DETAIL NO. 513
 - 21 NEW 18" DIA. ADS N-12 HDPE PIPE FOR STORM DRAIN PER CITY OF IMPERIAL STD. DETAIL NO. 513
 - 22 NEW 24" DIA. ADS N-12 HDPE PIPE FOR STORM DRAIN PER DETAIL ON SHEET 11
 - 23 NEW S.O. CATCH BASIN PER DETAIL ON SHEET 11
 - 24 NEW UNDERSEWALK DRAIN PER DETAIL ON SHEET 11
 - 25 NEW 26"X26" CATCH BASIN PER DETAIL ON SHEET 11
- NOTES:**
- 1- WHEN COVER ON TOP OF PIPES IS LESS THAN 36" (INCHES) SLURRY BACKFILL SHALL BE USED.
 - 2- EXISTING MANHOLE FRAME & COVER/WATER VALVE FRAME & COVER TO BE LOWERED 6" BEFORE PAVING. AFTER PAVING ADJUST MANHOLE FRAME/COVER TO 3/8" BELOW GRADE AND INSTALL A PCC CONCRETE RING ONE FOOT HIGH AND ONE FOOT DEEP AROUND THE MANHOLE FRAME/COVER PER CITY STD. DETAIL NO. 200.

	UNDERGROUND SERVICE ALERT CALL TOLL FREE 811	TWO WORKING DAYS BEFORE YOU DIG	<table border="1" style="width: 100%; border-collapse: collapse;"> <thead> <tr> <th>No.</th> <th>DESCRIPTION</th> <th>BY</th> <th>DATE</th> </tr> </thead> <tbody> <tr> <td>1</td> <td>CITY OF IMPERIAL PLAN CHECK 7/02/21</td> <td>STAFF</td> <td>7/02/21</td> </tr> <tr> <td>2</td> <td>CITY OF IMPERIAL PLAN CHECK 8/04/21</td> <td>STAFF</td> <td>8/04/21</td> </tr> <tr> <td>3</td> <td>CITY OF IMPERIAL PLAN CHECK 9/10/21</td> <td>STAFF</td> <td>9/10/21</td> </tr> <tr> <td>4</td> <td>CITY OF IMPERIAL PLAN CHECK 9/17/21</td> <td>STAFF</td> <td>9/17/21</td> </tr> <tr> <td>5</td> <td>CITY OF IMPERIAL PLAN CHECK 9/22/21</td> <td>STAFF</td> <td>9/22/21</td> </tr> </tbody> </table>	No.	DESCRIPTION	BY	DATE	1	CITY OF IMPERIAL PLAN CHECK 7/02/21	STAFF	7/02/21	2	CITY OF IMPERIAL PLAN CHECK 8/04/21	STAFF	8/04/21	3	CITY OF IMPERIAL PLAN CHECK 9/10/21	STAFF	9/10/21	4	CITY OF IMPERIAL PLAN CHECK 9/17/21	STAFF	9/17/21	5	CITY OF IMPERIAL PLAN CHECK 9/22/21	STAFF	9/22/21	APPROVED BY PUBLIC SERVICES DIRECTOR CITY OF IMPERIAL, CA BY: <i>J. Lopez</i> DATE: 10/4/21 JACKIE LOPEZ	ENGINEER OF RECORD PLANS PREPARED UNDER THE SUPERVISION OF BY: <i>Carlos Corrales</i> DATE: 10/4/21 CARLOS CORRALES R.C.E. NO.: 55432	SEAL 	LC ENGINEERING CONSULTANTS INC. CIVIL ENGINEERING • LAND SURVEYING • INFRASTRUCTURE MANAGEMENT SERVICES 1005 State Street El Centro CA 92543 DATE: OCTOBER 01, 2021 BENCHMARK: SEE SHEET NO. 1	CITY OF IMPERIAL IMPROVEMENT PLANS PLAN & PROFILE 2ND STREET REHABILITATION AND CONSTRUCTION FROM OLD SR-88 TO 7th STREET	SHEET 5 OF 13 SHEETS SHEET NO. C20029-09
	No.	DESCRIPTION	BY	DATE																													
1	CITY OF IMPERIAL PLAN CHECK 7/02/21	STAFF	7/02/21																														
2	CITY OF IMPERIAL PLAN CHECK 8/04/21	STAFF	8/04/21																														
3	CITY OF IMPERIAL PLAN CHECK 9/10/21	STAFF	9/10/21																														
4	CITY OF IMPERIAL PLAN CHECK 9/17/21	STAFF	9/17/21																														
5	CITY OF IMPERIAL PLAN CHECK 9/22/21	STAFF	9/22/21																														

EXHIBIT 1

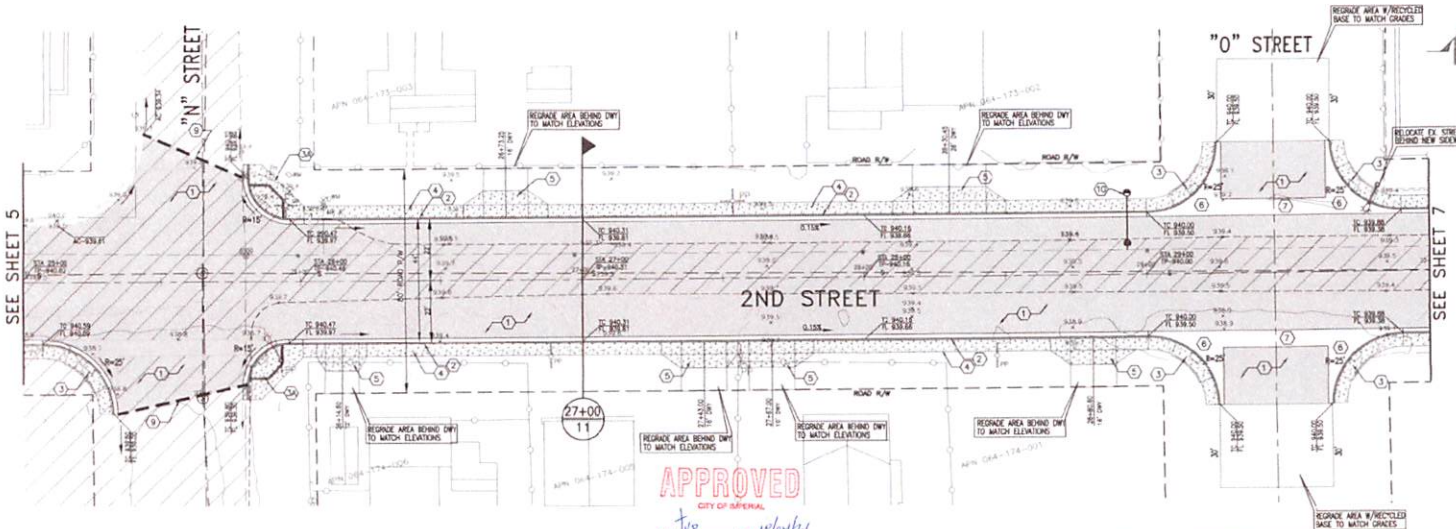
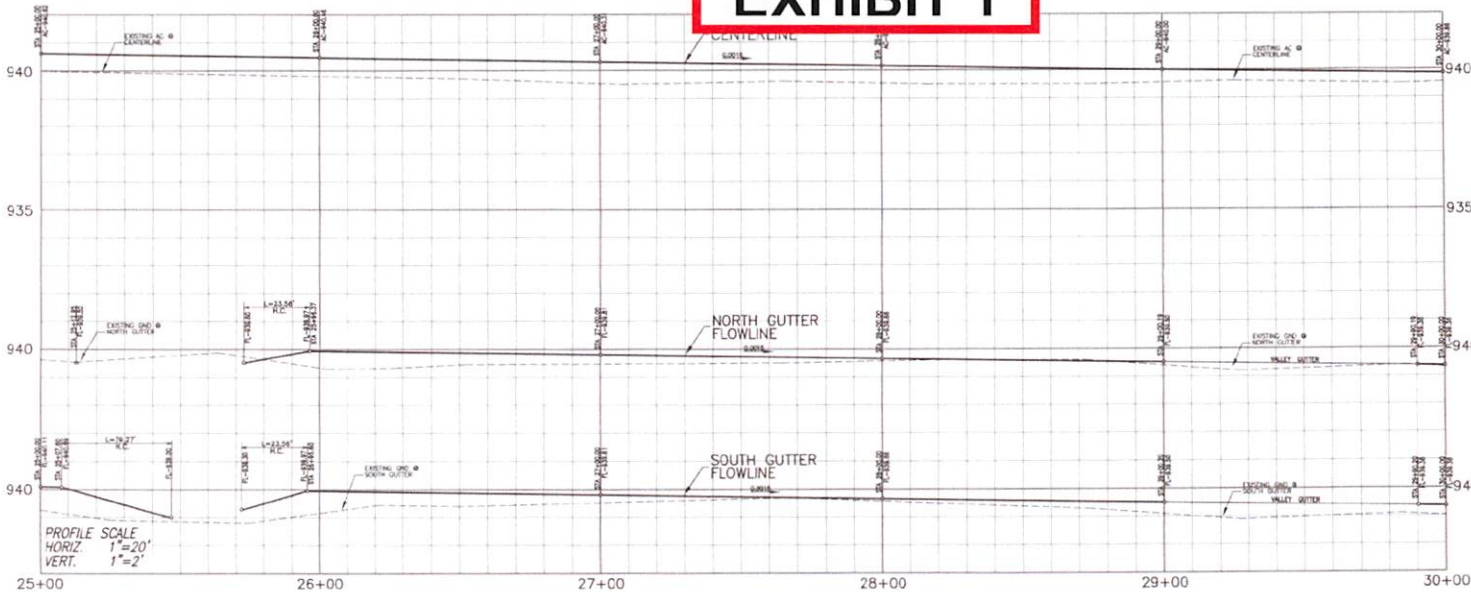

- CONSTRUCTION KEYNOTES:**
- 1 NEW 4" OF AC PAVEMENT OVER 18" OF CLASS 2 BASE
 - 2 NEW 4" PCC CURB & GUTTER PER CITY OF IMPERIAL DET. NO. 400
 - 3 NEW ADA HANDICAP RAMP PER CITY OF IMPERIAL DET. NO. 409-B
 - 4 NEW ADA HANDICAP RAMP PER CITY OF IMPERIAL DET. NO. 409
 - 5 NEW 4" PCC SIDEWALK PER CITY OF IMPERIAL DET. NO. 407
 - 6 NEW PCC DRIVEWAY APPROACH PER CITY OF IMPERIAL DET. NO. 403
 - 7 NEW PCC SPANDREL PER CITY OF IMPERIAL DET. NO. 410
 - 8 NEW 6" PCC CROSS GUTTER PER DETAIL ON SHEET 11
 - 9 NEW 6" PCC BARRIER CURB PER CITY OF IMPERIAL DET. NO. 401
 - 10 SAWCUT AC AND COLD PLANE PAVEMENT EDGE PER DETAIL ON SHEET 11 AND SPECIFICATIONS
 - 11 NEW FIRE HYDRANT ASSEMBLY PER CITY OF IMPERIAL DET. NO. 730
 - 12 NOT USED
 - 13 NEW 12" DIA. ADS 8-12 HOPE PIPE FOR STORM DRAIN PER CITY OF IMPERIAL STD. DET. NO. 515
 - 14 NEW 18" DIA. ADS 8-12 HOPE PIPE FOR STORM DRAIN PER CITY OF IMPERIAL STD. DET. NO. 515
 - 15 NEW 24" DIA. ADS 8-12 HOPE PIPE FOR STORM DRAIN PER DETAIL ON SHEET 12
 - 16 NEW S.D. CATCH BASIN PER DETAIL ON SHEET 11
 - 17 NEW UNDERSIDEWALK DRAIN PER DETAIL ON SHEET 11
 - 18 NEW 26"x26" CATCH BASIN PER DETAIL ON SHEET 11
- NOTES:**
- 1- WHEN COVER ON TOP OF PRESS IS LESS THAN 36" (INCHES) SLURRY BACKFILL SHALL BE USED.
 - 2- EXISTING MANHOLE FRAME & COVER/WATER VALVE FRAME & COVER TO BE LINED TO 0.50' BELOW PAVING. AFTER PAVING ADJUST MANHOLE FRAME/COVER TO 3/8" BELOW GRADE AND INSTALL A PCC CONCRETE RING ONE FOOT WIDE AND ONE FOOT DEEP AROUND THE MANHOLE FRAME/COVER PER CITY STD. DET. NO. 200.

APPROVED
CITY OF IMPERIAL
BY: *JLP* DATE: 10/10/21

<p>UNDERGROUND SERVICE ALERT CALL TOLL FREE 811 TWO WORKING DAYS BEFORE YOU DIG</p>	<table border="1" style="width: 100%; border-collapse: collapse;"> <thead> <tr> <th>No.</th> <th>DESCRIPTION</th> <th>BY</th> <th>DATE</th> </tr> </thead> <tbody> <tr> <td>1</td> <td>CITY OF IMPERIAL PLAN CHECK 7/10/21</td> <td>STAFF</td> <td>7/10/21</td> </tr> <tr> <td>2</td> <td>CITY OF IMPERIAL PLAN CHECK 8/04/21</td> <td>STAFF</td> <td>8/04/21</td> </tr> <tr> <td>3</td> <td>CITY OF IMPERIAL PLAN CHECK 9/10/21</td> <td>STAFF</td> <td>9/10/21</td> </tr> <tr> <td>4</td> <td>CITY OF IMPERIAL PLAN CHECK 9/17/21</td> <td>STAFF</td> <td>9/17/21</td> </tr> <tr> <td>5</td> <td>CITY OF IMPERIAL PLAN CHECK 9/22/21</td> <td>STAFF</td> <td>9/22/21</td> </tr> </tbody> </table>	No.	DESCRIPTION	BY	DATE	1	CITY OF IMPERIAL PLAN CHECK 7/10/21	STAFF	7/10/21	2	CITY OF IMPERIAL PLAN CHECK 8/04/21	STAFF	8/04/21	3	CITY OF IMPERIAL PLAN CHECK 9/10/21	STAFF	9/10/21	4	CITY OF IMPERIAL PLAN CHECK 9/17/21	STAFF	9/17/21	5	CITY OF IMPERIAL PLAN CHECK 9/22/21	STAFF	9/22/21	<p>APPROVED BY PUBLIC SERVICES DIRECTOR CITY OF IMPERIAL, CA</p> <p>BY: <i>JLP</i> DATE: 10/10/21 JACKIE LOPER</p>	<p>ENGINEER OF RECORD PLANS PREPARED UNDER THE SUPERVISION OF</p> <p>BY: <i>Carlos Durrales</i> DATE: 10/01/2021 CARLOS DURRALES</p> <p>P.C.E. NO.: 55432</p>	<p>SEAL</p>	<p>LC ENGINEERING CONSULTANTS INC. CIVIL ENGINEERING • PLANNING • SURVEYING • CONSTRUCTION MANAGEMENT SERVICES</p> <p>4465 S. Main Street El Centro, CA 92543</p> <p>DATE: OCTOBER 01, 2021 BENCHMARK: SEE SHEET NO. 1</p>	<p>CITY OF IMPERIAL</p> <p style="text-align: center;">IMPROVEMENT PLANS PLAN & PROFILE</p> <p>2ND STREET REHABILITATION AND CONSTRUCTION FROM OLD SR-66 TO 'N' STREET</p>	<p>SHEET</p> <p style="font-size: 24px;">6</p> <p style="font-size: 24px;">OF</p> <p style="font-size: 24px;">13</p> <p>SHEETS</p> <p>JOB NO. C20029-30</p>
No.	DESCRIPTION	BY	DATE																												
1	CITY OF IMPERIAL PLAN CHECK 7/10/21	STAFF	7/10/21																												
2	CITY OF IMPERIAL PLAN CHECK 8/04/21	STAFF	8/04/21																												
3	CITY OF IMPERIAL PLAN CHECK 9/10/21	STAFF	9/10/21																												
4	CITY OF IMPERIAL PLAN CHECK 9/17/21	STAFF	9/17/21																												
5	CITY OF IMPERIAL PLAN CHECK 9/22/21	STAFF	9/22/21																												

EXHIBIT 1

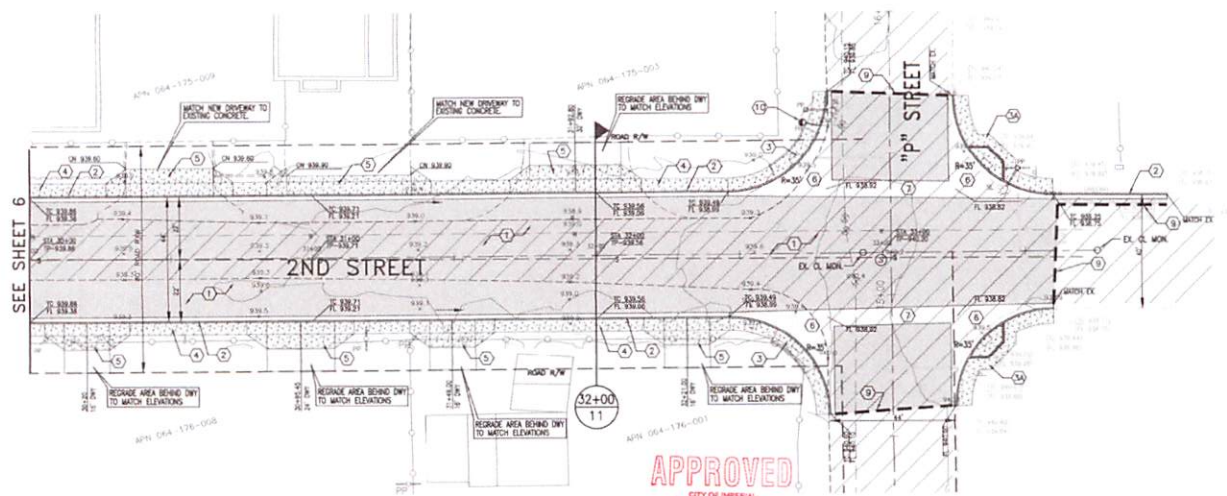
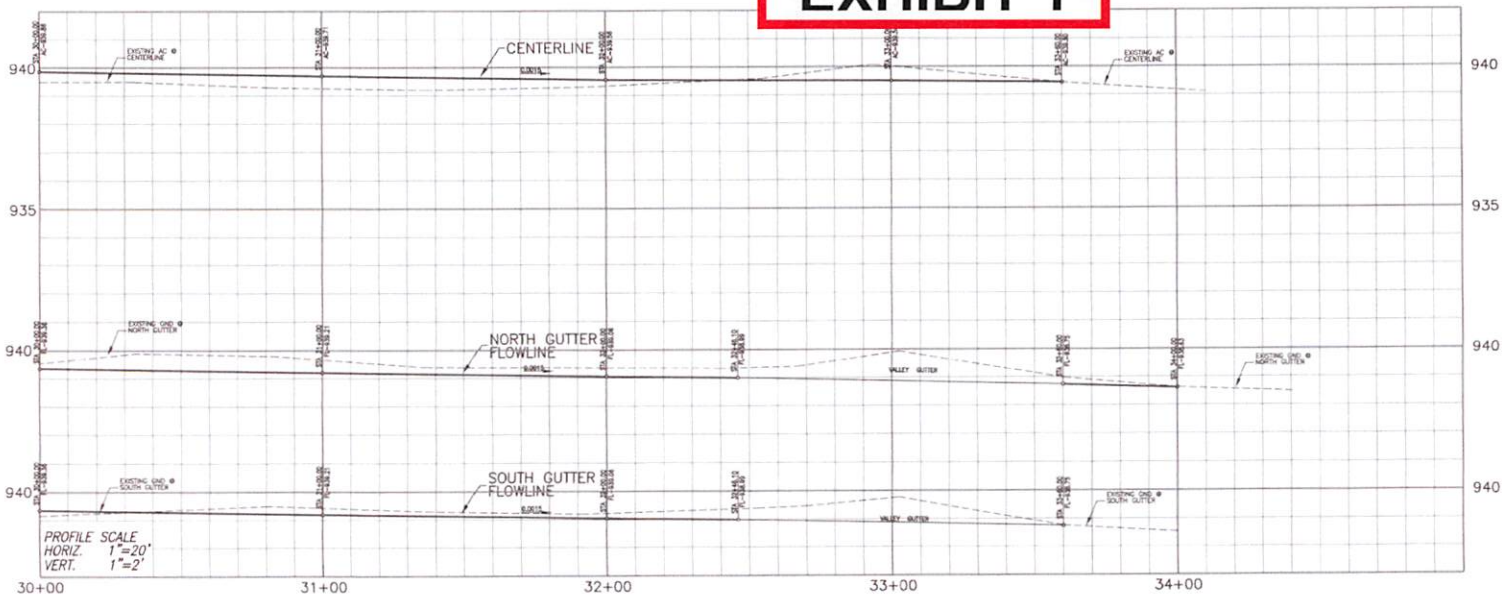

- CONSTRUCTION KEYNOTES:**
- 1 NEW 4" OF AC PAVEMENT OVER 18" OF CLASS 2 BASE
 - 2 NEW 6" PCC CURB & GUTTER PER CITY OF IMPERIAL DET. No. 400
 - 3 NEW ADA HANDICAP RAMP PER CITY OF IMPERIAL DET. No. 403-B
 - 4 NEW ADA HANDICAP RAMP PER CITY OF IMPERIAL DET. No. 403
 - 5 NEW 4" PCC SIDEWALK PER CITY OF IMPERIAL DET. No. 407
 - 6 NEW PCC DRIVEWAY APPROACH PER CITY OF IMPERIAL DET. No. 403
 - 7 NEW PCC SPANDREL PER CITY OF IMPERIAL DET. No. 410
 - 8 NEW 6" PCC CROSS GUTTER PER DETAIL ON SHEET 11
 - 9 NEW 6" PCC SAWKER CURB PER CITY OF IMPERIAL DET. No. 401
 - 10 SAWCUT AC AND COLD PLANE PAVEMENT EDGE PER DETAIL ON SHEET 11 AND DISPOSE OF MATERIAL
 - 11 NEW FIRE HYDRANT ASSEMBLY PER CITY OF IMPERIAL DET. No. 700
 - 12 NOT USED.
 - 13 NEW 18" DIA. ADS N-12 HOPE PIPE FOR STORM DRAIN PER CITY OF IMPERIAL DET. No. 517
 - 14 NEW 18" DIA. ADS N-12 HOPE PIPE FOR STORM DRAIN PER CITY OF IMPERIAL DET. No. 517
 - 15 NEW 24" DIA. ADS N-12 HOPE PIPE FOR STORM DRAIN PER DETAIL ON SHEET 12
 - 16 NEW S.D. CATCH BASIN PER DETAIL ON SHEET 11
 - 17 NEW UNDERSIDEWALK DRAIN PER DETAIL ON SHEET 11
 - 18 NEW 28"x28" CATCH BASIN PER DETAIL ON SHEET 11

- NOTES:**
- 1- WHEN COVER ON TOP OF PIPES IS LESS THAN 36" (INCHES) SLURRY BACKFILL SHALL BE USED.
 - 2- EXISTING MANHOLE FRAME & COVER/WATER VALVE FRAME & COVER TO BE LOWERED 0.50' BEFORE FRAMING. AFTER FRAMING ADJUST MANHOLE FRAME/COVER TO 3/8" BELOW GRADE AND INSTALL A PCC CONCRETE RING ONE FOOT WIDE AND ONE FOOT DEEP AROUND THE MANHOLE FRAME/COVER PER CITY STD. DETAIL No. 200.

	UNDERGROUND SERVICE ALERT CALL TOLL FREE 811 TWO WORKING DAYS BEFORE YOU DIG	<table border="1" style="width: 100%; border-collapse: collapse;"> <thead> <tr> <th>No.</th> <th>DESCRIPTION</th> <th>BY</th> <th>DATE</th> </tr> </thead> <tbody> <tr> <td>1</td> <td>CITY OF IMPERIAL PLAN CHECK 7/02/21</td> <td>STAFF</td> <td>7/06/21</td> </tr> <tr> <td>2</td> <td>CITY OF IMPERIAL PLAN CHECK 8/04/21</td> <td>STAFF</td> <td>8/09/21</td> </tr> <tr> <td>3</td> <td>CITY OF IMPERIAL PLAN CHECK 9/10/21</td> <td>STAFF</td> <td>9/15/21</td> </tr> <tr> <td>4</td> <td>CITY OF IMPERIAL PLAN CHECK 9/17/21</td> <td>STAFF</td> <td>9/21/21</td> </tr> <tr> <td>5</td> <td>CITY OF IMPERIAL PLAN CHECK 9/22/21</td> <td>STAFF</td> <td>9/28/21</td> </tr> </tbody> </table>	No.	DESCRIPTION	BY	DATE	1	CITY OF IMPERIAL PLAN CHECK 7/02/21	STAFF	7/06/21	2	CITY OF IMPERIAL PLAN CHECK 8/04/21	STAFF	8/09/21	3	CITY OF IMPERIAL PLAN CHECK 9/10/21	STAFF	9/15/21	4	CITY OF IMPERIAL PLAN CHECK 9/17/21	STAFF	9/21/21	5	CITY OF IMPERIAL PLAN CHECK 9/22/21	STAFF	9/28/21	APPROVED BY PUBLIC SERVICES DIRECTOR CITY OF IMPERIAL, CA. BY: <i>JVP</i> DATE: 10/01/21 JOSE LOPER	ENGINEER OF RECORD PLANS PREPARED UNDER THE SUPERVISION OF BY: <i>Carlos Corrales</i> DATE: 09/01/2021 CARLOS CORRALES R.C.E. NO. 55432	SEAL 	LC ENGINEERING CONSULTANTS INC. CIVIL ENGINEERING • LAND SURVEYING • CONSTRUCTION MANAGEMENT SERVICES 1015 State Street El Centro CA 92543 DATE: OCTOBER 01, 2021 BENCHMARK: SEE SHEET NO. 1	CITY OF IMPERIAL IMPROVEMENT PLANS PLAN & PROFILE 2ND STREET REHABILITATION AND CONSTRUCTION FROM OLD SR-96 TO 7TH STREET	SHEET 7 of 13 SHEETS JOB NO. C20029-00
	No.	DESCRIPTION	BY	DATE																												
1	CITY OF IMPERIAL PLAN CHECK 7/02/21	STAFF	7/06/21																													
2	CITY OF IMPERIAL PLAN CHECK 8/04/21	STAFF	8/09/21																													
3	CITY OF IMPERIAL PLAN CHECK 9/10/21	STAFF	9/15/21																													
4	CITY OF IMPERIAL PLAN CHECK 9/17/21	STAFF	9/21/21																													
5	CITY OF IMPERIAL PLAN CHECK 9/22/21	STAFF	9/28/21																													

EXHIBIT 1

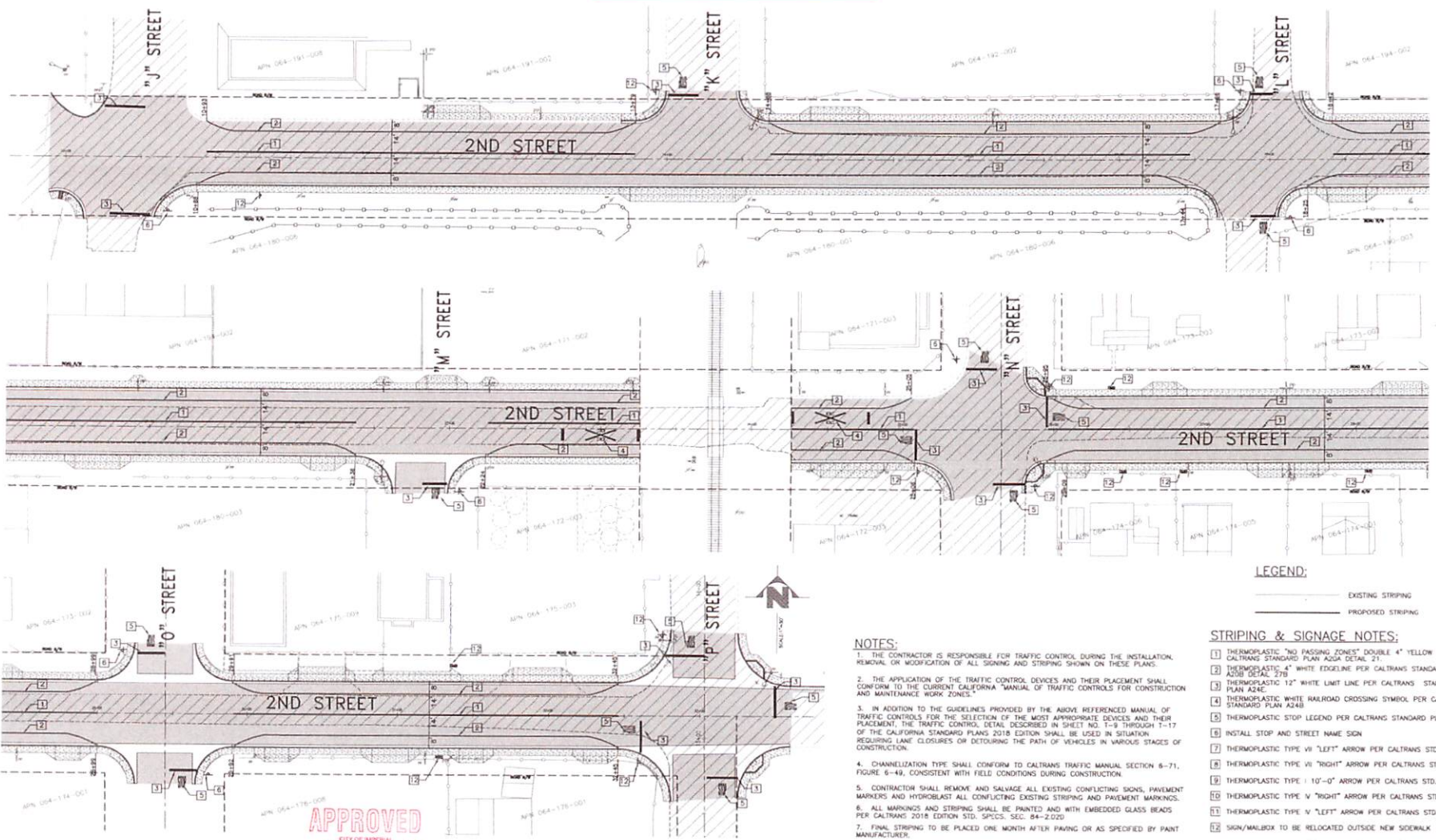

LEGEND:

- EXISTING STRIPING
- PROPOSED STRIPING

STRIPING & SIGNAGE NOTES:

- 1 THERMOPLASTIC "NO PASSING ZONES" DOUBLE 4" YELLOW LINE PER CALTRANS STANDARD PLAN A24A DETAIL 21
- 2 THERMOPLASTIC 4" WHITE EDGELINE PER CALTRANS STANDARD PLAN A24B DETAIL 27B
- 3 THERMOPLASTIC 12" WHITE LIMIT LINE PER CALTRANS STANDARD PLAN A24E
- 4 THERMOPLASTIC WHITE RAILROAD CROSSING SYMBOL PER CALTRANS STANDARD PLAN A24H
- 5 THERMOPLASTIC STOP LEGEND PER CALTRANS STANDARD PLAN A24D
- 6 INSTALL STOP AND STREET NAME SIGN
- 7 THERMOPLASTIC TYPE VI "LEFT" ARROW PER CALTRANS STD. PLAN A24A
- 8 THERMOPLASTIC TYPE VI "RIGHT" ARROW PER CALTRANS STD. PLAN A24A
- 9 THERMOPLASTIC TYPE I 10'-0" ARROW PER CALTRANS STD. PLAN A24A
- 10 THERMOPLASTIC TYPE V "RIGHT" ARROW PER CALTRANS STD. PLAN A24A
- 11 THERMOPLASTIC TYPE V "LEFT" ARROW PER CALTRANS STD. PLAN A24A
- 12 SIGN/MALIBOX TO BE RELOCATED OUTSIDE NEW SIDEWALK

NOTES:

1. THE CONTRACTOR IS RESPONSIBLE FOR TRAFFIC CONTROL DURING THE INSTALLATION, REMOVAL OR MODIFICATION OF ALL SIGNING AND STRIPING SHOWN ON THESE PLANS.
2. THE APPLICATION OF THE TRAFFIC CONTROL DEVICES AND THEIR PLACEMENT SHALL CONFORM TO THE CURRENT CALIFORNIA "MANUAL OF TRAFFIC CONTROLS FOR CONSTRUCTION AND MAINTENANCE WORK ZONES".
3. IN ADDITION TO THE GUIDELINES PROVIDED BY THE ABOVE REFERENCED MANUAL OF TRAFFIC CONTROLS FOR THE SELECTION OF THE MOST APPROPRIATE DEVICES AND THEIR PLACEMENT, THE TRAFFIC CONTROL DETAIL DESCRIBED IN SHEET NO. 1-9 THROUGH 1-17 OF THE CALIFORNIA STANDARD PLANS 2018 EDITION SHALL BE USED IN SITUATION REQUIRING LANE CLOSURES OR DETOURING THE PATH OF VEHICLES IN VARIOUS STAGES OF CONSTRUCTION.
4. CHANNELIZATION TYPE SHALL CONFORM TO CALTRANS TRAFFIC MANUAL SECTION 6-71, FIGURE 6-49, CONSISTENT WITH FIELD CONDITIONS DURING CONSTRUCTION.
5. CONTRACTOR SHALL REMOVE AND SALVAGE ALL EXISTING CONFLICTING SIGNS, PAVEMENT MARKERS AND HYDROBLAST ALL CONFLICTING EXISTING STRIPING AND PAVEMENT MARKINGS.
6. ALL MARKINGS AND STRIPING SHALL BE PAINTED AND WITH EMBEDDED GLASS BEADS PER CALTRANS 2018 EDITION STD. SPCCS, SEC. 84-2.02D
7. FINAL STRIPING TO BE PLACED ONE MONTH AFTER PAVING OR AS SPECIFIED BY PAINT MANUFACTURER.

APPROVED

CITY OF IMPERIAL

BY: *JLP* DATE: 10/01/21

<p>UNDERGROUND SERVICE ALERT CALL TOLL FREE 811 TWO WORKING DAYS BEFORE YOU DIG</p>	<table border="1" style="width: 100%; border-collapse: collapse;"> <thead> <tr> <th>No.</th> <th>DESCRIPTION</th> <th>BY</th> <th>DATE</th> </tr> </thead> <tbody> <tr> <td>1</td> <td>CITY OF IMPERIAL PLAN CHECK 7/02/21</td> <td>STAFF</td> <td>7/02/21</td> </tr> <tr> <td>2</td> <td>CITY OF IMPERIAL PLAN CHECK 8/04/21</td> <td>STAFF</td> <td>8/04/21</td> </tr> <tr> <td>3</td> <td>CITY OF IMPERIAL PLAN CHECK 9/10/21</td> <td>STAFF</td> <td>9/10/21</td> </tr> <tr> <td>4</td> <td>CITY OF IMPERIAL PLAN CHECK 9/17/21</td> <td>STAFF</td> <td>9/17/21</td> </tr> <tr> <td>5</td> <td>CITY OF IMPERIAL PLAN CHECK 9/22/21</td> <td>STAFF</td> <td>9/22/21</td> </tr> </tbody> </table>	No.	DESCRIPTION	BY	DATE	1	CITY OF IMPERIAL PLAN CHECK 7/02/21	STAFF	7/02/21	2	CITY OF IMPERIAL PLAN CHECK 8/04/21	STAFF	8/04/21	3	CITY OF IMPERIAL PLAN CHECK 9/10/21	STAFF	9/10/21	4	CITY OF IMPERIAL PLAN CHECK 9/17/21	STAFF	9/17/21	5	CITY OF IMPERIAL PLAN CHECK 9/22/21	STAFF	9/22/21	<p>APPROVED BY PUBLIC SERVICES DIRECTOR</p> <p>CITY OF IMPERIAL, CA</p> <p>BY: <i>Jack Lopez</i> DATE: 10-4-21</p> <p>JACKIE LOPEZ</p>	<p>ENGINEER OF RECORD</p> <p>PLANS PREPARED UNDER THE SUPERVISION OF</p> <p>BY: <i>Carlos Corrales</i> DATE: 10/01/2021</p> <p>CARLOS CORRALES</p> <p>R.C.E. NO.: 55432</p>	<p>SEAL</p>	<p>L.C. ENGINEERING CONSULTANTS INC.</p> <p>CIVIL ENGINEERING • PLANNING • SURVEYING • CONSTRUCTION MANAGEMENT SERVICES</p> <p>10015 State Street El Centro CA 92543</p> <p>www.lcei.com tel: 760.783.1100 info@lcei.com 604 Main Street, Suite 100 El Centro, CA 92543</p> <p>DATE: OCTOBER 01, 2021 BENCHMARK: SEE SHEET NO. 1</p>	<p>CITY OF IMPERIAL</p> <p>IMPROVEMENT PLANS STRIPING & SIGNAGE PLAN 2ND STREET REHABILITATION AND CONSTRUCTION FROM OLD SR-96 TO "P" STREET</p>	<p>SHEET</p> <p>8 OF 13 SHEETS</p> <p>JOB NO. C20029-00</p>
No.	DESCRIPTION	BY	DATE																												
1	CITY OF IMPERIAL PLAN CHECK 7/02/21	STAFF	7/02/21																												
2	CITY OF IMPERIAL PLAN CHECK 8/04/21	STAFF	8/04/21																												
3	CITY OF IMPERIAL PLAN CHECK 9/10/21	STAFF	9/10/21																												
4	CITY OF IMPERIAL PLAN CHECK 9/17/21	STAFF	9/17/21																												
5	CITY OF IMPERIAL PLAN CHECK 9/22/21	STAFF	9/22/21																												

L:\Projects\2020\202009\202009-00_001_00_Imperial_2nd_Street_001\Engineering\Drawings\202009-00_001_00_Imperial_2nd_Street_001.dwg 10/01/2021 11:15

EXHIBIT 1

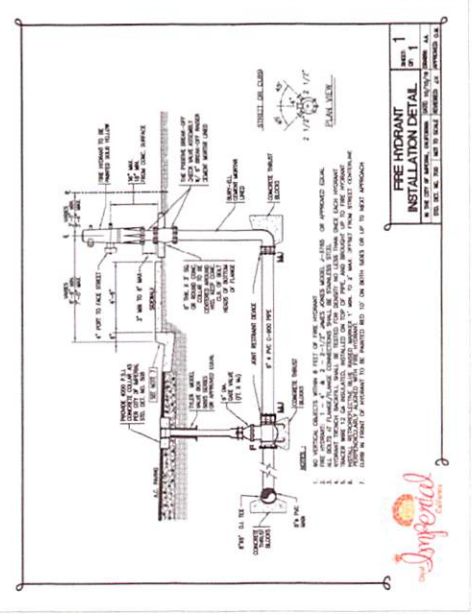

FIRE HYDRANT INSTALLATION DETAIL
 SHEET 1 OF 1
 IN THE CITY OF IMPERIAL, CALIFORNIA, DATE 10/27/21, DRAWN BY J.L., CHECKED BY J.L., APPROVED BY J.L.

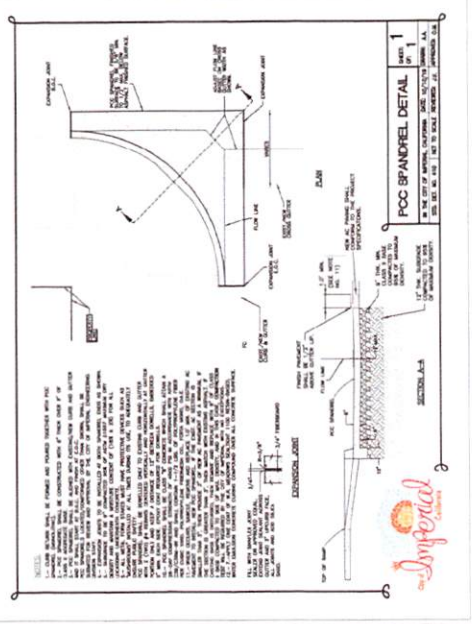

PCC SPANDELR DETAIL
 SHEET 1 OF 1
 IN THE CITY OF IMPERIAL, CALIFORNIA, DATE 10/27/21, DRAWN BY J.L., CHECKED BY J.L., APPROVED BY J.L.

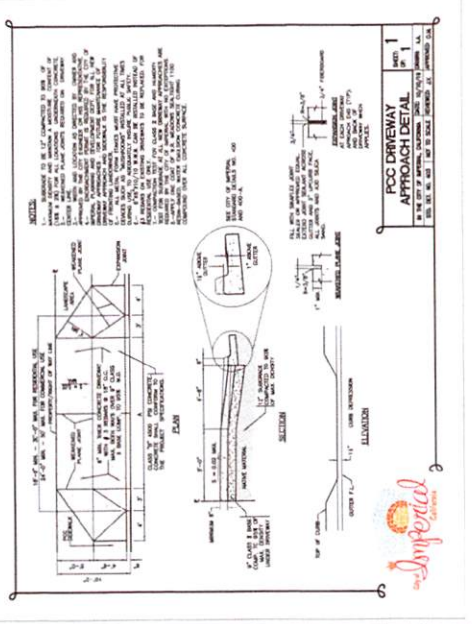

PCC DRIVEWAY APPROACH DETAIL
 SHEET 1 OF 1
 IN THE CITY OF IMPERIAL, CALIFORNIA, DATE 10/27/21, DRAWN BY J.L., CHECKED BY J.L., APPROVED BY J.L.

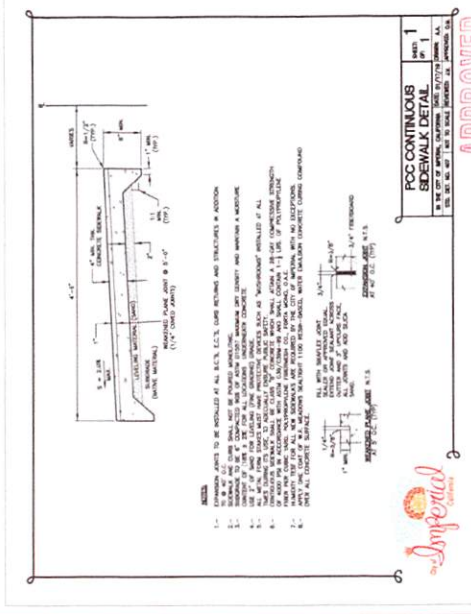

PCC CONTINUOUS SIDEWALK DETAIL
 SHEET 1 OF 1
 IN THE CITY OF IMPERIAL, CALIFORNIA, DATE 10/27/21, DRAWN BY J.L., CHECKED BY J.L., APPROVED BY J.L.

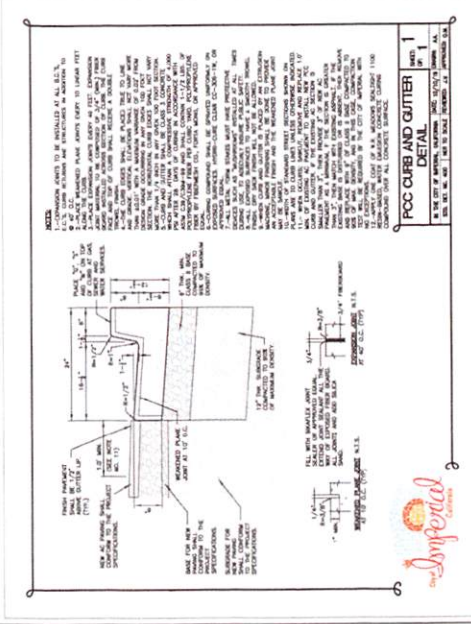

PCC CURB AND GUTTER DETAIL
 SHEET 1 OF 1
 IN THE CITY OF IMPERIAL, CALIFORNIA, DATE 10/27/21, DRAWN BY J.L., CHECKED BY J.L., APPROVED BY J.L.

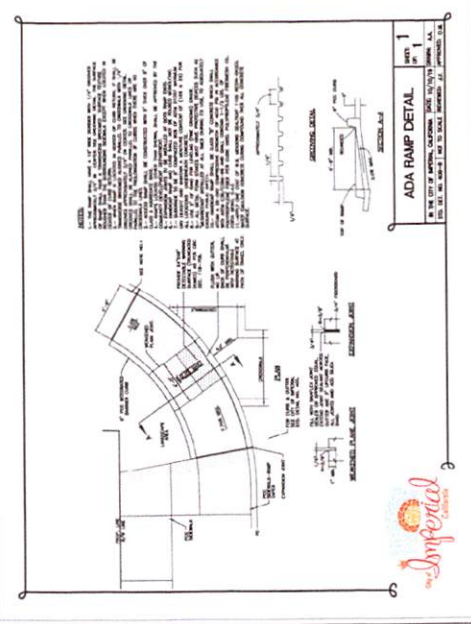

ADA RAMP DETAIL
 SHEET 1 OF 1
 IN THE CITY OF IMPERIAL, CALIFORNIA, DATE 10/27/21, DRAWN BY J.L., CHECKED BY J.L., APPROVED BY J.L.

UNDERGROUND SERVICE ALERT CALL TOLL FREE 811 TWO WORKING DAYS BEFORE YOU DIG.	NO. DESCRIPTION 1. DATE: 7/27/21 2. CITY OF IMPERIAL, PLANS CHECK 7/27/21 3. CITY OF IMPERIAL, PLANS CHECK 8/10/21 4. CITY OF IMPERIAL, PLANS CHECK 8/10/21 5. CITY OF IMPERIAL, PLANS CHECK 9/22/21	APPROVED BY PUBLIC SERVICES DIRECTOR CITY OF IMPERIAL, CA DATE: 10/27/21 JACQUE LOPER	SEAL ENGINEER OF RECORD PAGES PREPARED UNDER THE SUPERVISION OF BY: CARLOS CORONALES DATE: 10/27/21 R.C.E. NO.: 25432	CITY OF IMPERIAL IMPROVEMENT PLANS DETAILS 2ND STREET REHABILITATION AND CONSTRUCTION FROM OLD DRIVE TO 7TH STREET	SHEET 10 OF 13 SHEETS JOB NO. C200028-00
	APPROVED CITY OF IMPERIAL DATE: 10/27/21		IC ENGINEERING CONSULTANTS, INC. 4455 South Street El Centro, CA 92521	DATE: OCTOBER 01, 2021 BENCHMARKS: SEE SHEET NO. 1	CITY OF IMPERIAL IMPROVEMENT PLANS DETAILS 2ND STREET REHABILITATION AND CONSTRUCTION FROM OLD DRIVE TO 7TH STREET



IC ENGINEERING CONSULTANTS, INC.
 4455 South Street
 El Centro, CA 92521
 DATE: OCTOBER 01, 2021
 BENCHMARKS: SEE SHEET NO. 1

CITY OF IMPERIAL
 IMPROVEMENT PLANS
 DETAILS
 2ND STREET REHABILITATION AND CONSTRUCTION
 FROM OLD DRIVE TO 7TH STREET
 SHEET 10 OF 13 SHEETS
 JOB NO. C200028-00

EXHIBIT 1

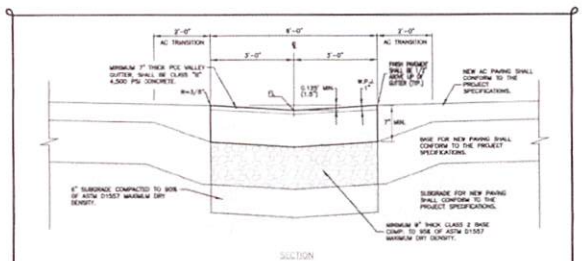

1. EXISTING JOINTS TO BE REPAIRED IN 4\"/>
- 2. REPAIRED PLANE JOINTS TO BE PROVIDED IN 12\"/>
- 3. SURFACE TO BE 4\"/>
- 4. ALL NEW PLANE JOINTS MUST HAVE PROTECTIVE DEVICES SUCH AS "WEDGEMATS" INSTALLED AT ALL TIMES DURING ITS USE. IT IS ESSENTIAL TO ENSURE PUBLIC SAFETY.
- 5. WALKWAY SHALL BE CLASS "B" CONCRETE WHICH SHALL ATTAIN A 28-DAY COMPRESSIVE STRENGTH OF 4500 PSI IN ACCORDANCE WITH ASTM C150/159 AND SHALL CONTAIN 1-1/2% U.S. POLYPROPYLENE FIBER FOR CURING AND POLYPROPYLENE FIBER (FIBER) PER CITY OF IMPERIAL SPECIFICATIONS.
- 6. APPLY THE TOP OF W.R. MEMBRANE SLIGHTLY 1/8\"/>
- 7. COMPRESSION TEST FOR CLASS 2 BASE AND TENSILE TEST FOR SURFACE ARE REQUIRED BY THE CITY OF IMPERIAL.
- 8. FOR CURET IMPROVEMENT ONLY.

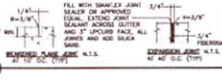

PCC CROSS CUTTER DETAIL SHEET OF 1
 IN THE CITY OF IMPERIAL, CALIFORNIA, DATE 10/16/21 DRAWN: J.A.A.
 NOT TO SCALE UNLESS NOTED BY APPROVED P.E.

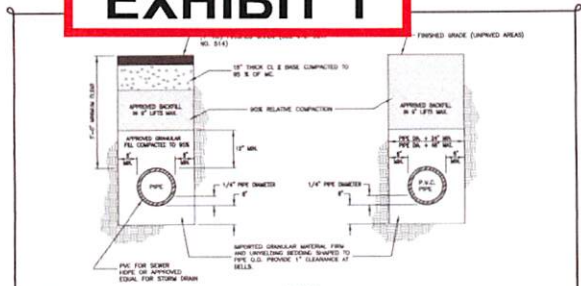

- NOTES:**
1. FOR TRENCH REQUIREMENTS ON IMPROVED STREETS SEE CITY OF IMPERIAL STANDARD DETAIL NO. 514.
 2. PIPE BEDDING AND APPROVED BRACKET MATERIAL SHALL BE AS DETERMINED BY THE ENGINEER AND THE PUBLIC SERVICES DEPARTMENT AND IS SUBJECT TO MODIFICATION AND APPROVAL BY THE COMMUNITY DEVELOPMENT DEPARTMENT.
 3. MAKE AN APPROVED RECORD OF PAVING (R.O.P.) IN THE BASE OF APPROVAL MATERIAL, A MINIMUM OVERLAP OF 1 FOOT SHALL BE MADE UP ALTERNATELY FULL TRENCH BRACKET RESTORATION USING EITHER A 2\"/>



UTILITY TRENCH DETAIL SHEET OF 1
 IN THE CITY OF IMPERIAL, CALIFORNIA, DATE 10/16/21 DRAWN: J.A.A.
 NOT TO SCALE UNLESS NOTED BY APPROVED P.E.

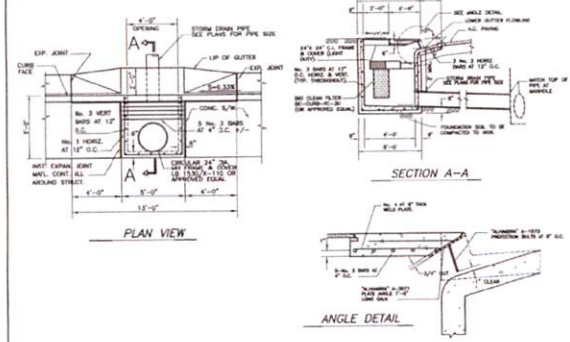

STORM DRAIN CATCH BASIN WITH BIO CLEAN FILTER
 NOT TO SCALE UNLESS NOTED

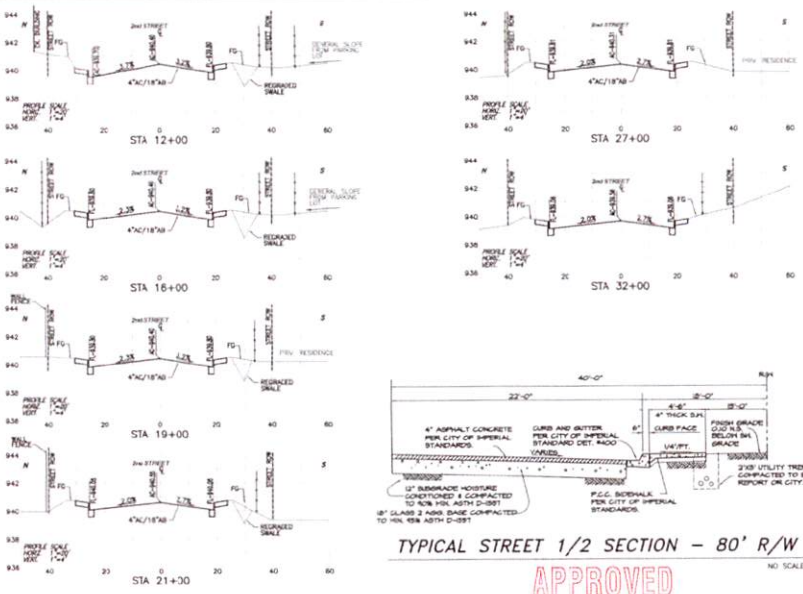

TYPICAL STREET 1/2 SECTION - 80' R/W
 CROSS-SECTIONS
 APPROVED
 CITY OF IMPERIAL
 BY: J.A.A. DATE: 10/16/21
 SCALE: 1\"/>

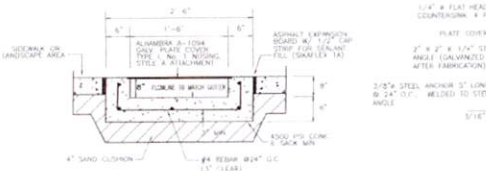

UNDER-SIDEWALK DRAIN
 NOT TO SCALE

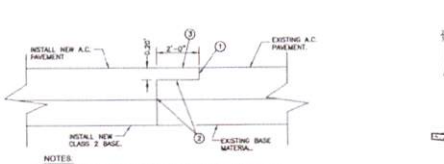

- NOTES:**
1. COLD PLANE 2 FOOT WIDE X 6\"/>
 - 2. TACK COAT THE SAWCUT A.C. PAVEMENT EDGE AND COLD PLANE AREA WITH A 5% GRADE 20-30 EMULSION ASPHALT AT AN APPROXIMATE RATE OF 0.5 TO 1.0 GALLON PER SQUARE YARD. THE 50-70 EMULSION ASPHALT SHALL BE UNIFORMITY APPLIED PRECEDING THE PLACEMENT OF THE NEW ASPHALT CONCRETE. THE SURFACE SHALL BE FREE OF WATER, FOREIGN MATERIAL, OR DUST WHICH THE TACK COAT IS APPLIED.
 - 3. OVERLAY HEADER AREA TO MATCH NEW AND EXISTING A.C. SURFACES.
 - 4. WHERE PAVEMENT IS INSTALLED ON A PROJECT ON MORE THAN ONE DAY, A HEADER (AS HEREIN DESCRIBED) MUST BE PROVIDED AT THE CONSTRUCTION JOINT.

COLD PLANE DETAIL

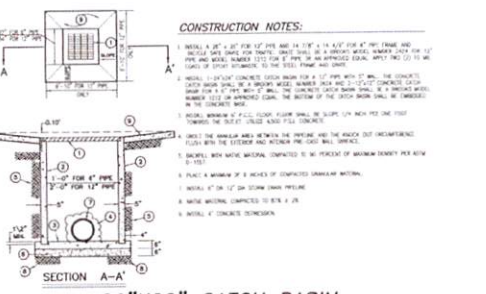

**26\"/>
 NOT TO SCALE**

- CONSTRUCTION NOTES:**
1. INSTALL A 1\"/>
 - 2. INSTALL 1\"/>
 - 3. INSTALL 1\"/>
 - 4. INSTALL A MINIMUM OF 6 INCHES OF COMPACTED GRANULAR MATERIAL.
 - 5. INSTALL 4\"/>
 - 6. MAKE RECORDS COMPACTED TO 95% P.C.
 - 7. INSTALL 4\"/>

	UNDERGROUND SERVICE ALERT CALL: TOLL FREE 811 TWO WORKING DAYS BEFORE YOU DIG	<table border="1" style="width: 100%; border-collapse: collapse;"> <thead> <tr> <th>No.</th> <th>DESCRIPTION</th> <th>BY</th> <th>DATE</th> </tr> </thead> <tbody> <tr> <td>1</td> <td>CITY OF IMPERIAL PLAN CHECK 7/22/21</td> <td>J.A.A.</td> <td>7/22/21</td> </tr> <tr> <td>2</td> <td>CITY OF IMPERIAL PLAN CHECK 8/24/21</td> <td>J.A.A.</td> <td>8/24/21</td> </tr> <tr> <td>3</td> <td>CITY OF IMPERIAL PLAN CHECK 9/10/21</td> <td>J.A.A.</td> <td>9/10/21</td> </tr> <tr> <td>4</td> <td>CITY OF IMPERIAL PLAN CHECK 9/17/21</td> <td>J.A.A.</td> <td>9/17/21</td> </tr> <tr> <td>5</td> <td>CITY OF IMPERIAL PLAN CHECK 9/22/21</td> <td>J.A.A.</td> <td>9/22/21</td> </tr> </tbody> </table>	No.	DESCRIPTION	BY	DATE	1	CITY OF IMPERIAL PLAN CHECK 7/22/21	J.A.A.	7/22/21	2	CITY OF IMPERIAL PLAN CHECK 8/24/21	J.A.A.	8/24/21	3	CITY OF IMPERIAL PLAN CHECK 9/10/21	J.A.A.	9/10/21	4	CITY OF IMPERIAL PLAN CHECK 9/17/21	J.A.A.	9/17/21	5	CITY OF IMPERIAL PLAN CHECK 9/22/21	J.A.A.	9/22/21	APPROVED BY PUBLIC SERVICES DIRECTOR CITY OF IMPERIAL, CA. DATE: 10/16/21 J.A.A.	ENGINEER OF RECORD PLANS PREPARED UNDER THE SUPERVISION OF BY: CARLOS CORNALES DATE: 10/16/21 R.C.E. NO.: 55432	SEAL 	LC ENGINEERING CONSULTANTS INC. CIVIL ENGINEERING CONSULTANTS AND CONSTRUCTION MANAGEMENT SERVICES 3465 N. State Street E. Contra Costa 94543 DATE: OCTOBER 01, 2021 BENCHMARK: SEE SHEET NO. 1	CITY OF IMPERIAL IMPROVEMENT PLANS DETAIL SIX SECTIONS 2ND STREET REHABILITATION AND CONSTRUCTION FROM OLD SR-86 TO 9TH STREET SHEET 11 OF 13 SHEETS JOB NO. C20029-00
	No.	DESCRIPTION	BY	DATE																											
1	CITY OF IMPERIAL PLAN CHECK 7/22/21	J.A.A.	7/22/21																												
2	CITY OF IMPERIAL PLAN CHECK 8/24/21	J.A.A.	8/24/21																												
3	CITY OF IMPERIAL PLAN CHECK 9/10/21	J.A.A.	9/10/21																												
4	CITY OF IMPERIAL PLAN CHECK 9/17/21	J.A.A.	9/17/21																												
5	CITY OF IMPERIAL PLAN CHECK 9/22/21	J.A.A.	9/22/21																												

EXHIBIT 1

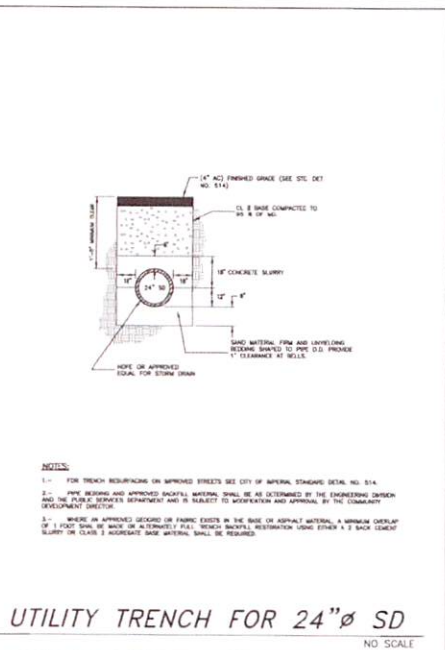
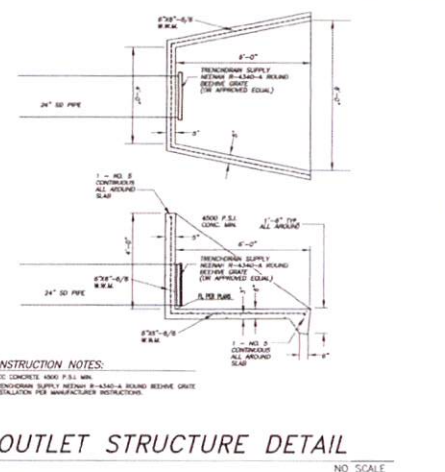
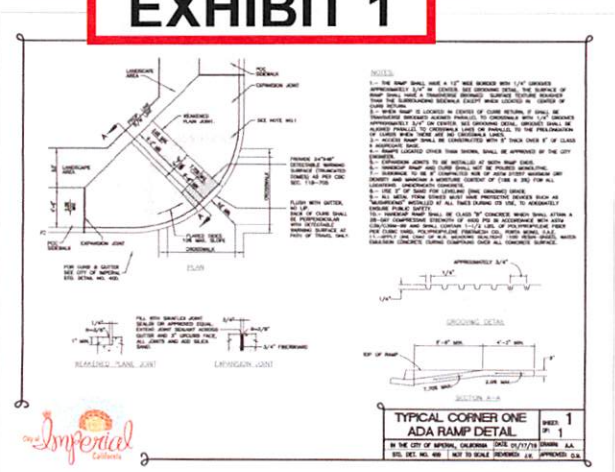
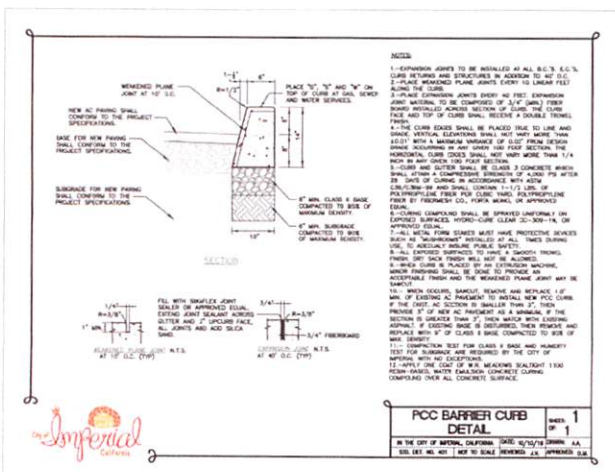

APPROVED
 CITY OF IMPERIAL
 BY: *J. Lopez* DATE: 9/16/21

 CALL TOLL FREE 811 TWO WORKING DAYS BEFORE YOU DIG	No. 1 DESCRIPTION CITY OF IMPERIAL PLAN CHECK 7/02/21	BY STAFF	DATE 7/09/21	APPROVED BY PUBLIC SERVICES DIRECTOR CITY OF IMPERIAL, CA BY: <i>J. Lopez</i> DATE: 9/16/21	ENGINEER OF RECORD PLANS PREPARED UNDER THE SUPERVISION OF BY: <i>Carlos Corrales</i> DATE: 9/16/21 CARLOS CORRALES R.E.C. NO.: 55432	SEAL No. 55432 Exp. 12-31-23 State of Cal.	LC ENGINEERING CONSULTANTS INC. CIVIL ENGINEERING PLANNING ARCHITECTURE CONSTRUCTION MANAGEMENT SERVICES 6415 State Street El Centro, CA 92543 www.lceng.com Tel: 951-241-8444 DATE: OCTOBER 01, 2021 BENCHMARK: SEE SHEET NO. 1	CITY OF IMPERIAL IMPROVEMENT PLANS DETAILS 2ND STREET REHABILITATION AND CONSTRUCTION FROM OLD SR-86 TO 9TH STREET SHEET 12 OF 13 SHEETS JOB NO. C20029-00
	No. 2 CITY OF IMPERIAL PLAN CHECK 8/04/21	STAFF	8/09/21					
	No. 3 CITY OF IMPERIAL PLAN CHECK 8/17/21	STAFF	9/15/21					
	No. 4 CITY OF IMPERIAL PLAN CHECK 8/17/21	STAFF	9/21/21					
	No. 5 CITY OF IMPERIAL PLAN CHECK 9/22/21	STAFF	9/21/21					

